

# ROSWELL.

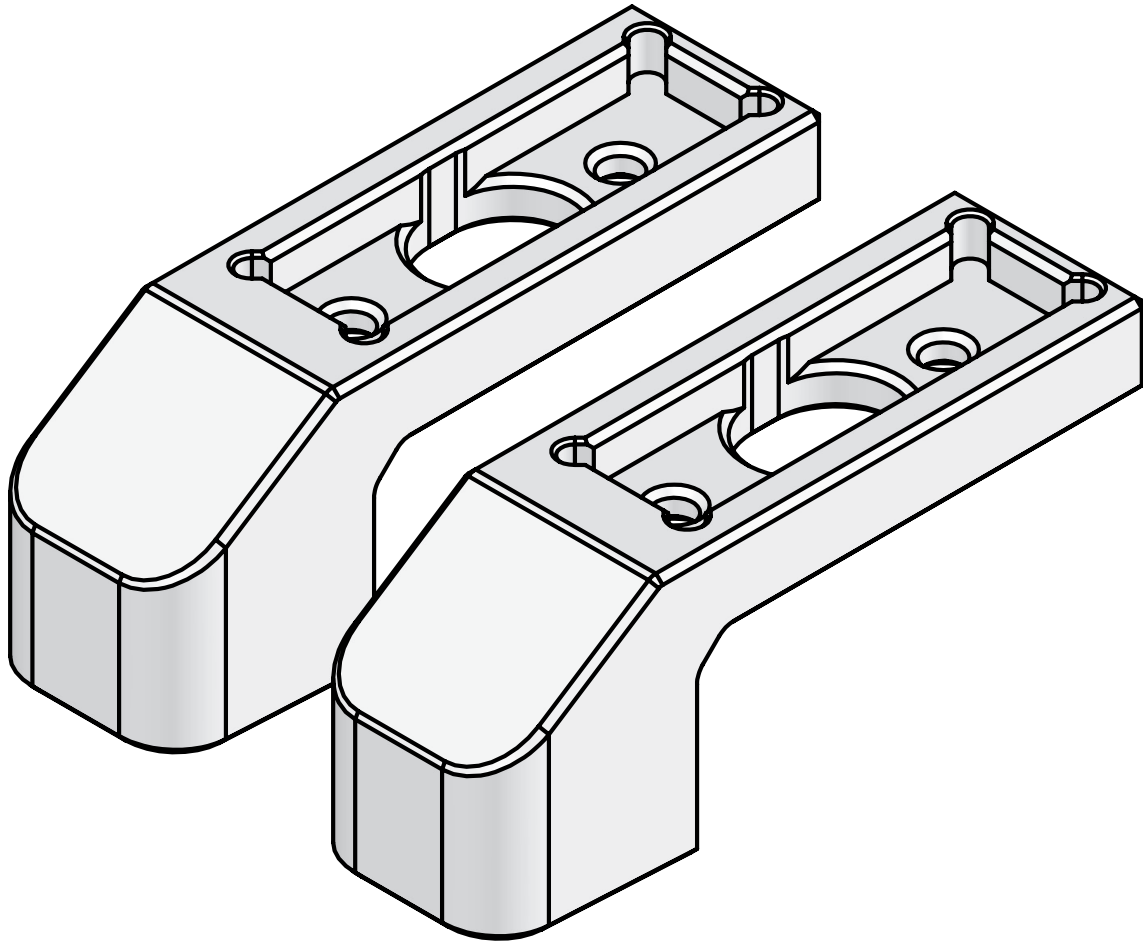

## F-SERIES TOWER SPEAKER ADAPTERS

**F-Series Tower Speaker Adapter#** C813-20144

**Information:** [info@roswellmarine.com](mailto:info@roswellmarine.com)

**Warranty:** [warranty@roswellmarine.com](mailto:warranty@roswellmarine.com)

If you have any questions please call : 1-321-638-1331

[www.roswellmarine.com](http://www.roswellmarine.com)

REV. 191118



# ROSWELL.

Welcome to the Family.

We at Roswell started a revolution in the wakeboard industry back in 1998, and have since expanded into marine audio and other branches of the marine industry. Even now, over 20 years later, we continue to push the boundaries.

We are fully committed to going past industry expectations every day to make your boating experience more enjoyable. With the input of our dealers, team riders, and boaters around the world, our goal remains to redefine the marine industry day in and day out. We will not be confined to our desks; we are out on the water testing our full line of products to ensure your days on the water are as hassle-free and enjoyable as possible.

If you have any questions about your speakers or questions regarding installation, please contact your authorized Roswell dealer. If you have further questions, please don't hesitate to contact us directly at (321)-638-1331 or by emailing [info@roswellmarine.com](mailto:info@roswellmarine.com).

---

## TABLE OF CONTENTS

Features .....	<b>03</b>
Warnings .....	<b>04</b>
Preparation .....	<b>05</b>
Wiring .....	<b>06</b>
R1 Pro Installation .....	<b>07 - 08</b>
Installing on Tower.....	<b>09 - 10</b>
Warranty.....	<b>10</b>
Tower Wiring Diagram.....	<b>11</b>

**F-Series Specific**

The adapters have been designed to mount Roswell speakers to the Supreme F-Series tower,

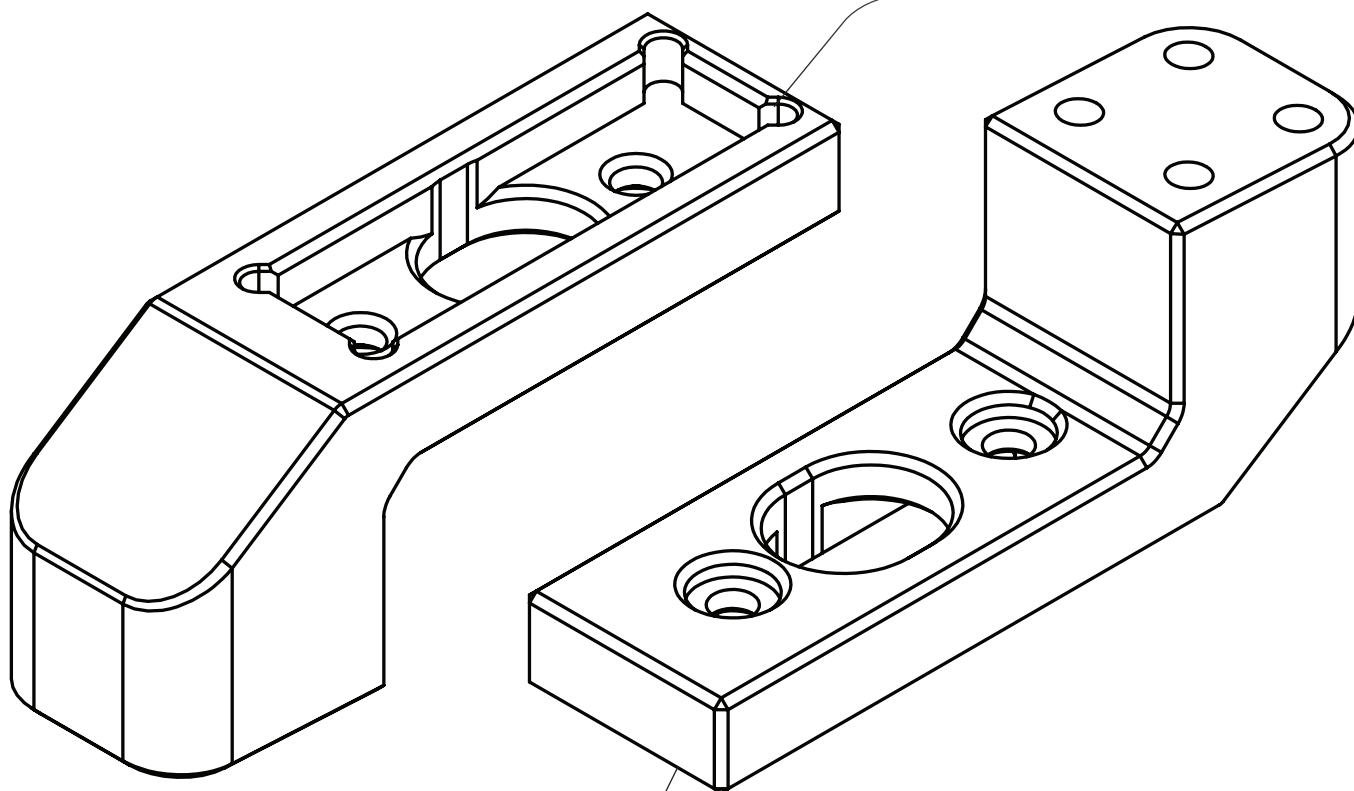
**Clean design**

The low profile design allows you to securely mount speakers to your tower without compromising the look.

The F-Series Tower Speaker Adapters provide a solid platform to hang your speakers. Machined from billet aluminum it is sure to firmly hold your speakers for years to come.

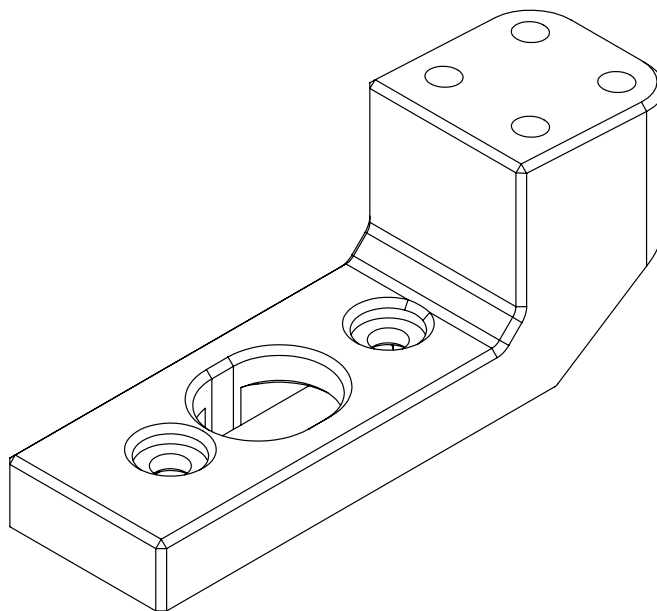

### ⚠ ATTENTION ⚠

- Bolts and screws tend to rattle loose over time due to the vibrations and shaking that your boat experiences while on the water or in transit. Always check all your speakers are securely fastened by checking speakers bolts for tightness before using your boat. If any bolts are found to be loose remove them, apply red threadlock and re-tighten the bolts.
- Never hang off of the speaker under any circumstance.
- Be mindful of the head clearance to prevent head injuries.
- Be aware of your tow rope being sure not to get it wrapped around the speaker or any other objects.

---

### Use and Care.

Before use do an inspection of your speakers, checking for loose hardware. We recommend keeping a set of Allen keys in your boat. Even with threadlock bolts can still loosen over time.

## Package Contents

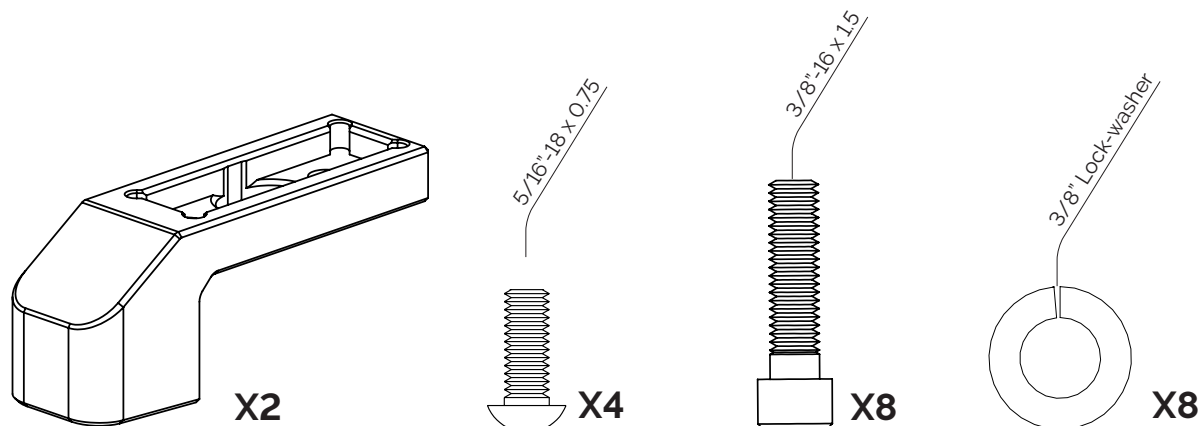

## Tools Required

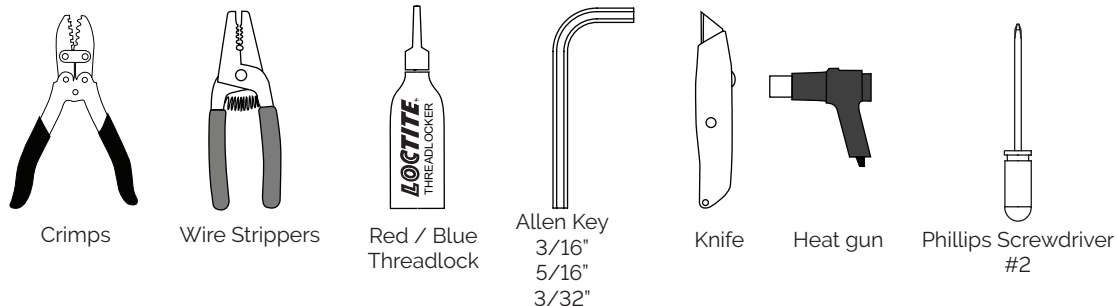

## Preparation

Before you start make sure that you have all of the required tools to install your product.

Crimp connectors not included - If installing a new speaker, please use the crimp connectors supplied with the speaker. Make sure you have enough connectors before beginning the installation.

Speaker Wiring Harness

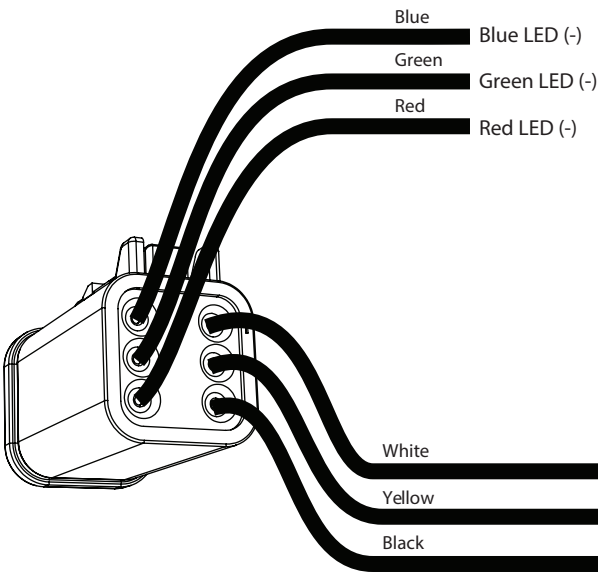

Wiring Configuration		Output
Blue	— 12V (-)	Blue
Green	— 12V (-)	Green
Red	— 12V (-)	Red
Green Red	— 12V (-)	Yellow
Blue Red	— 12V (-)	Magenta
Blue Green	— 12V (-)	Cyan
Blue Green Red	— 12V (-)	White
Blue	Blue 12V (-)	Controllable / Programmable RGB
Green	Green 12V (-)	
Red	Red 12V (-)	

Tower Wiring

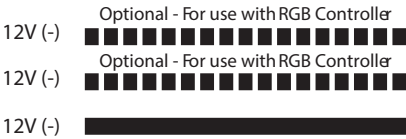

**NOTE:** R1 Pro wiring shown, please refer to your speakers' instruction manual if using a different speaker

Crimp Connector

See page 11 for the F-Series tower wiring diagram

Wiring

1

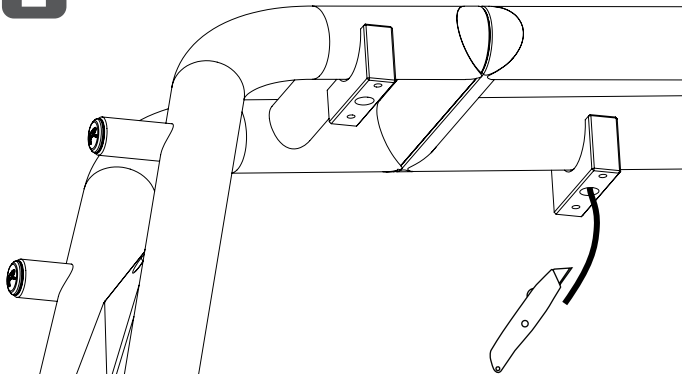

Access the wires in the tower. Be careful pulling out the wires. Next carefully cut the shrink wrap to uncover the wires. Be cautious not to cut through the wire insulation.

Strip 1/4" off of the wires and crimp the butt connectors to the corresponding wires. Once attached use a heat gun on the connectors to seal the connections.

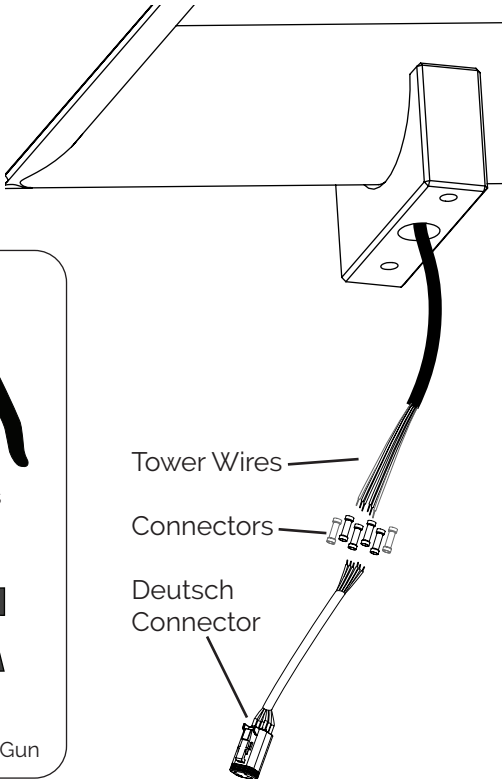
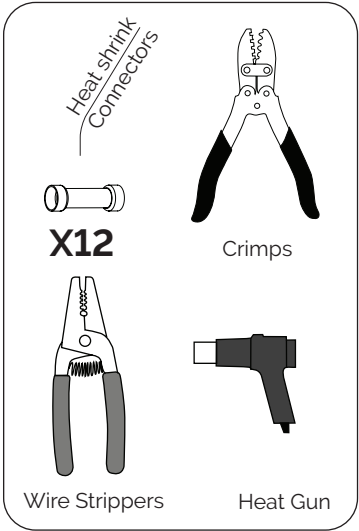

# R1 Pro Installation

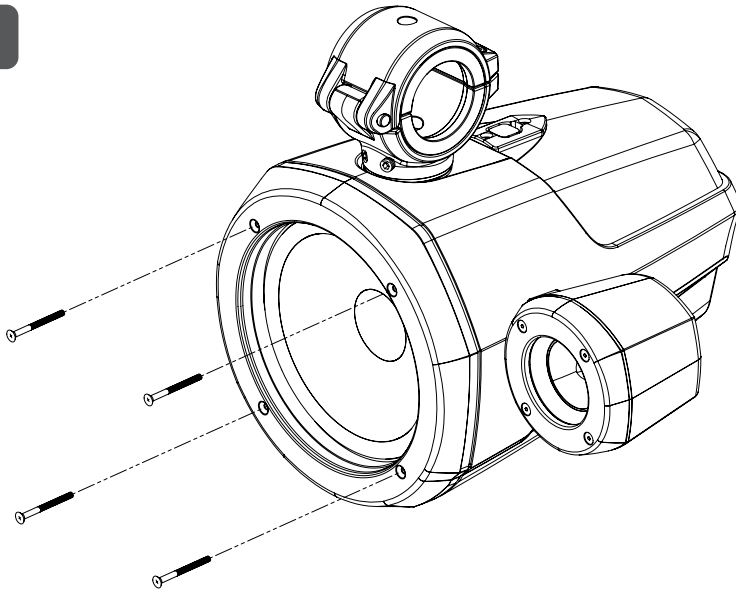
**1**

NOTE: disassemble the speaker on a clean flat surface to prevent scratches.

To detach the existing clamp, first remove the four flat head phillips bolts on the front. Next remove the three plastic pieces and carefully place to one side, then carefully remove the speaker from the case and disconnect the wires. Place a rag/dropcloth in front of the housing and lay the speaker down on it to prevent damage.

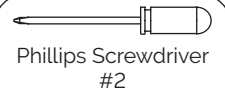

Phillips Screwdriver  
#2

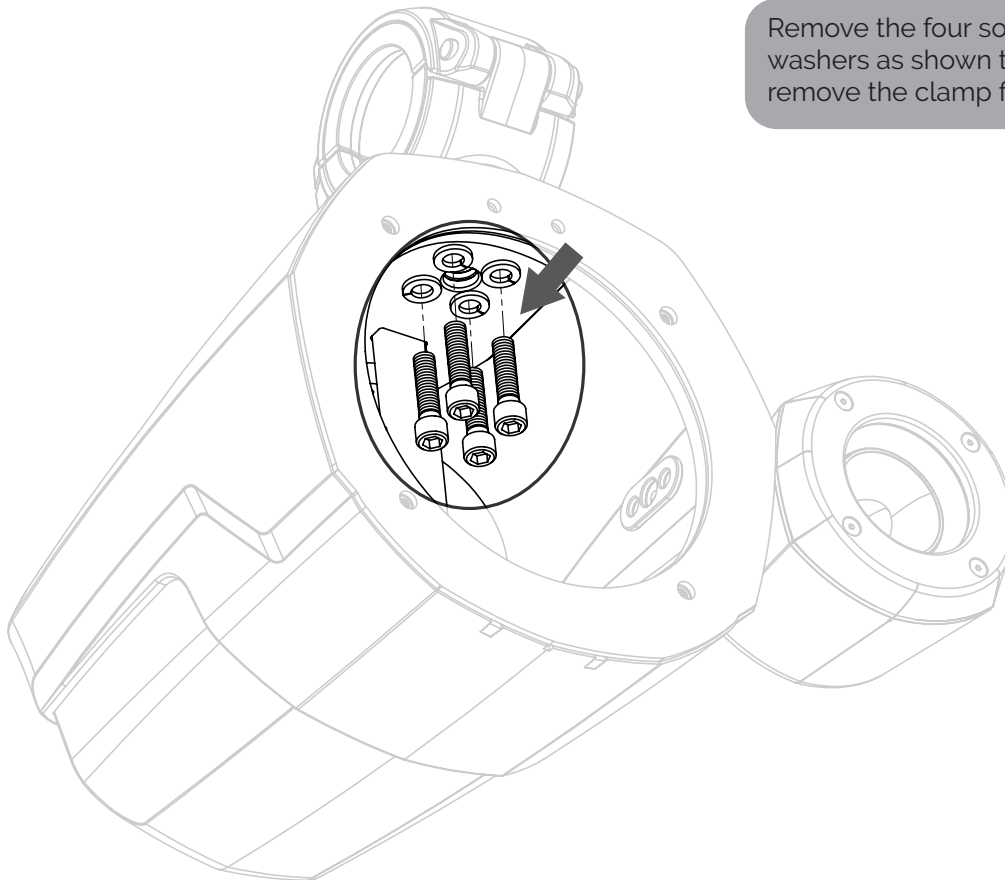
**2**

Remove the four socket cap bolts and lock washers as shown to release the clamp, carefully remove the clamp from the speaker and put aside.

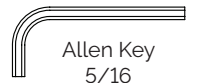

Allen Key  
5/16

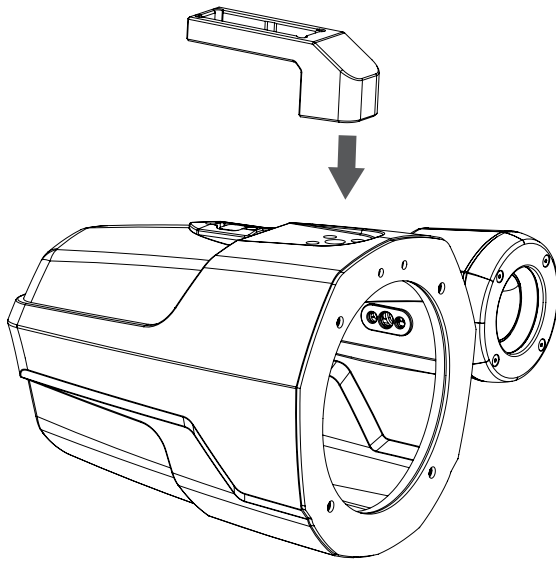
**3**

Apply red threadlocker to four of the provided 3/8" bolts and with the adapter aligned as shown, secure it to the speaker housing with a lock washer on each bolt.

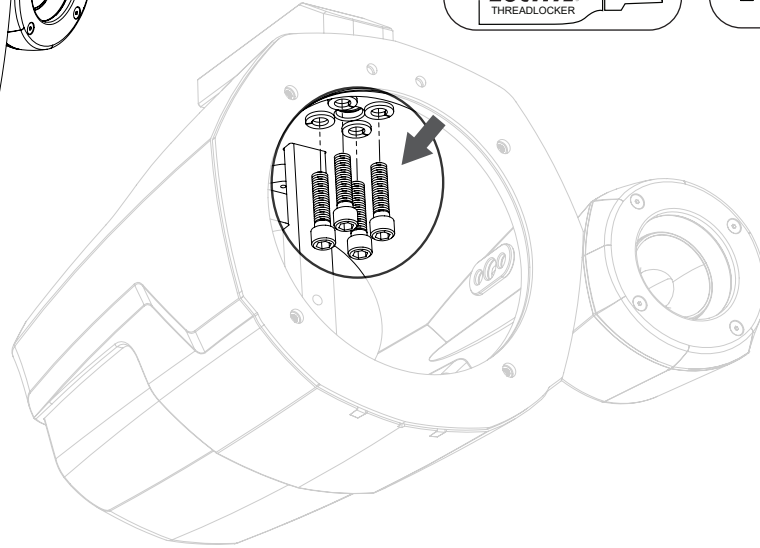
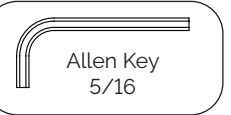
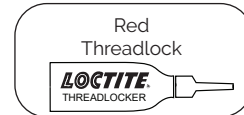
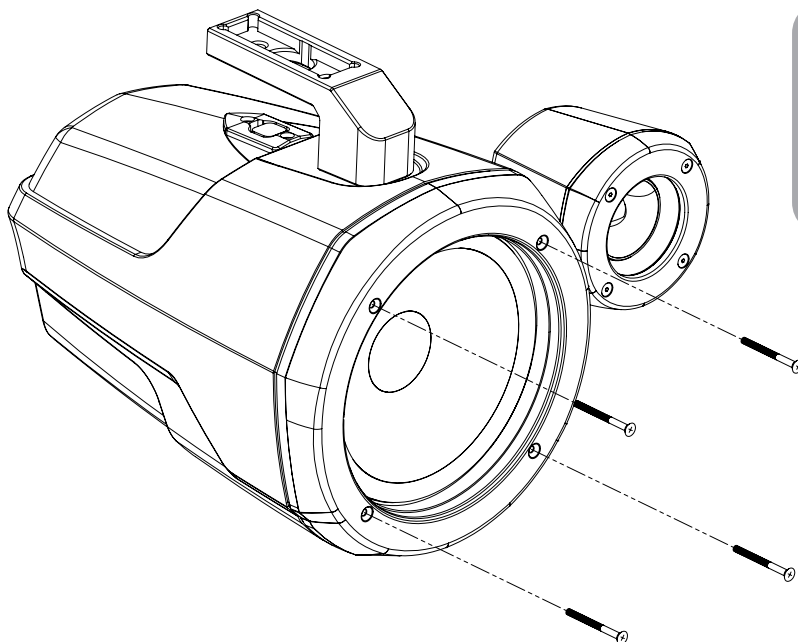
**4**

Re-connect the speaker wires and align the speaker, making sure the gasket is in place between the speaker and the housing. Then install the three plastic pieces using the original bolts with blue threadlocker, be careful not to over tighten

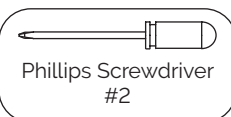
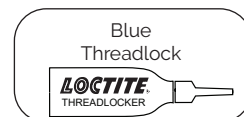

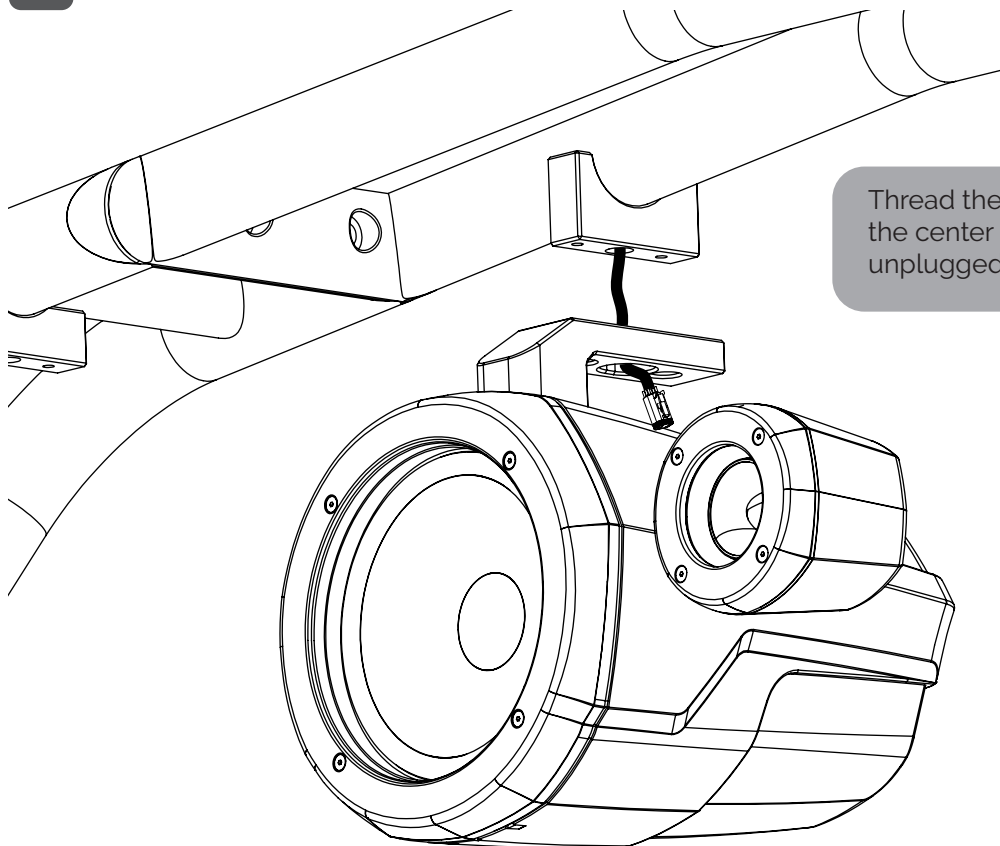

## Installing on Tower

**1**

Thread the Deutsch connector through the center hole of the adapter, and leave it unplugged to give room for tools.

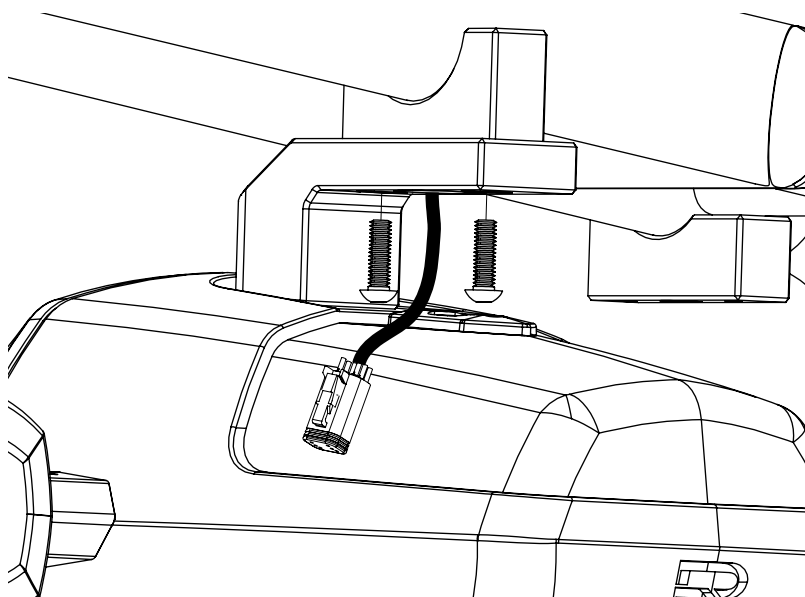
**2**

Using the 5/16" bolts with red threadlock, install the forward bolt by hand, then the rear. Tighten by hand until you have enough room for the Allen key. Then tighten fully with the Allen key.

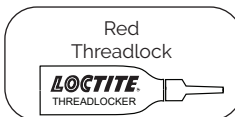

3

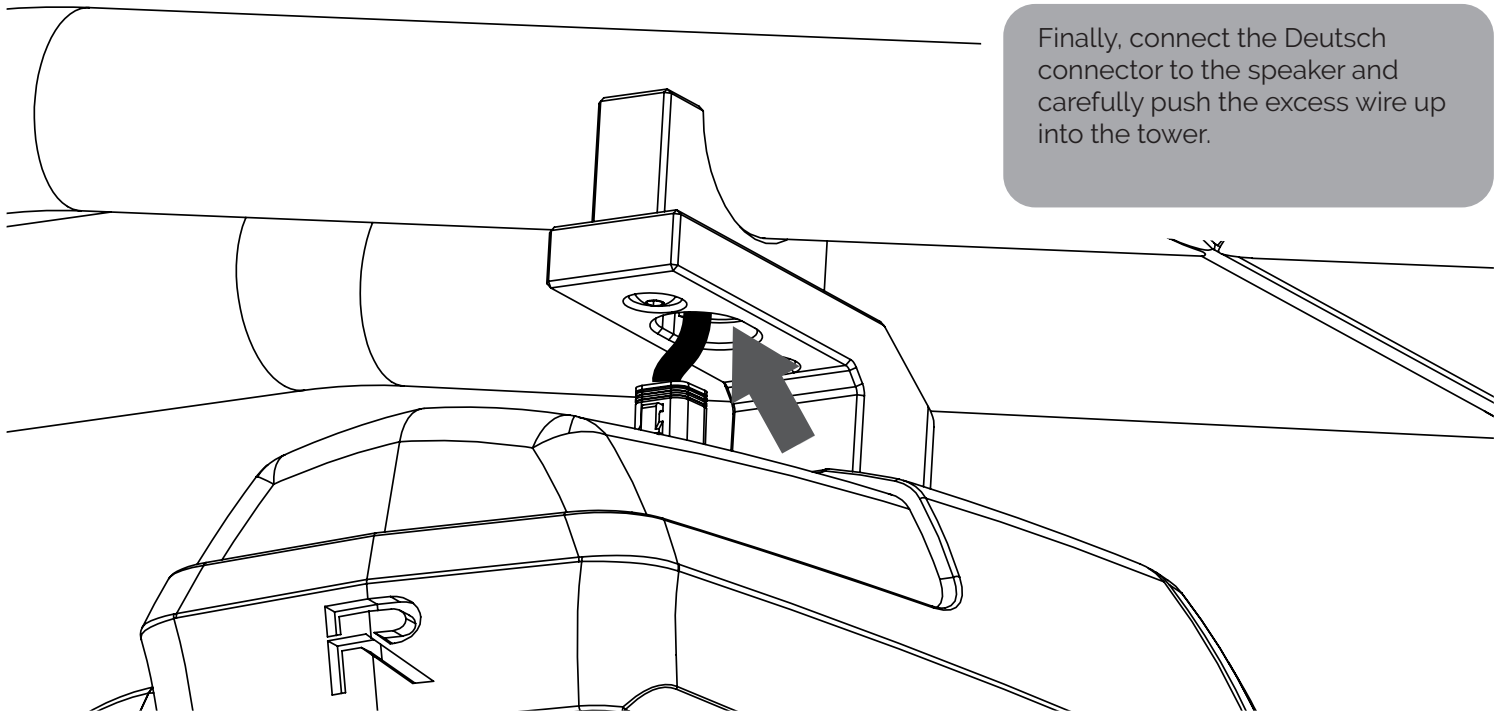

### Roswell Limited Warranty

Roswell warrants all new R1 Pro Tower Speakers against defects in material and workmanship for a period of TWO (2) YEARS from the original date of purchase. This warranty is not transferable and applies only to the original retail purchaser from an authorized Roswell retailer. Upon inspection by Roswell, should service be necessary under this warranty for any reason due to manufacturer defects, Roswell will, at our own discretion, repair or replace the defective product with new or similar conditioned product at no charge.

**THIS WARRANTY DOES NOT COVER INSTALLATION OR DAMAGE RESULTING FROM ACCIDENT, MISUSE, ABUSE, IMPROPER WIRING, COSMETIC DAMAGE DUE TO NORMAL WEAR AND TEAR, EXPOSURE TO CHEMICALS OR HARSH ENVIRONMENTS, OPERATION OUTSIDE OF THE MANUFACTURERS RECOMMENDATIONS OR SPECIFICATIONS, OR AGAINST INSTRUCTIONS IN OWNERS MANUAL. IN ADDITION, ANY PRODUCT THAT HAS BEEN OPENED, TAMPERED WITH OR MODIFIED, OR IF ANY SERIAL NUMBERS HAVE BEEN REMOVED, WILL NOT BE COVERED BY ANY PART OF THE MANUFACTURES WARRANTY.**

All warranty claims must first be made in direct contact with Roswell's warranty department. When first contact is made the warranty representative will issue an RA # to open a claim. All warranty returns should be sent to Roswell freight prepaid and must be accompanied by proof of purchase (a copy of original sales receipt). Direct returns from consumers or non-authorized retailers will be refused unless specifically authorized by Roswell with a valid return authorization number (RA#).

All warranty returns should be packed in the original packaging and must be accompanied by a copy of the original sales receipt. Product damage during shipping will not be covered under this warranty. The customer or retailer may choose to have this damage repaired at the normal "Out of Warranty" repair cost.

In no event will Roswell be liable for incidental, consequential, or other damages resulting from the use of this product. This includes but is not limited to, damage of hearing, property or person, damage based upon inconvenience or on loss of use of the product, and to the extent permitted by law, damages for personal injury.

This warranty applies to products being sold and used in the United States of America and Canada. In all other countries please contact your authorized Roswell representative.

For warranty and non-warranty repairs, please contact Roswell.

Phone: 1-321-638-1331  
Email: warranty@roswellmarine.com

Rev. 17-SEPT-2018-DW

# SUPREME

F SERIES TOWER WIRING DIAGRAM

