

ROSWELL.

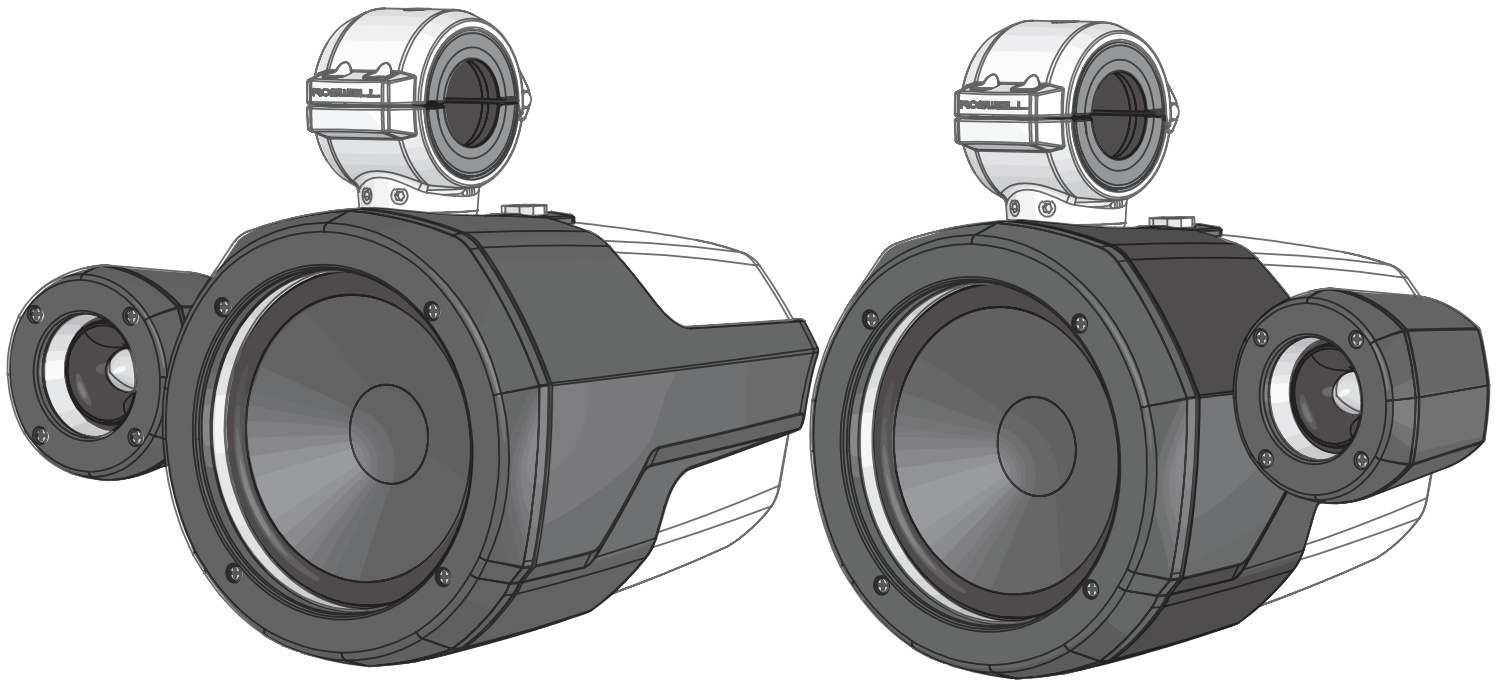

R1

PRO

R1 Pro speakers # C920-1910

Information: info@roswellmarine.com

Warranty: warranty@roswellmarine.com

If you have any questions please call : 1-321-638-1331
www.roswellmarine.com

REV. 190611



ROSWELL.

Welcome to the Family.

We at Roswell started a revolution in the wakeboard industry back in 1998, and have since expanded into marine audio and other branches of the marine industry. Even now, 20 years later, we continue to push the boundaries.

We are fully committed to going past industry expectations every day to make your boating experience more enjoyable. With the input of our dealers, team riders, and boaters around the world, our goal remains to redefine the marine industry day in and day out. We will not be confined to our desks; we are out on the water testing our full line of products to ensure your days on the water are as hassle-free and enjoyable as possible.

If you have any questions about your speakers or questions regarding installation, please contact your authorized Roswell dealer. If you have further questions, please don't hesitate to contact us directly at (321)-638-1331 or by emailing info@roswellmarine.com.

TABLE OF CONTENTS

Features	03
Warnings	04
Preparation	05
Wiring	06-07
Installation	07-09
 <u>Trouble shooting</u>	
Wiring Diagram	10

360 Swivel

The 360 Swivel allows you to mount your speaker in any orientation depending on your mounting situation.

Emissive Housing

You can now fully light your speaker with Roswell's patent pending emissive housing. With full RGB control the colors are endless

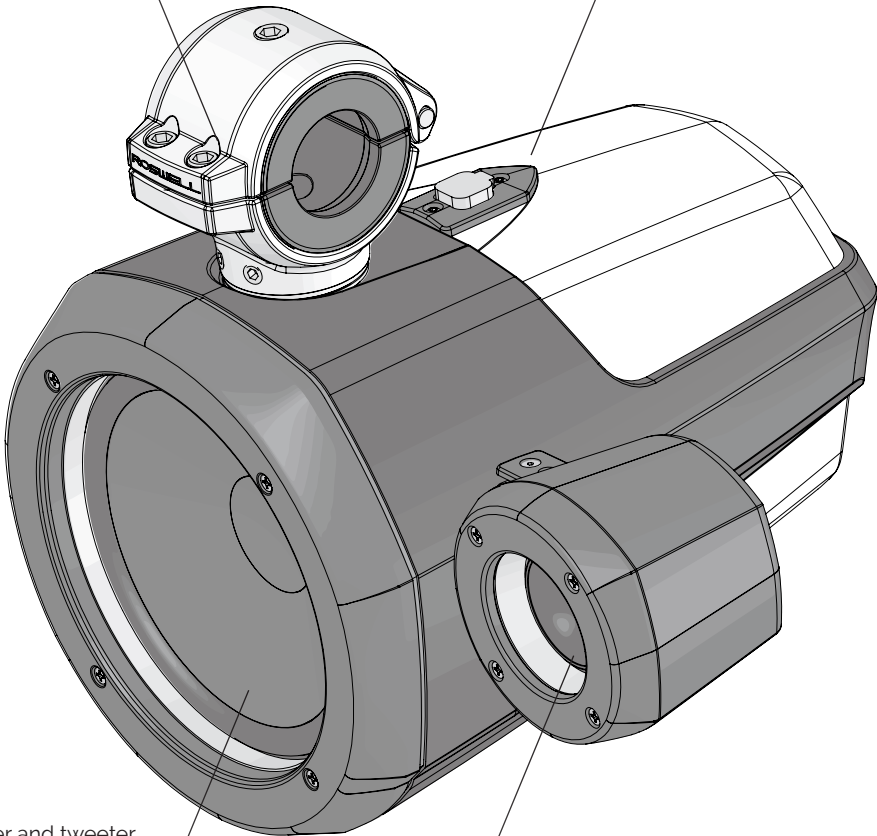

Woofer and Tweeter

Louder and lighter. Both the woofer and tweeter have been re-designed with this in mind.

R1 PRO Tower Speakers	
CONTINUOUS POWER (RMS)	200 Watts
PEAK POWER (RMS)	400 Watts
SENSITIVITY	Woofer: 95dB @ 1W/1M Tweeter: 103 dB @ 1W/1M
FREQUENCY RESPONSE	60 Hz - 20 kHz
IMPEDANCE Ω	4 Ω

This speaker took everything you know and love about the Neptune's and made it even better with the R1 Pro. Besides the performance upgrades the R1 Pro is lighter and brighter than ever. With its new and improved woofer and tweeter you can listen to your music at new levels. On top of hearing your music louder and clearer the R1 Pro has a patent pending emissive housing that allows you to customize the color of the rear housing to match your boat, your mood, or your music.

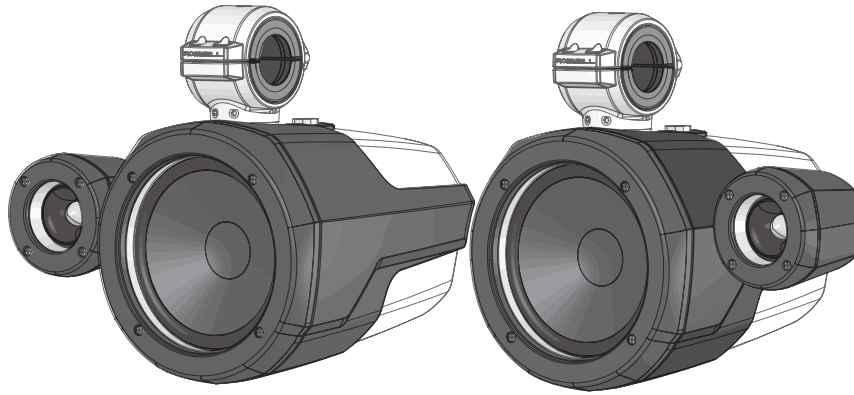

⚠ ATTENTION ⚠

- Bolts and screws tend to rattle loose over time due to the vibrations and shaking that your boat experiences while on the water or in transit. Always check all your speakers are securely fastened by checking speakers bolts for tightness before using your boat. If any bolts are found to be loose remove them, apply red threadlock and re-tighten the bolts.
- Never hang off of the speaker under any circumstance.
- Be mindful of the head clearance to prevent head injuries.
- Be aware of your tow rope being sure not to get it wrapped around the speaker or any other objects.
- These speakers are capable of easily producing sound pressure levels (SPL) in excess of 100 dB, even in an open air environment like a boat. Sound pressures at or above these levels can easily cause permanent hearing damage or loss. Be sure to use safe listening practices and protect your ears.
- Users of these speakers should be mindful of their surroundings as sound travels further over water.
- Covering your speakers with something removable such as after-market covers during transit or storage can save you a lot of time cleaning and also protect your speakers from damage.

Use and Care.

Before use do an inspection of your speakers, checking for loose hardware. We recommend keeping a set of Allen keys in your boat. Even with threadlock bolts can still loosen over time.

NEVER USE CLEANERS ON YOUR SPEAKERS, The R1 Pro is a plastic housing and using cleaners can ruin the finish of your product. A mild soap and water combination can be used to remove traveling grime or water spots. Make sure you are using soft cloths to avoid scratches.

To keep your R1 Pros looking their best, it is recommended to keep the speakers covered when not in use or when traveling.

Package Contents

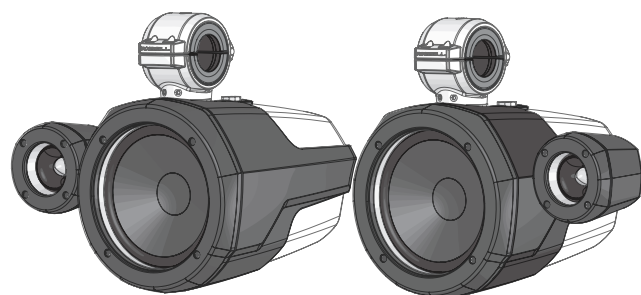

X2 R1 Pro Speakers

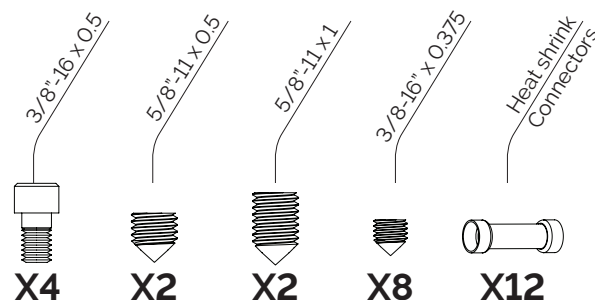

X2 Wiring Harness



X2 Safety Lanyard

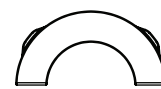

X4 1.90" Insert



X4 2.375" Insert



X4 3.0" Insert

Tools Required

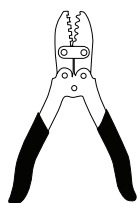

Crimps



Wire Strippers



Red / Blue
Threadlock

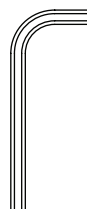

Allen Key
3/16"
5/16"
3/32"

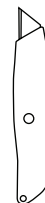

Knife

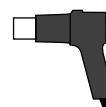

Heat Gun

Preparation

Before you start make sure that you have all of the required tools to install your product.

Note: You will need to provide your own in boat and tower wiring unless your boat has already been set up to the configurations you desire.

Roswell recommends using 16 gauge wire for the audio connections and 18 gauge wire for the 12-volt LED connections.

12-Volt LED Wire (not included)

- Note: Consider how you would like to use the integrated RGB LED before you begin installation. It can either be hard-wired to one of 7 different colors or you may purchase an LED controller to allow any combination of colors and patterns (see next page for details).
- If you are hard-wiring the RGB LED's on these speakers, you will need (1) 18 gauge power and (1) 18 gauge ground wire from the speaker mounting locations to your power source.

- If you are using an RGB LED controller, you will need to run (1) 18 gauge power and (3) 18 gauge ground wires from the speaker mounting locations to your LED controller. Refer to the RGB LED controller instructions for further information. Roswell RGB Controller (Part #. C920-1620).

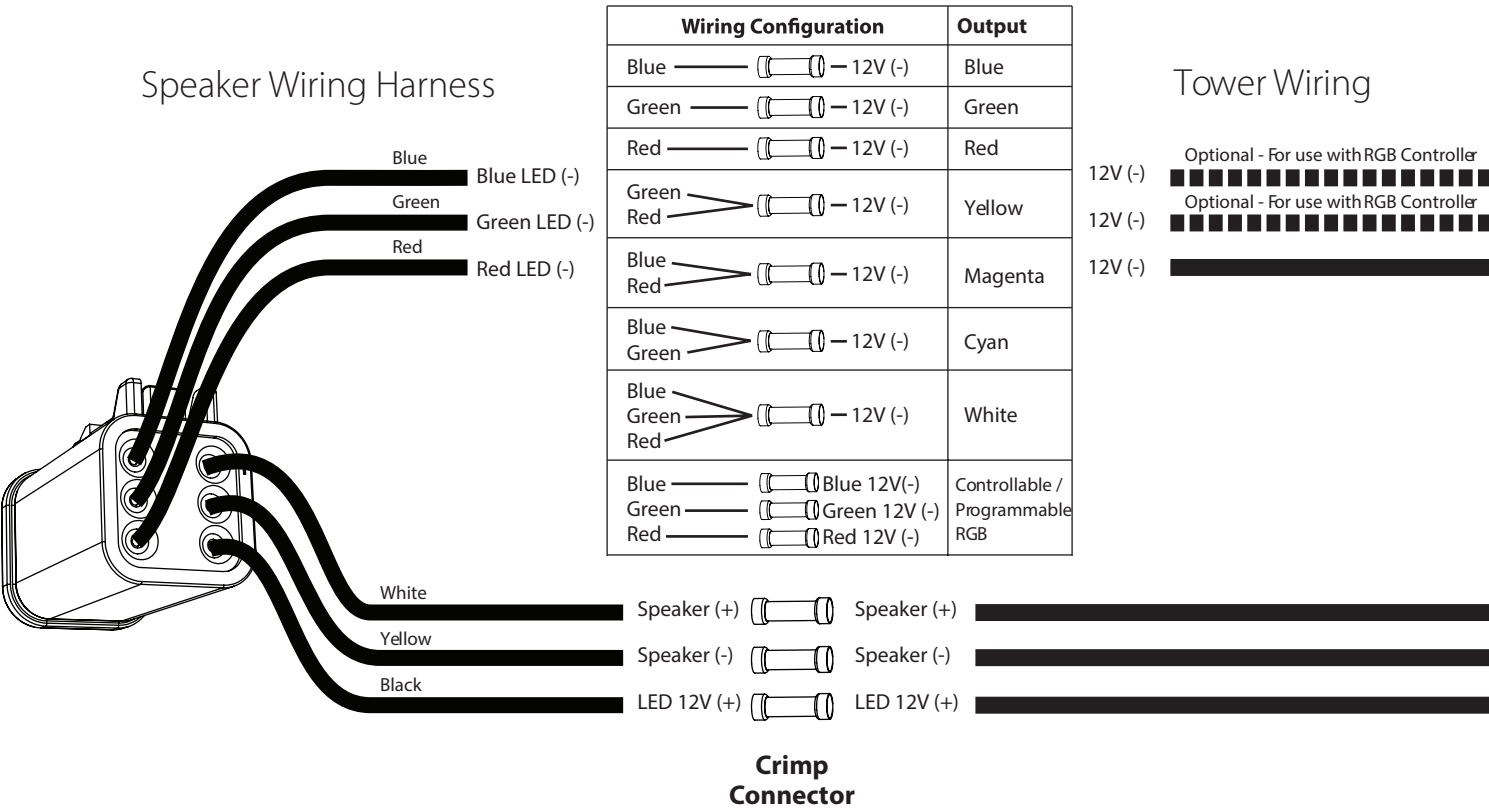

Wiring

1

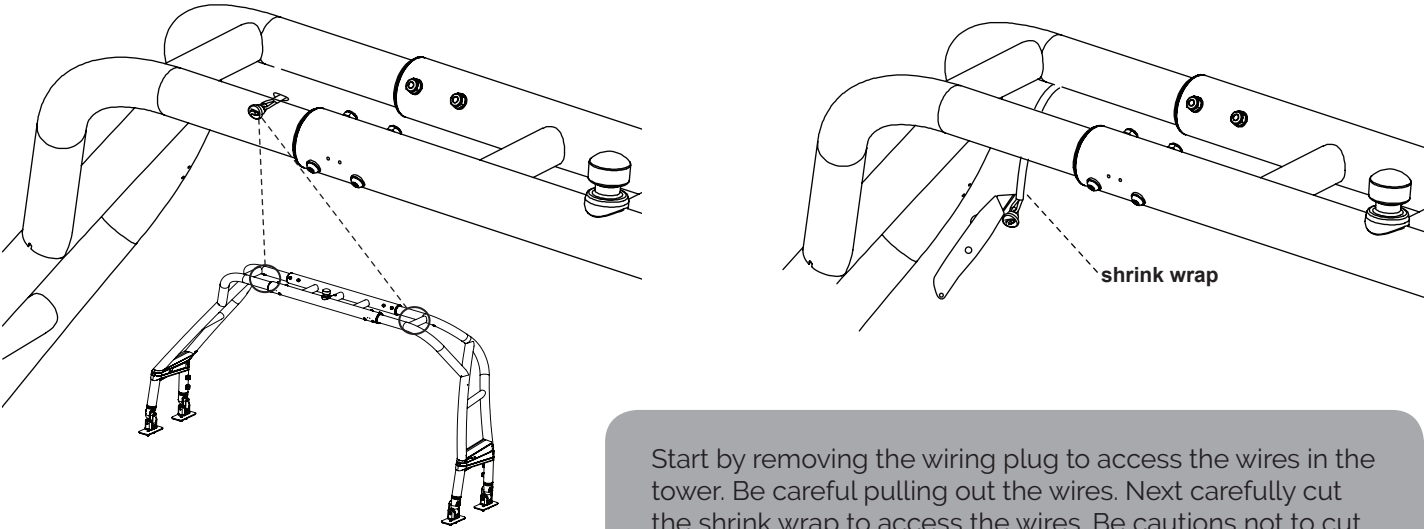

Start by removing the wiring plug to access the wires in the tower. Be careful pulling out the wires. Next carefully cut the shrink wrap to access the wires. Be cautions not to cut through the wire insulation.

NOTE: The illustrated Aviator tower is not pre-wired for the RGB controller.

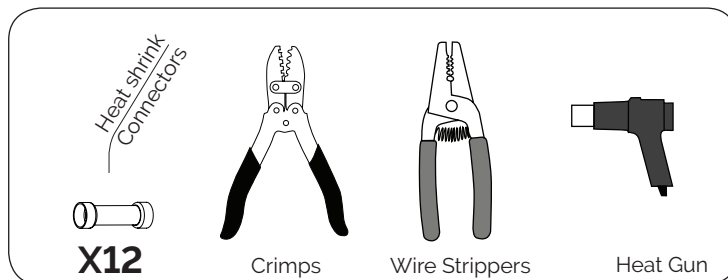
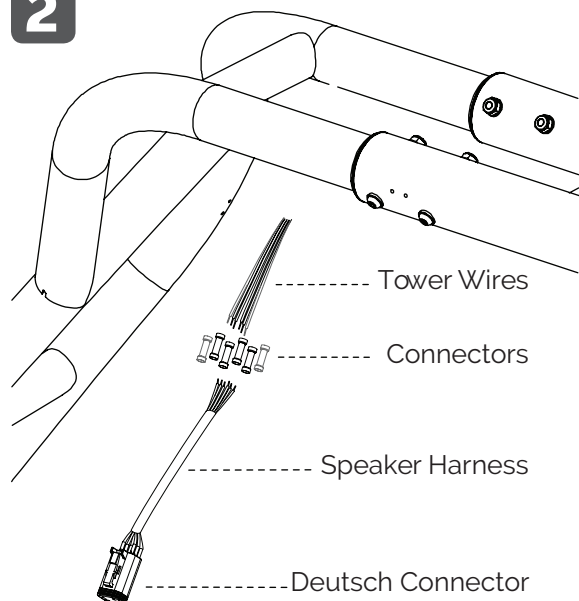
2

Strip 1/4" off of the wires and crimp the splice connectors to the corresponding wires. Once attached use a heat gun on the heat shrink to seal the connections.

NOTE: The illustrated Aviator tower is not pre wired for the RGB controller.

Installing Your Speaker

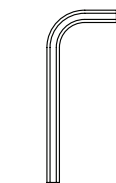
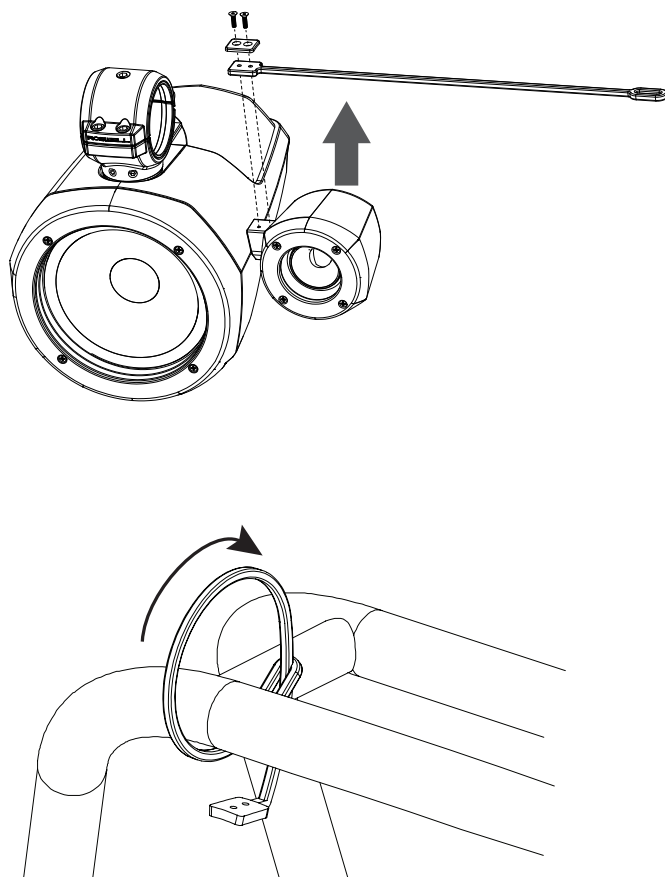
1

Allen Key
3/32

Two Person Job

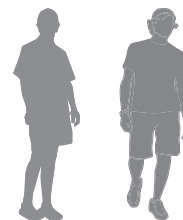

Remove the safety lanyard by removing the two bolts holding it onto the aluminum tweeter bridge with a 3/32" Allen key.

Next wrap the lanyard around the location you will be mounting your speaker. This is done by wrapping the lanyard around the tower bar and looping it through itself.

2

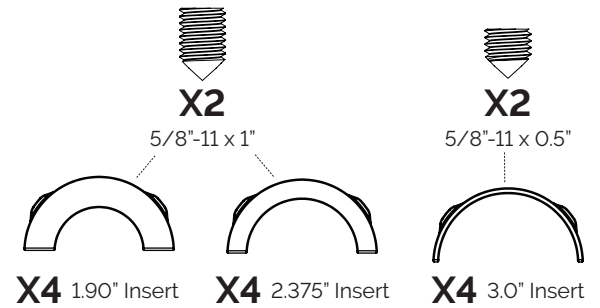
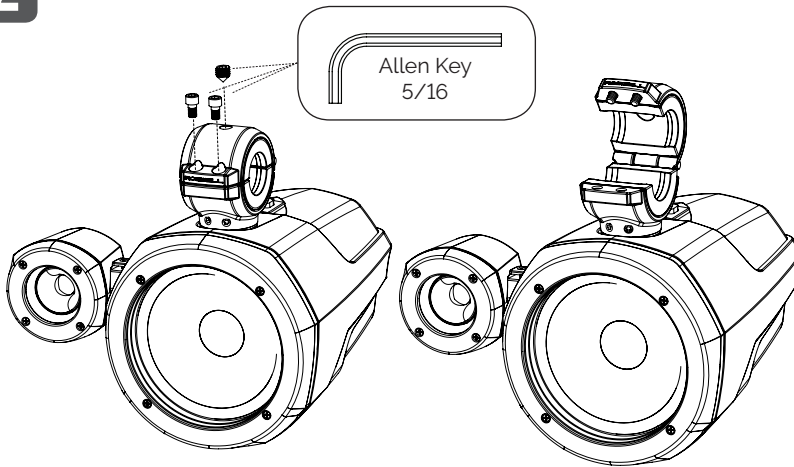

Start by unscrewing the two clamp bolts and the one set screw located at top of the clamp using a 5/16" Allen key. Next open the clamp. Once ready, select the correct size of insert and place it in the clamp.

3

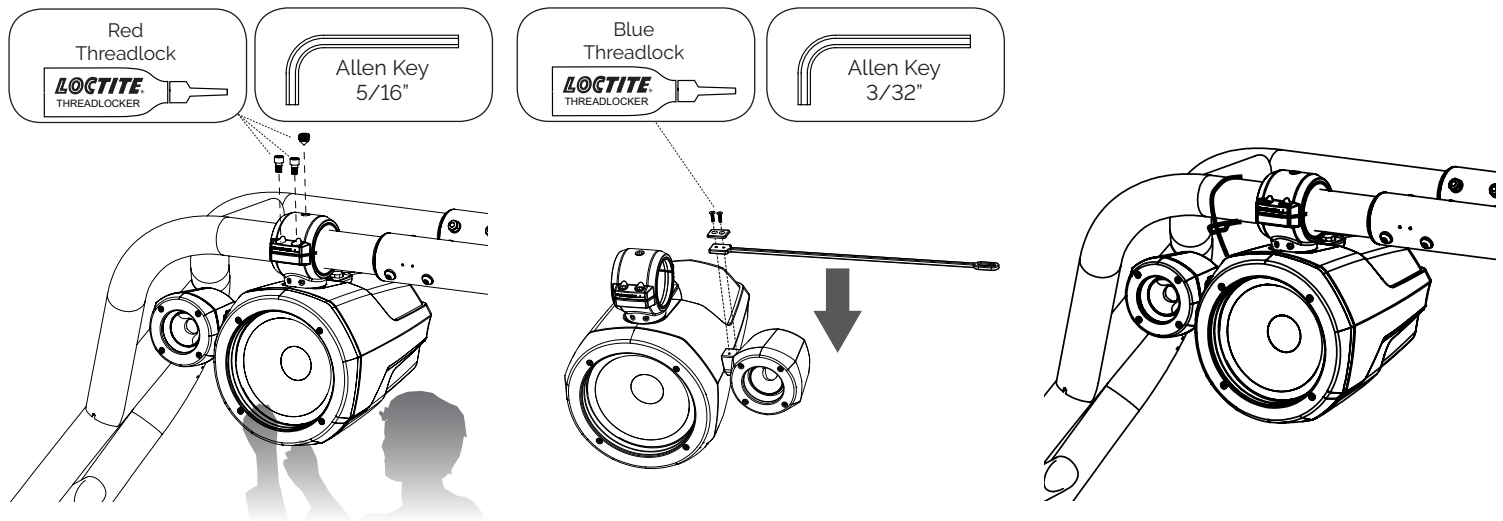

Have one person hold the speaker in the desired location close the clamp on the tower. Then apply red threadlocker to the two bolts and one set screw. Using a 5/16" Allen key tighten the bolts to secure the speaker.

Take the safety lanyard and connect it to the tweeter bridge. Apply a drop of blue threadlocker to each bolt and tighten them using a 3/32" Allen key.

Your speaker should look like this after assembling. Make sure that you still have access to the Deutsch connector on the rear of the housing.

4

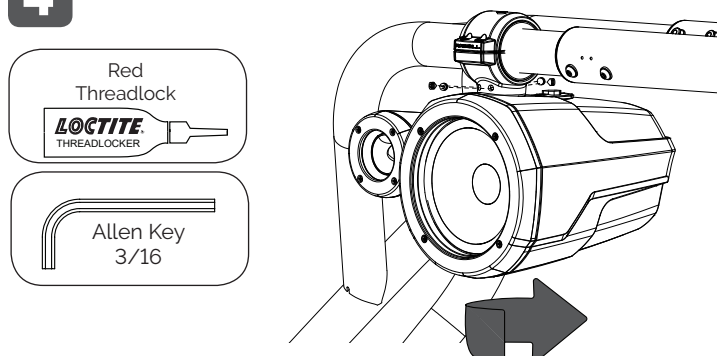

Now that your speaker is in position loosen the four set screws with a 3/16" Allen key. If your speaker is in the correct position apply red thread locker to the four set screws and tighten in position. If you need to adjust the angle of the speaker, rotate it to the desired angle. Apply red threadlocker to the four set screws and tighten in the desired position.

5

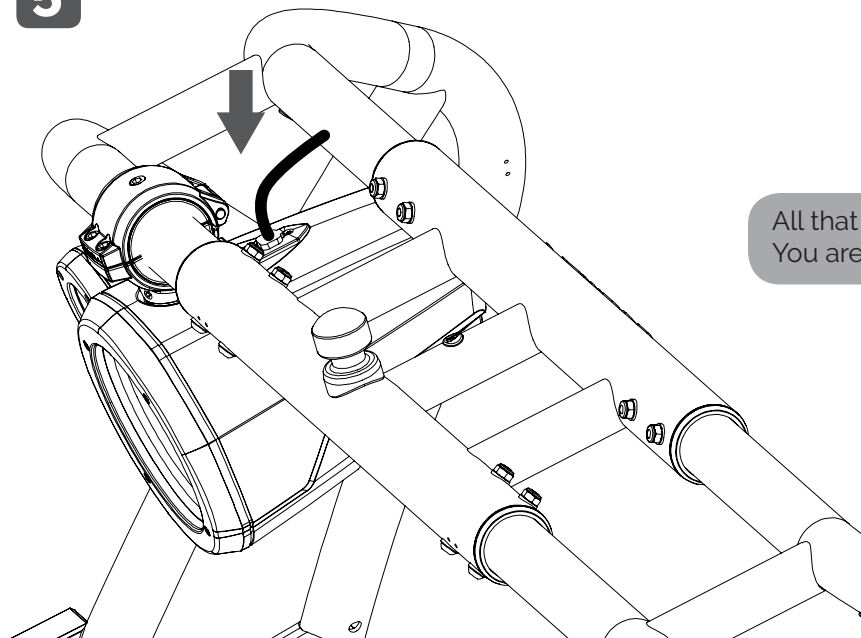

All that is left is plugging Deutsch connector correctly. You are now ready to enjoy your new speakers.

Roswell Limited Warranty

Roswell warrants all new R1 Pro Tower Speakers against defects in material and workmanship for a period of TWO (2) YEARS from the original date of purchase. This warranty is not transferable and applies only to the original retail purchaser from an authorized Roswell retailer. Upon inspection by Roswell, should service be necessary under this warranty for any reason due to manufacturer defects, Roswell will, at our own discretion, repair or replace the defective product with new or similar conditioned product at no charge.

THIS WARRANTY DOES NOT COVER INSTALLATION OR DAMAGE RESULTING FROM ACCIDENT, MISUSE, ABUSE, IMPROPER WIRING, COSMETIC DAMAGE DUE TO NORMAL WEAR AND TEAR, EXPOSURE TO CHEMICALS OR HARSH ENVIRONMENTS, OPERATION OUTSIDE OF THE MANUFACTURERS RECOMMENDATIONS OR SPECIFICATIONS, OR AGAINST INSTRUCTIONS IN OWNERS MANUAL. IN ADDITION, ANY PRODUCT THAT HAS BEEN OPENED, TAMPERED WITH OR MODIFIED, OR IF ANY SERIAL NUMBERS HAVE BEEN REMOVED, WILL NOT BE COVERED BY ANY PART OF THE MANUFACTURES WARRANTY.

All warranty claims must first be made in direct contact with Roswell's warranty department. When first contact is made the warranty representative will issue an RA # to open a claim. All warranty returns should be sent to Roswell freight prepaid and must be accompanied by proof of purchase (a copy of original sales receipt). Direct returns from consumers or non-authorized retailers will be refused unless specifically authorized by Roswell with a valid return authorization number (RA#).

All warranty returns should be packed in the original packaging and must be accompanied by a copy of the original sales receipt. Product damage during shipping will not be covered under this warranty. The customer or retailer may choose to have this damage repaired at the normal "Out of Warranty" repair cost.

In no event will Roswell be liable for incidental, consequential, or other damages resulting from the use of this product. This includes but is not limited to, damage of hearing, property or person, damage based upon inconvenience or on loss of use of the product, and to the extent permitted by law, damages for personal injury.

This warranty applies to products being sold and used in the United States of America and Canada. In all other countries please contact your authorized Roswell representative.

For warranty and non-warranty repairs, please contact Roswell.

Phone: 1-321-638-1331

Email: warranty@roswellmarine.com

R1PRO HANGING SPEAKER - WIRING DIAGRAM

