

ROSWELL.

www.roswellmarine.com



COBALT BOATS

Elite Wake/Surf Board Rack

Installation Instructions

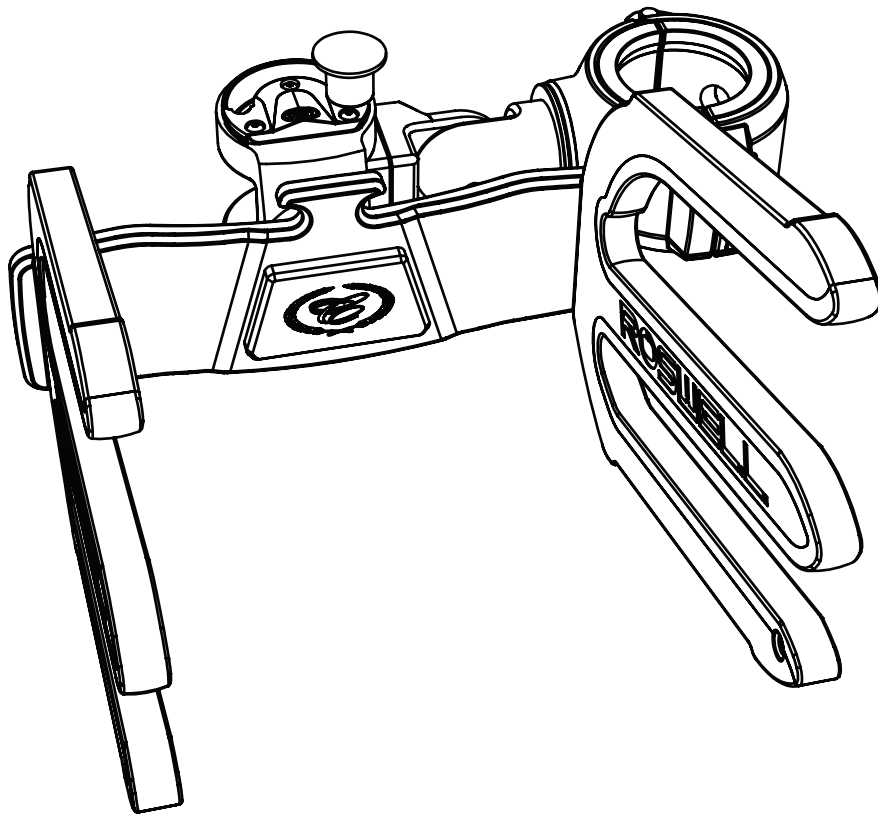

Part # C919-403301











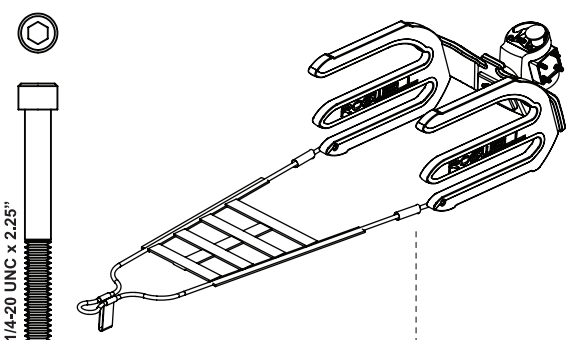
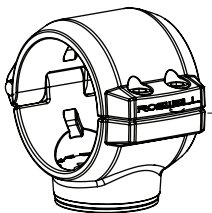

Information: info@roswellmarine.com

If you have any questions please call : 1-321-638-1331

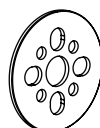

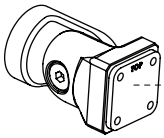
! ATTENTION !

- Always ensure your boards are securely **fastened** in place by the rack. Give the board a quick tug to check it is secure before setting off.
- Always ensure your swivel is properly **locked** before moving your boat. Give the rack a tug and visually check locking pin to make sure it is secure after you have put the swivel in a new position.
- Always swivel your racks inboard when docking and/or trailering your boat.
- Never trailer your boat with boards in the racks. Racks are for on water use only.
- Check all bolts on the rack and swivel for tightness before using your boat. If any bolts are found to be loose remove them, apply red thread lock and re-tighten the bolts.
- The driver should check their lines of sight before operating the boat being sure nothing in the rack blocks their safe view and operation of the boat.
- Be aware of your rope making sure it does not get wrapped around the board rack, the boards, or any other objects.

PACKAGE CONTENTS	Clamp Box Contents	Swivel Adapter box contents
 <p>1/4-20 UNC x 2.25" x4</p> <p>(x1) Cobalt Elite Wake / Surf Board Rack with MAG Swivel</p>	 x1  x2  x2  x1  x1  x2  x1  x1	 x1  x1  x3  x1

TOOLS NEEDED

Torque Wrench with
3/16" Allen Bit
1/4" Allen Bit
5/16" Allen Bit

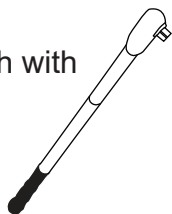

OR

3/16" Allen Key
1/4" Allen key
5/16" Allen Key

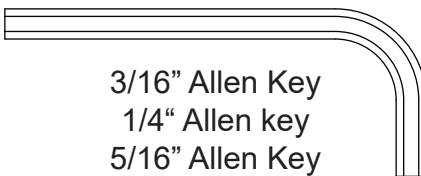

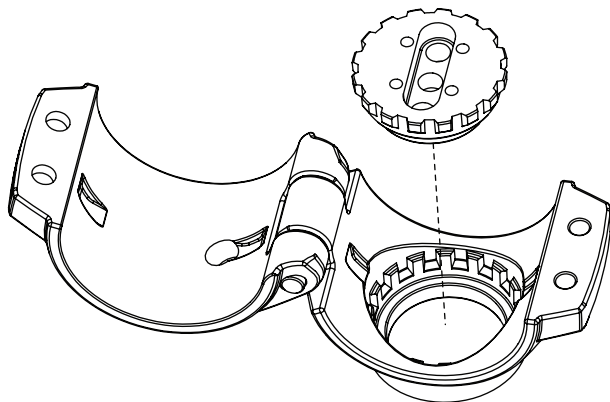
A

1: Insert the angle adjustment piece into the clamp base in the orientation shown.

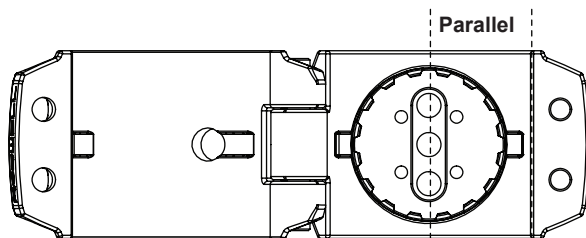

2: Once located, this is how your clamp should look. Ensure the holes are running parallel to the edge indicated.

B

Before proceeding to step C, view the images below to know how your clamp and swivel adapter will look once assembled depending on which side it will be installed on.

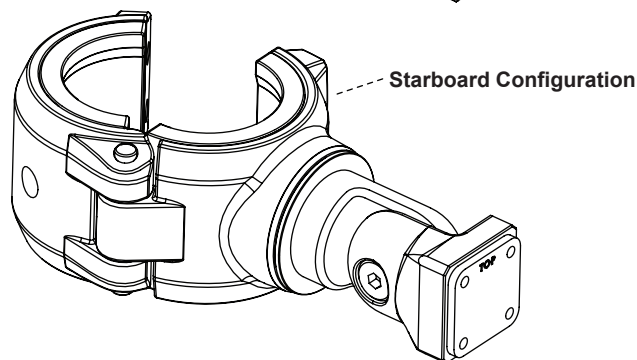
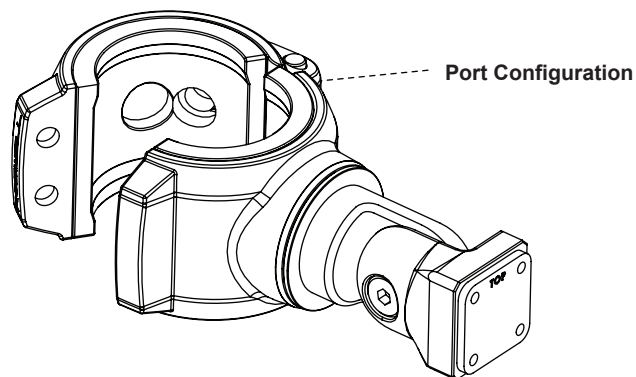
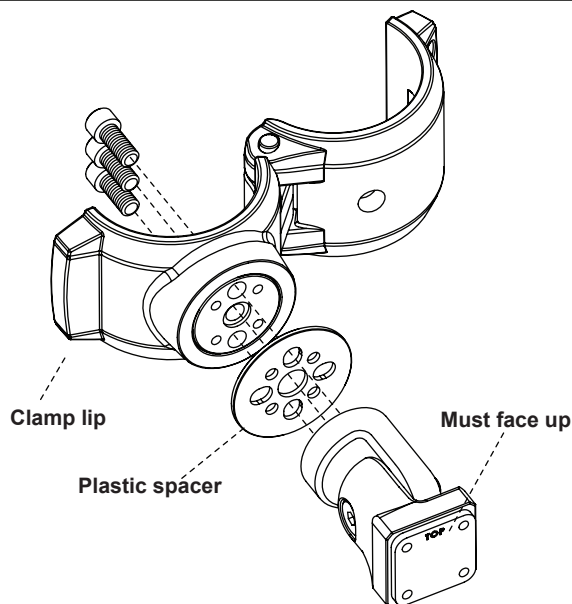
**C**

Assemble the swivel adapter to the clamp with the bolts provided. Be sure the plastic spacer is sandwiched between the clamp and the swivel adapter.

IMPORTANT

The swivel adapter has the word "TOP" Marked on it. This must face up for final installation. The Lip of the clamp must face out for final installation. See step B for Port vs. Starboard configuration.

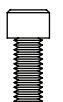
**x1****x3**

Torque bolts
to 25ft-lb

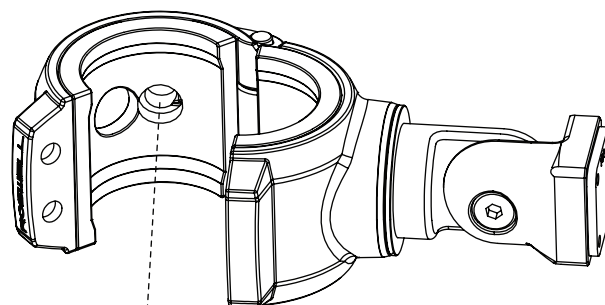
**D**

Set screw hole

**x2****x2**

Determine which size plastic inserts you require to mount your rack to your tower. Insert the appropriate size plastic inserts into the clamp halves being sure to line up the set screw hole in the plastic with the set screw hole in the top of the clamp.

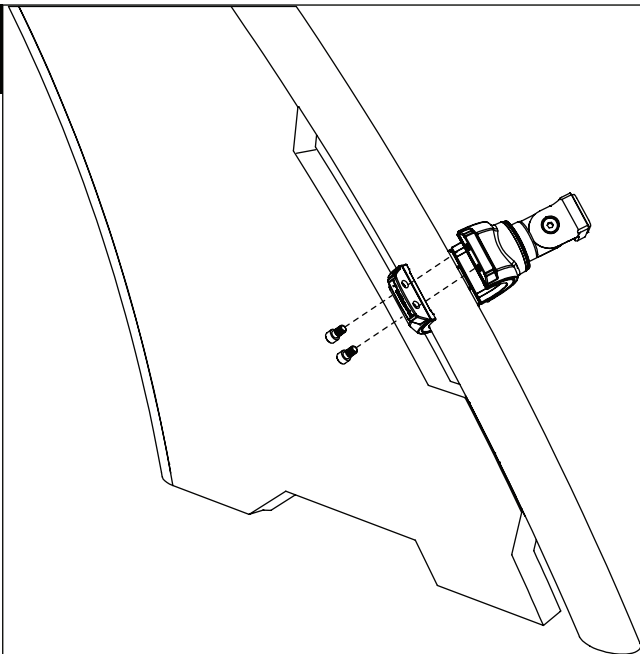
E

Mount the clamp and swivel adapter assembly to your tower tubing with the provided bolts as illustrated. Add a drop of red loctite to each bolt first.

**x2**

5/16" RED

Torque bolts to 25ft-lb

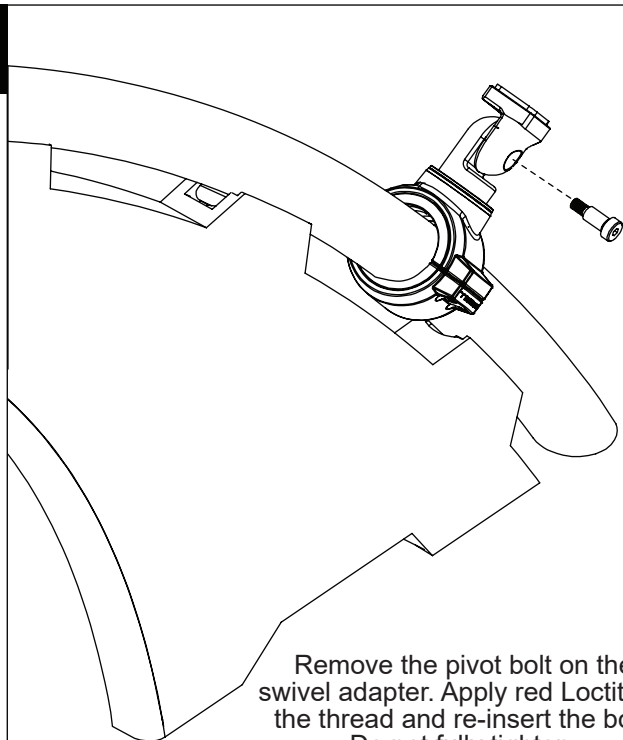
F

Remove the pivot bolt on the swivel adapter. Apply red Loctite to the thread and re-insert the bolt. Do not fully tighten.

**x1**

1/4" RED

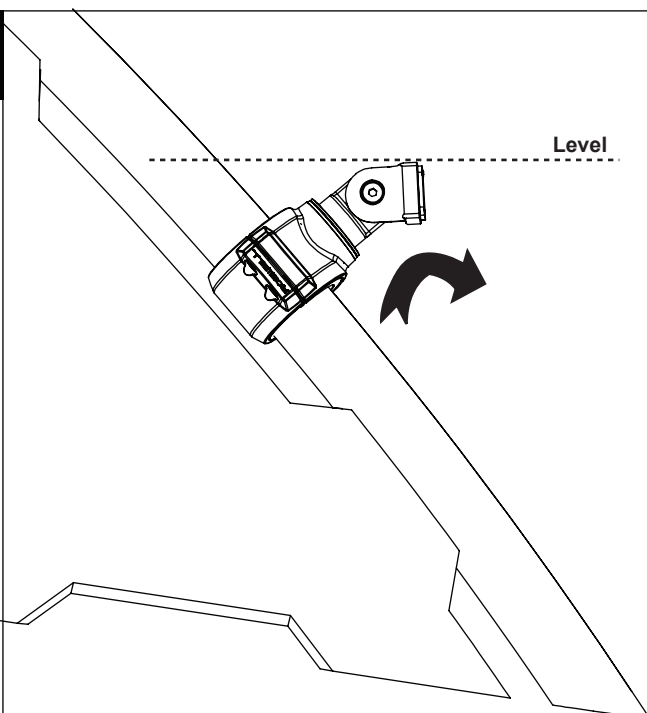
G

Rotate the swivel adapter fitting to as close to level as possible and tighten down the main pivot bolt left loose in step F.

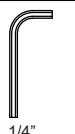

1/4"

Torque bolts to 25ft-lb

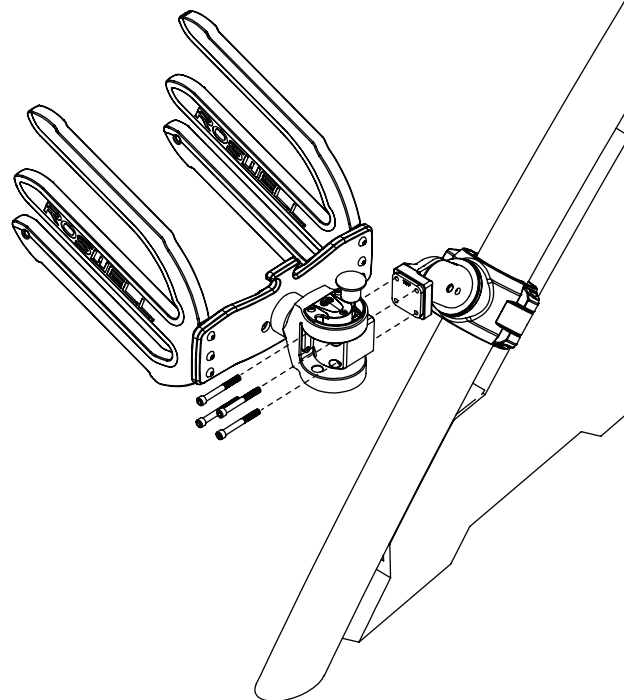
H

Mount the rack and swivel assembly to the swivel adapter as illustrated with the 4 bolts provided. Add a drop of red Loctite to each bolt first.

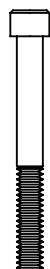
**x4**

3/16" RED

Torque bolts to 15ft-lb

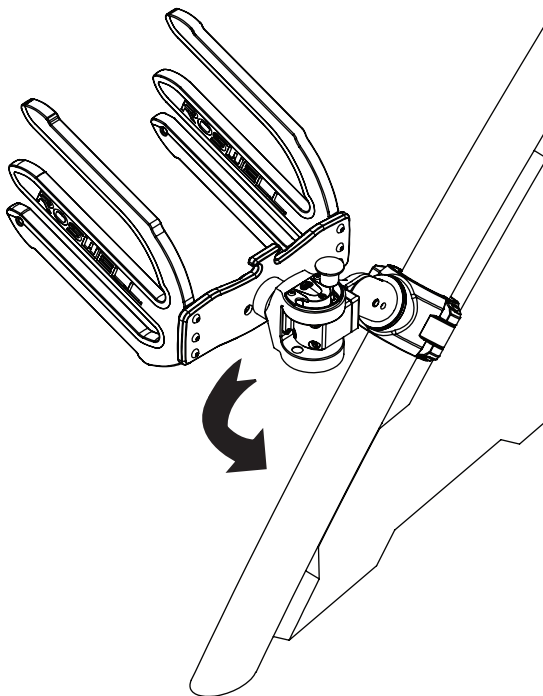
I

Swivel your rack to the inside and outside positions. Ensure your swivel is operating well and locking in both positions. Ensure there is no interferences occurring. This is the point where you can tweak the angle of the swivel adapter (Step G) and the clamp angle on the tubing to optimize fit and function. If you alter anything, Check clearance and function again.

J

Use with
2.5" clamp
inserts



x1
OR



x1
Use with
2.0" clamp
inserts



x1

Torque set screws
to 25ft-lb

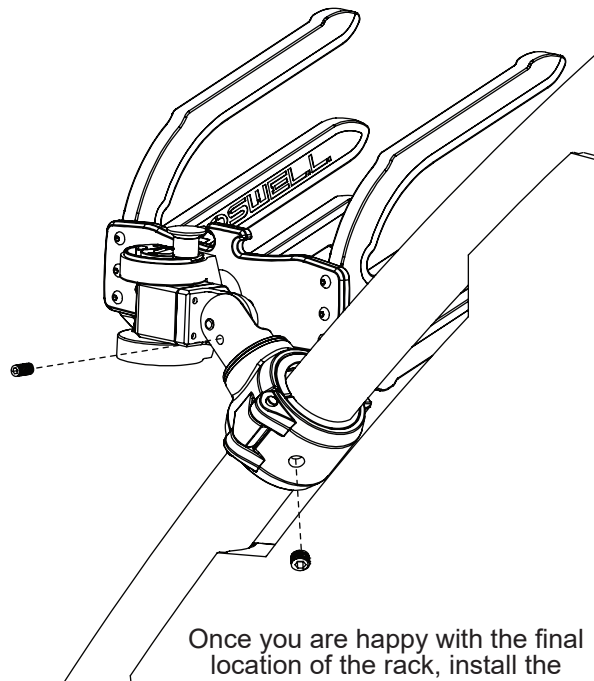

Once you are happy with the final location of the rack, install the swivel adapter set screw to lock in the angle of the swivel adapter. Then install the clamp set screws to lock the location of the entire rack assembly. Apply a drop of red Loctite to each set screw first.

Enjoy your Cobalt board rack!