

### Kit Contents

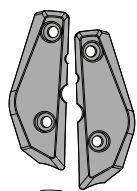

Heel Block  
(1 Port, 1 Stbd)

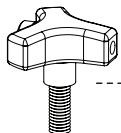

Tri-Lever  
Hand Knob  
(x 2)

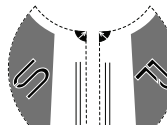

Drilling Template  
(1 Port, 1 Stbd,  
1 Bottom Port, 1  
Bottom Stbd))

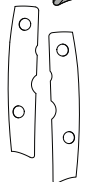

Plastic Pad  
(1 Port, 1 Stbd)

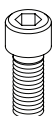

0.5" Ø Bolt  
(x 2)

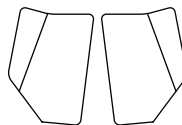

Warning  
Decal  
(1 Port, 1 Stbd)

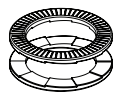

Nord-Lock  
Washer  
(x 4)

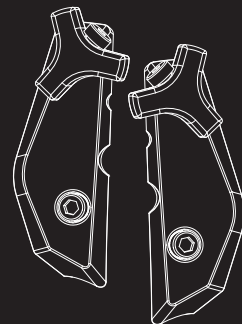

### Tools Required

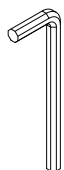

3/8 Allen Key



1/8" Drill Bit  
1/4" Drill Bit  
27/64" Drill Bit



Center  
Punch



Hammer

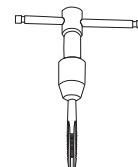

1/2" Ø 13 UNC  
Tapered Tap  
1/2" Ø 13 UNC  
Bottoming Tap

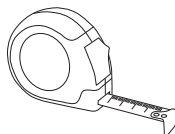

Tape  
Measure

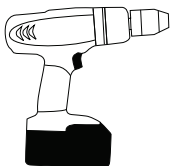

Drill

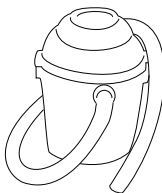

Wet/Dry  
Vacuum

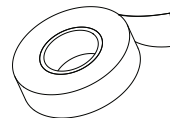

Masking Tape &  
Electrical Tape

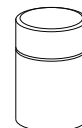

Cutting  
Lubricant  
Paste or Stick

## ! WARNING !

Verify that the cam latch upgrades have been completed prior to installing the Heel Block. Make sure the cam latch tension has been finalized before starting this procedure.

Always use caution with the tower in the folded position.

Wear safety glasses while drilling and tapping.

There is an instructional video showing this installation procedure at <http://vimeo.com/21306995>

**A** Carefully align the plastic pad and the Heel Block and tape them together. This will protect the paint finish on the tower as you determine the hole centers.

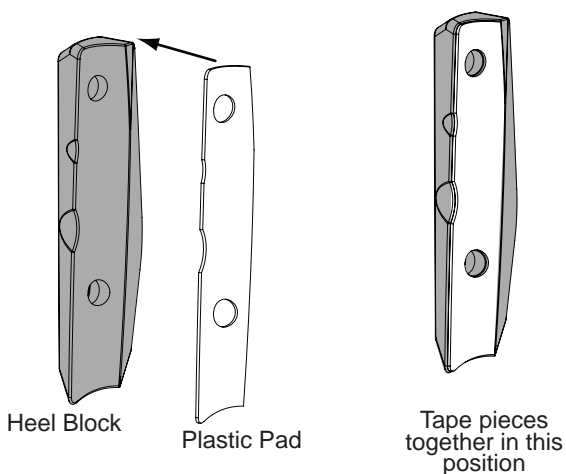

**B** Fold the tower down and tightly wrap the rob line with 2 layers of electrical tape to protect it during the drilling and tapping process. Start 5" from the bottom and tape to the anchor point of the rob line.

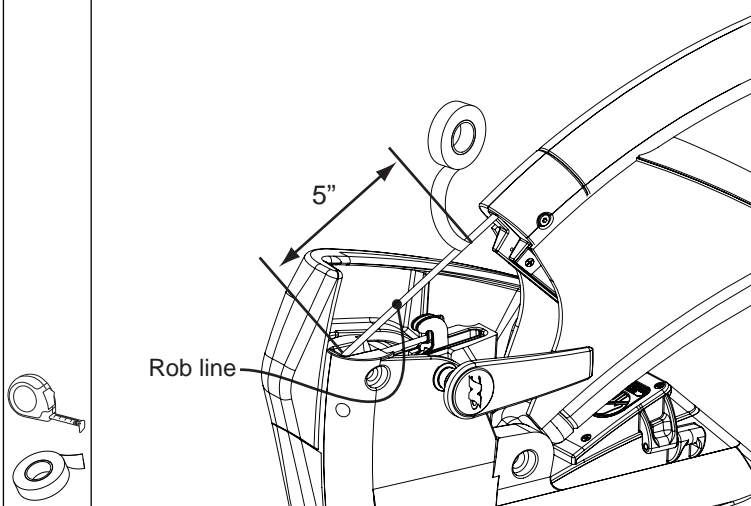

**C** Apply masking tape to the side section of the tower where the block will go to avoid damaging the paint. Align the Heel Block with the tower side section using the larger circular cut-out on the Heel Block. The edge of the circular cut-out on the Heel Block should be between 1/16" and 1/8" from the bolt head on the mount, see image below right.

VIEW FROM INSIDE OF BOAT

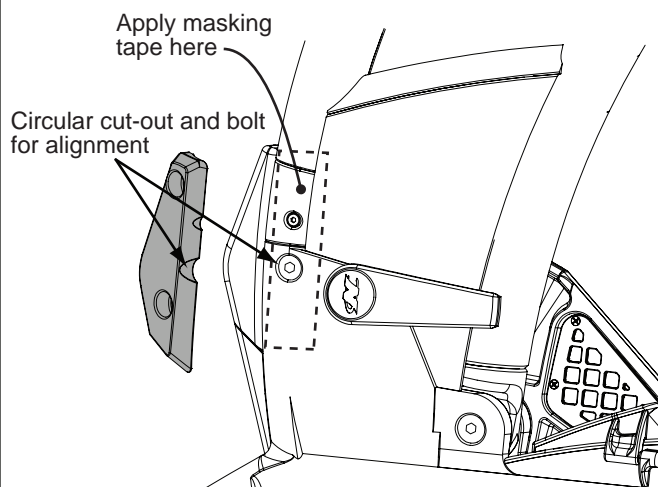

BLOCK POSTION

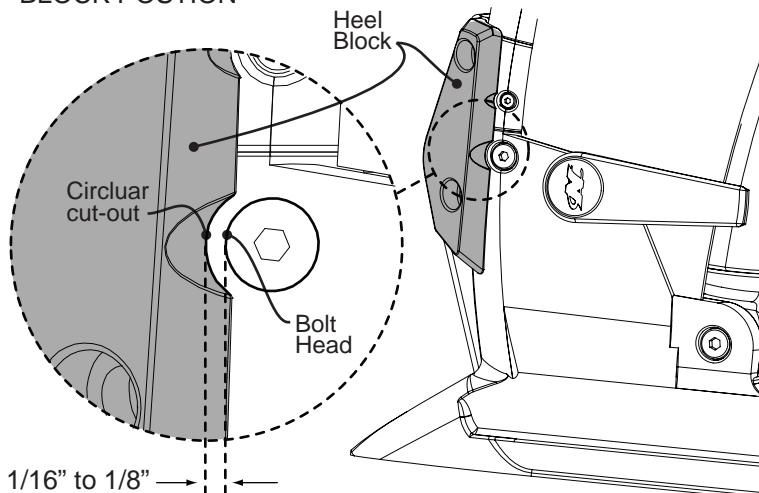

**D** Carefully mark the center of the bottom hole of the Heel Block using a center punch and a hammer. This center mark must be very precise. **Remove the Heel Block and the masking tape from the tower after the center has been marked.**

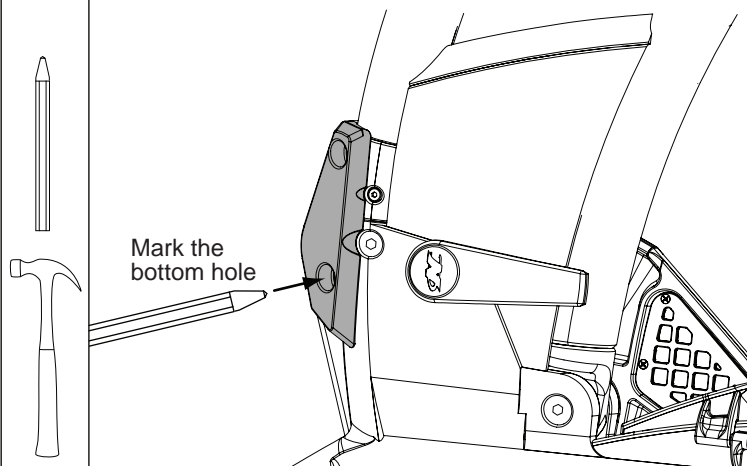

**E** It is recommended to use a cutting lubricant throughout the drilling and tapping process. Holding the nozzle of a vacuum up to the drilling area is also recommended.

Prepare the drill bits by marking them for depth control with masking tape as shown below.

1/8" Drill Bit: Tape off 1/2" from cutting end

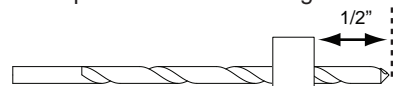

1/4" Drill Bit: Tape off 1 1/4" from cutting end



27/64" Drill Bit: Tape off 1 1/4" from cutting end



**F**

The drilling template will help keep the alignment correct from side to side. At the same time, have an assistant watch as the bore is drilled to make sure the drill stays horizontal.

TOP VIEW  
Use the template

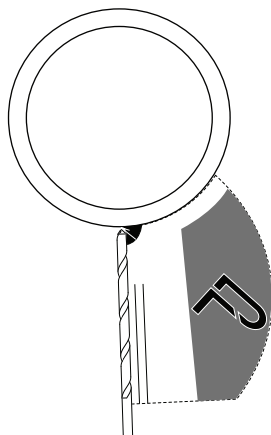

SIDE VIEW  
Keep the bit horizontal

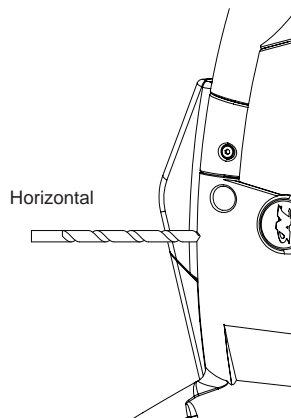
**G**

Hold the appropriate drilling template up to the side section and align the arrow on the template with the center mark from Step D. Slide the drill template down slightly so that there is room for the drill bit. Make sure the entire curved surface of the template is in contact with the tower leg. This will determine the correct alignment of the drill bit with the tower.

Drilling template

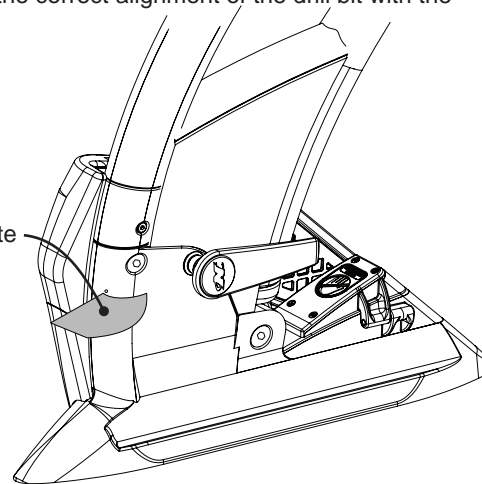
**H**

Drill the tower with the 1/8" drill up to the tape, then use the 1/4" bit to bore into the tower side section up to the tape on the drill bit. Re-drill the hole with the 27/64" drill bit until the tape on the drill bit reaches the tower. **THE ROB LINE MAY BE DAMAGED IF THE TAP IS INSERTED TOO FAR.** Using a cutting lubricant is highly recommended.

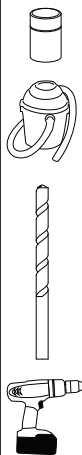

Drill at the bottom bolt location, from smallest to largest bit size

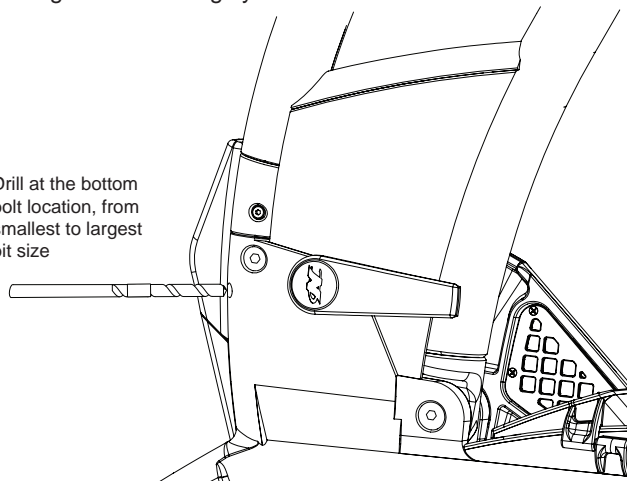
**I**

Using a 1/2" Ø 13UNC tapered tap, tap the 27/64" bore. Re-tap the bore with a bottoming tap of the same size. Do not insert the tap more than 3/4" to prevent damage to the rob line. **THE ROB LINE MAY BE DAMAGED IF THE TAP IS INSERTED TOO FAR.** Using a cutting lubricant is highly recommended.

First use a tapered tap, then use a bottoming tap

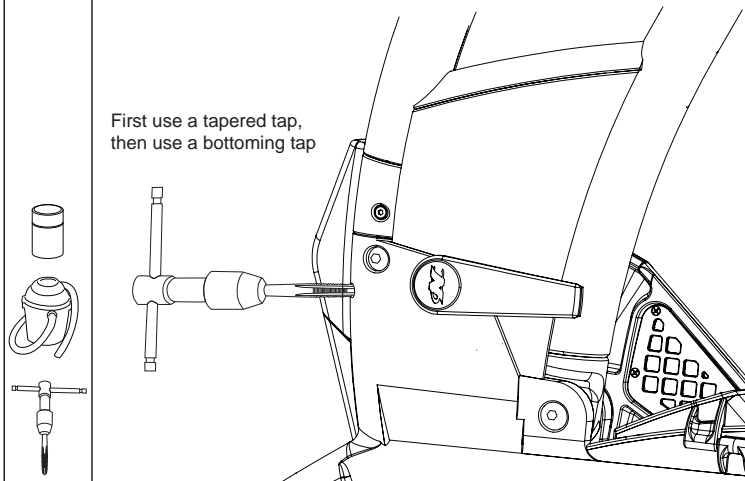
**J**

Clean out the tapped bore and then bolt the Heel Block to the tower with the plastic pad in place (make sure tape is removed from tower and Heel Block). Use a Nord-Lock washer between the Heel Block and the head of the 1/2" Ø bolt.

1/2" Ø Bolt  
Nord-Lock

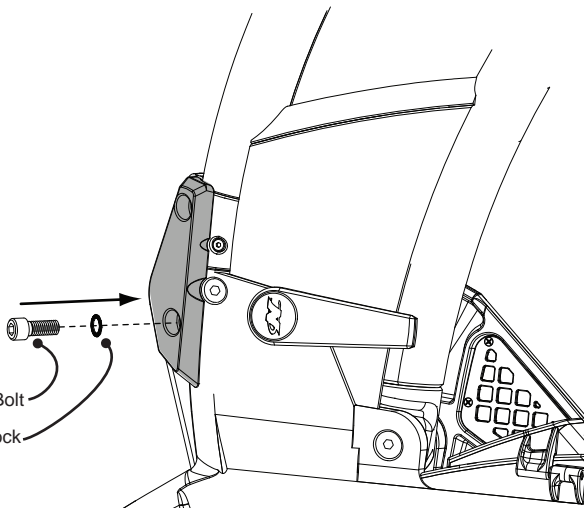
**K**

With the heel block bolted in place, use the hammer and the center punch to mark the center of the upper hole.



Mark the top hole

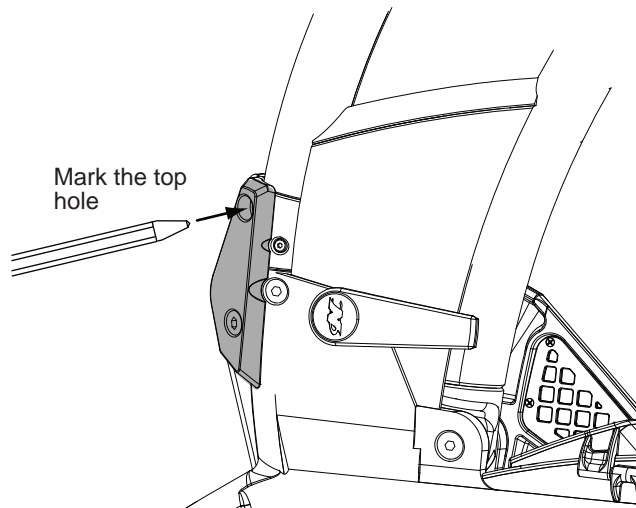

**L**

Repeat steps F through I for the upper hole.

For Step F, use the appropriate template and drill with the bit pointing upwards 5° instead of horizontal.

For Step I, tape off the taps at 7/8", using the same method shown in step E for the drill bits. Stop threading when the tape reaches the tower to prevent damaging the rob line, see below. **THE ROB LINE MAY BE DAMAGED IF THE TAP IS INSERTED TOO FAR.**

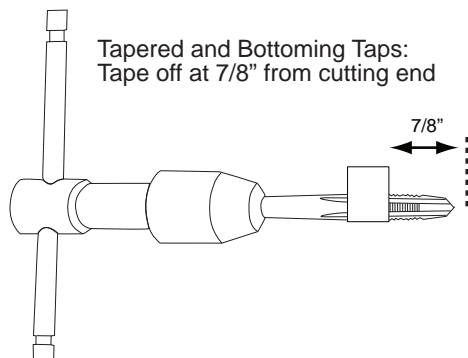
**M**

The torque handle can be installed in the handle to increase leverage for tightening the Tri-Lever Hand Knob.

Torque Handle:

1. Remove torque handle from stowed position
2. Insert it into the Tri-lever Hand Knob

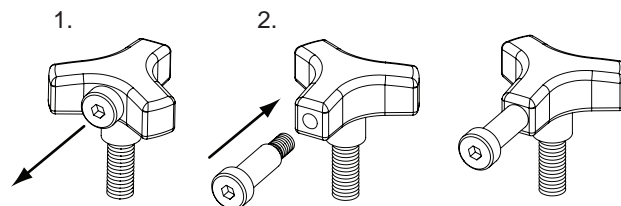
**N**

Before installing the Tri-Lever Hand Knob, fold the tower down and remove the tape from the rob line. Then put the tower in the upright position and install the Tri-Lever Hand knob.

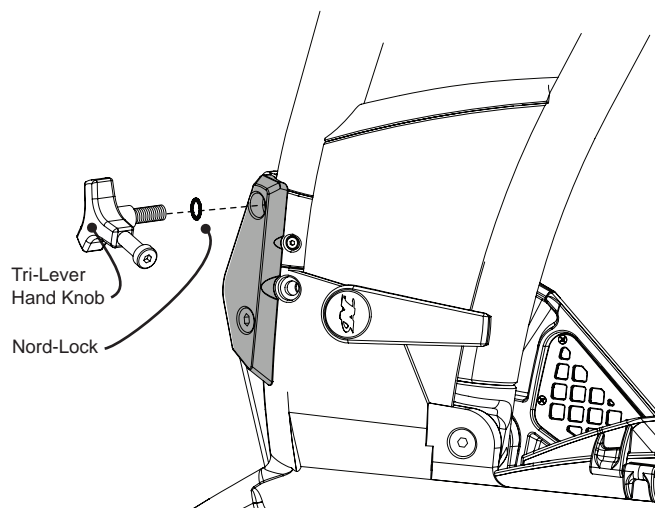
**O**

Make sure the surface of the heel block is clean and apply the warning decal as shown.

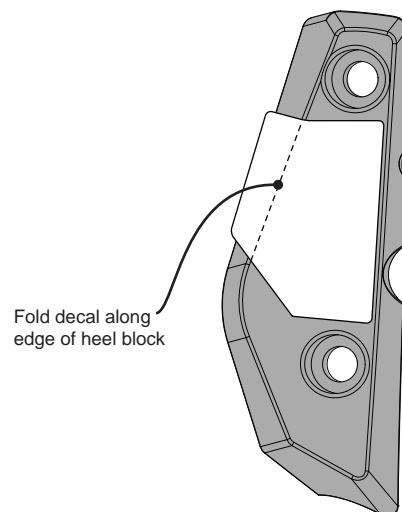

Repeat all steps on the other side of the tower

If you have any further questions please call Roswell USA at (321) 638-1331

[WWW.ROSWELLWAKEAIR.COM](http://WWW.ROSWELLWAKEAIR.COM)

