

# MOOMBA

## Top Spin Tower Speaker Assembly Instructions

### Speaker Hardware

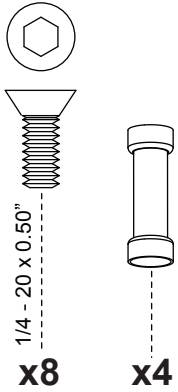

### Tool Required

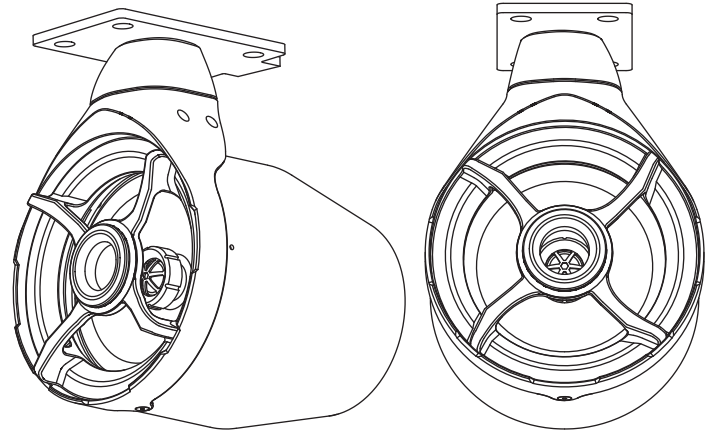
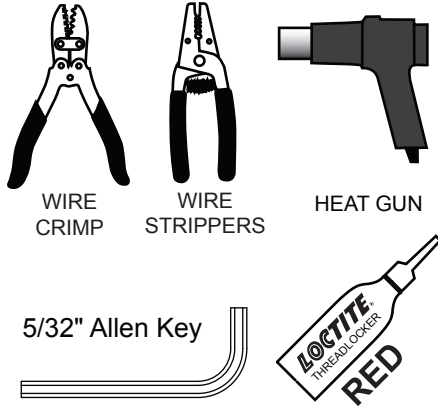

### A

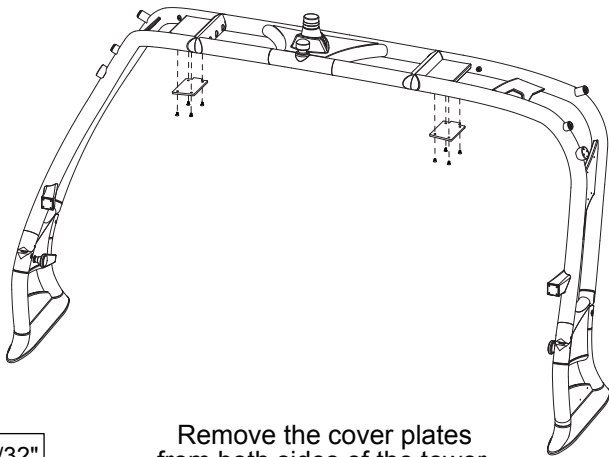
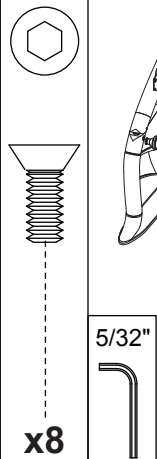

Remove the cover plates from both sides of the tower. Set bolts aside. These will be reused to mount your speakers.

### B

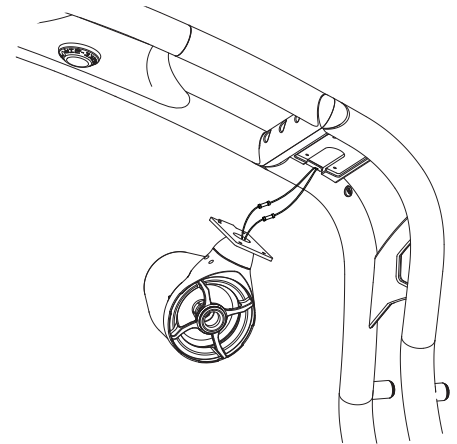
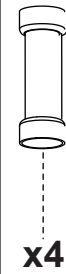

### Starboard Side Wiring

Attach the speaker wires to the corresponding tower wires using the supplied connectors. View block C for details.

### C

1) Use wire strippers to expose 1/4" of wire on all wires.

| Port | Tower         | Speaker        |
|------|---------------|----------------|
|      | White         | Green          |
|      | White & Black | Green & Black  |
| Stbd | Tower         | Speaker        |
|      | Grey          | Purple         |
|      | Grey & Black  | Purple & Black |

Crimp

2) Slide matching wires into opposing ends of the connectors and crimp.  
3) Heat shrink the connectors.

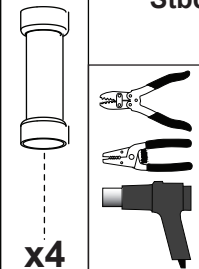

### D

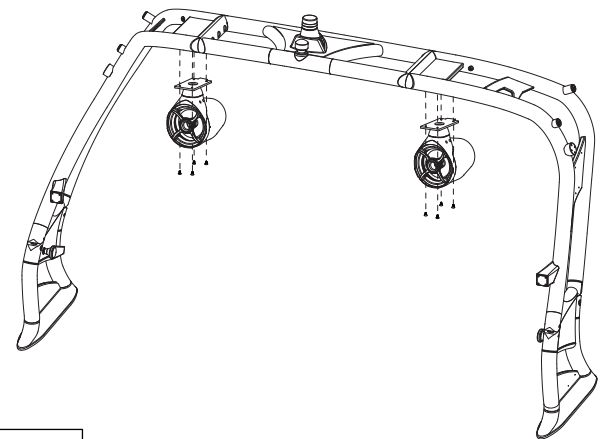
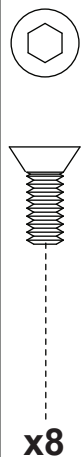

Apply RED Loctite to all bolts, carefully push extra wire length into the recesses of the tower. When mounting the speakers, make sure you are not clamping or pinching any wires.

