

NOTE: Tools Required

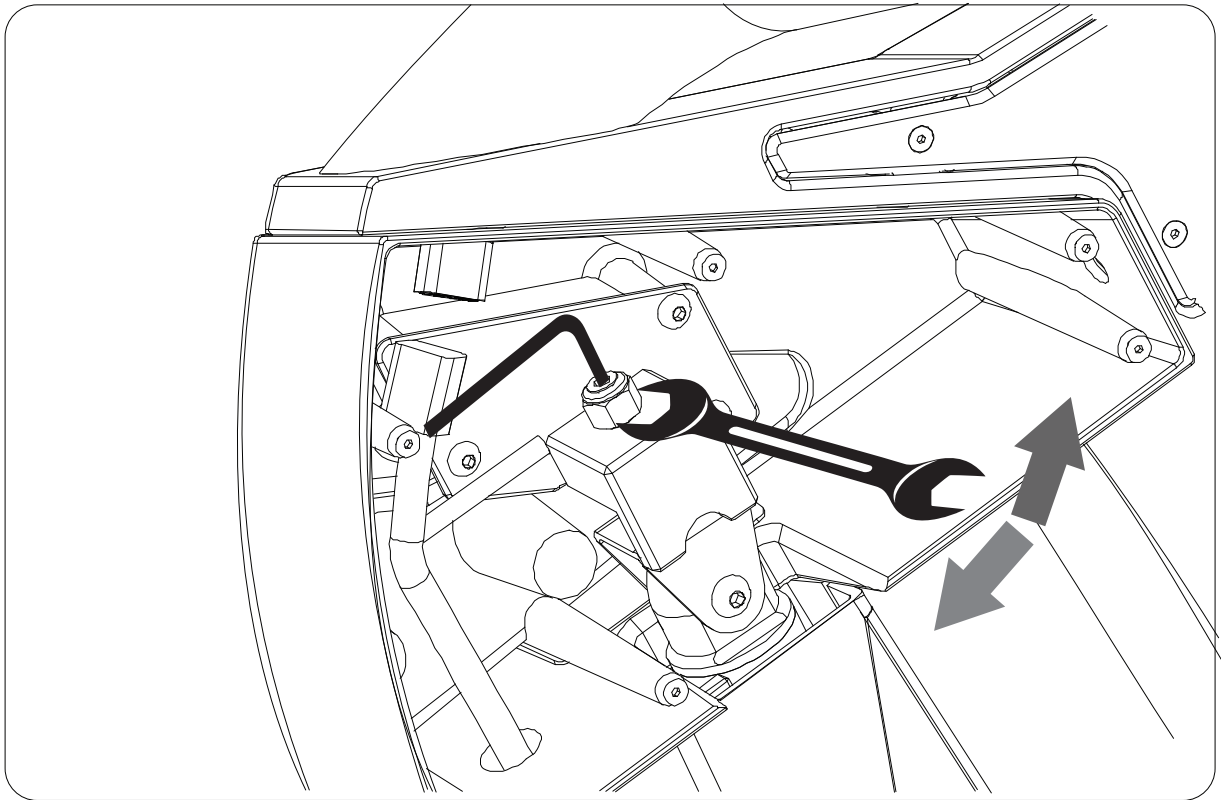

2 Person Job

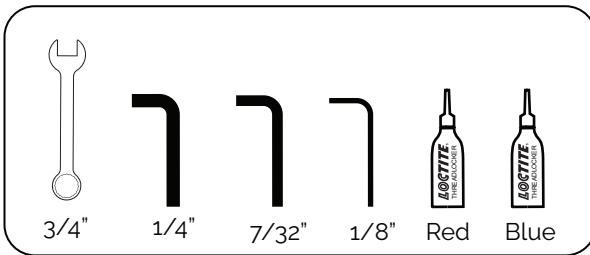
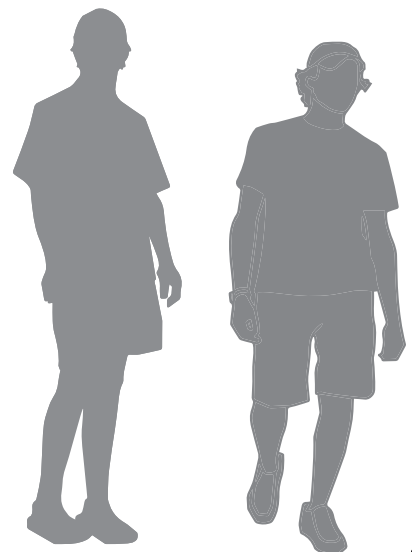

Step 1

Get someone to hold the Coverfire Speaker and remove the five bolts Holding the speaker to the tower using a 7/32" Allen Key.

Step 2

Drop the speaker housing down and pull it toward the stern of the boat and hold until re-install of the speaker.

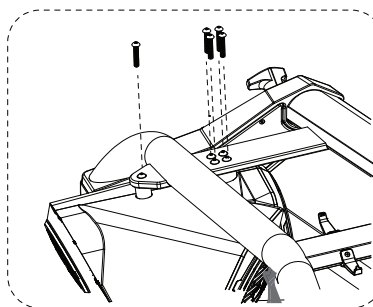

NOTE: leave speaker wire attached

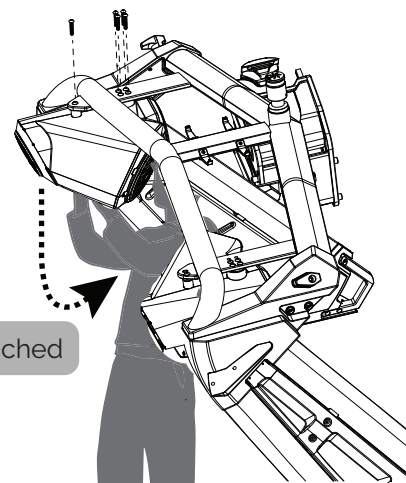

Step 3

Remove the access panel with a 1/8" Allen key.

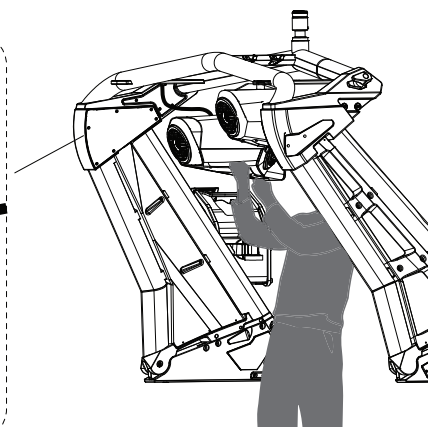
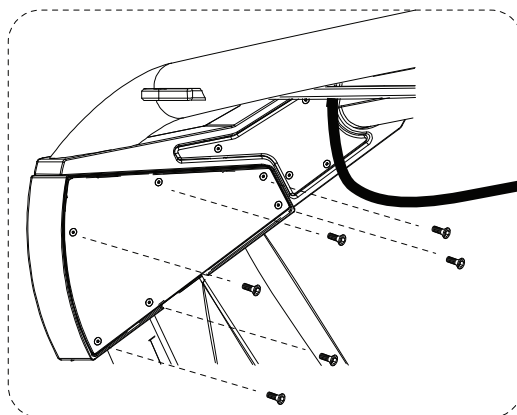

Step 4

To remove the slack in the actuator start by loosening the locknut with a 3/4" Box End Wrench. Using a 1/4" Allen key, tighten the rob line by rotating the bolt counter clockwise. Once tight, lock the bolt in place with the locknut using the 3/4" Box End Wench.

Note!

Unlock both cam latches and tighten one side until the tower comes in contact with the rubber bump stops you will have to repeat this for the other side. Do not over tighten as this adds excessive wear to the actuator and Rob line.

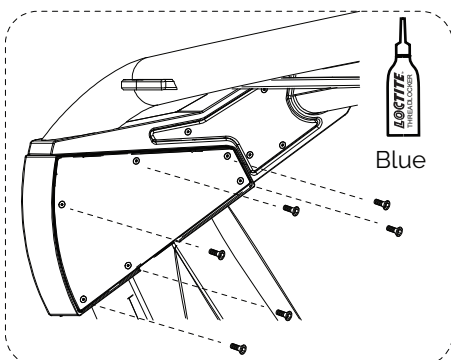
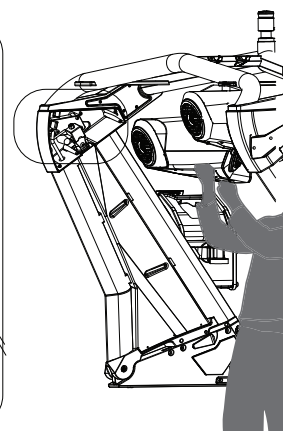
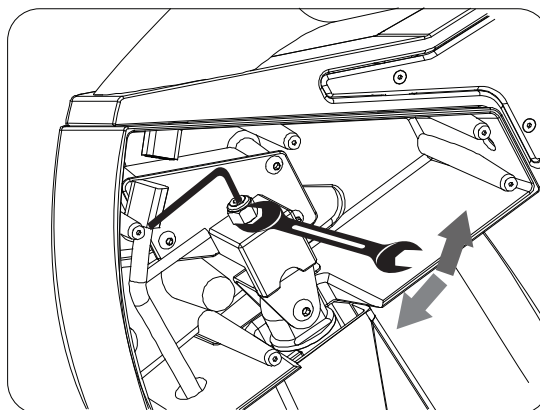

Step 5

Install bolts. Re-apply Blue Loctite.

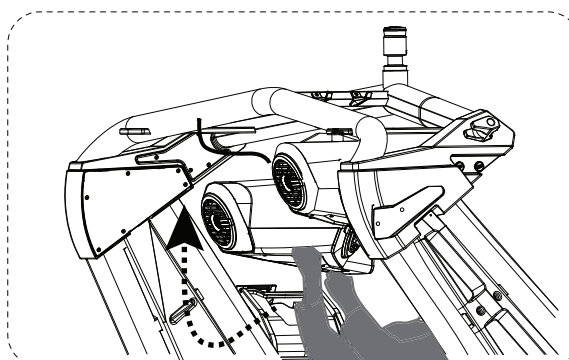

Step 6

Move speaker back into position and feed wiring into the tower.

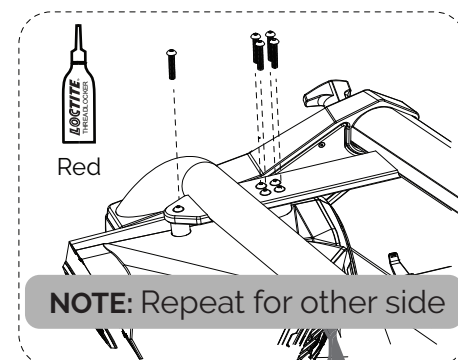

Step 7

Install bolts and apply Red Loctite.

NOTE: Repeat for other side