

SUPRA

Pro Edge Tower Bimini Installation Instructions

Contents of Bimini Box

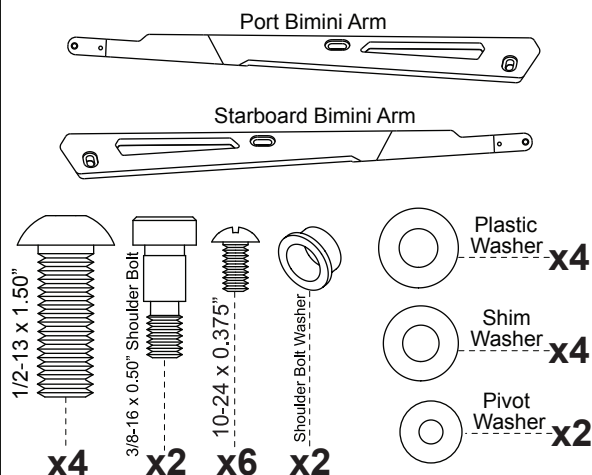

Bimini Frame,
Canvas, Clips
and Boot

Tools Required

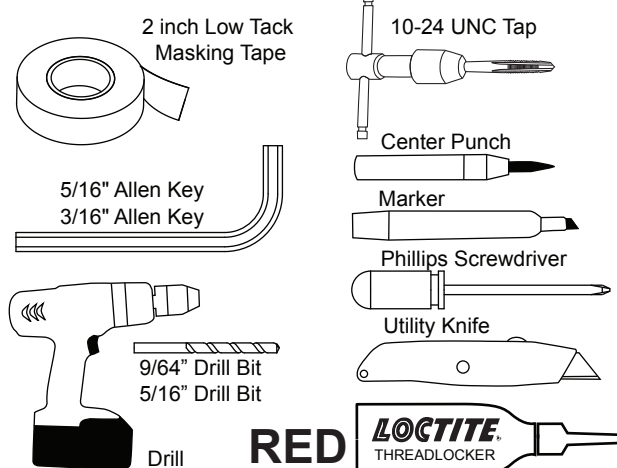

Towers and tower accessories require regular maintenance. Tower hardware and retaining bolts can become loose with normal operation; it is owner's responsibility to ensure all hardware is kept tight and secure. Corrosion and/or oxidation on coated surfaces as well as on all hardware are specifically excluded from warranty as their care, maintenance, and environments of use cannot be controlled by Roswell Wake Air. Damage due to misuse or improper care is also excluded from warranty. For full warranty details please contact your local dealer.

Roswell recommends 2 people for installation of the bimini.

Important

Read & follow these installation instructions carefully. Failure to do so may result in an improper bimini installation. Damage to parts due to improper bimini installation is not covered under warranty.

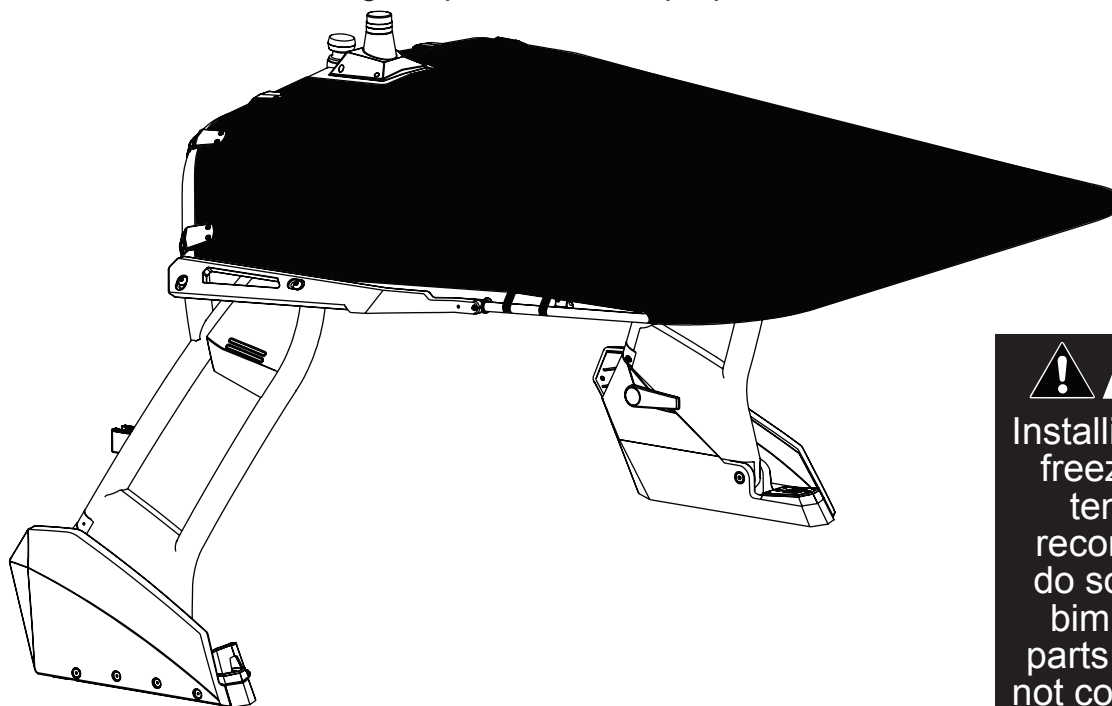

! Attention !

Installing your bimini clips in freezing or near freezing temperatures is **NOT** recommended. Failure to do so will result in broken bimini clips. Damage to parts from improper use is not covered under warranty.

www.roswellwakeair.com

Information: info@roswellwakeair.com

Warranty: warranty@roswellwakeair.com

If you have any questions please call : 1-855-962-WAKE(9253)



Rev. 15-Oct-15

Pg. 1/14

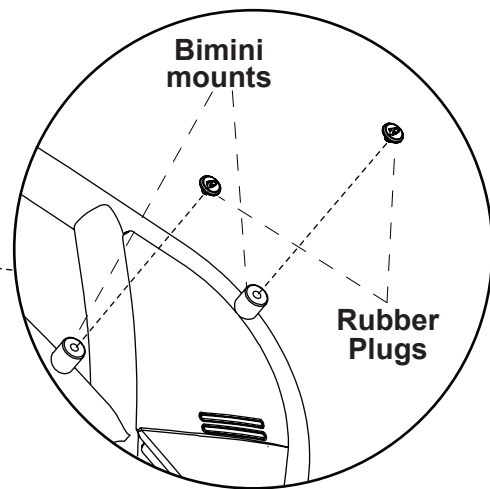
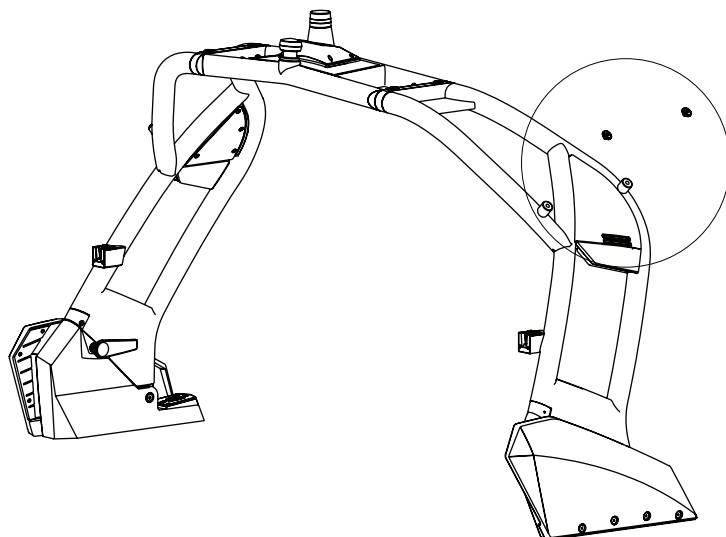
A**Preparing your tower**

Remove the 4 rubber plugs from the bimini mounts on your tower. These are press fit into the bimini mounts and do not require any tools to remove.

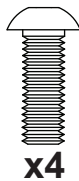
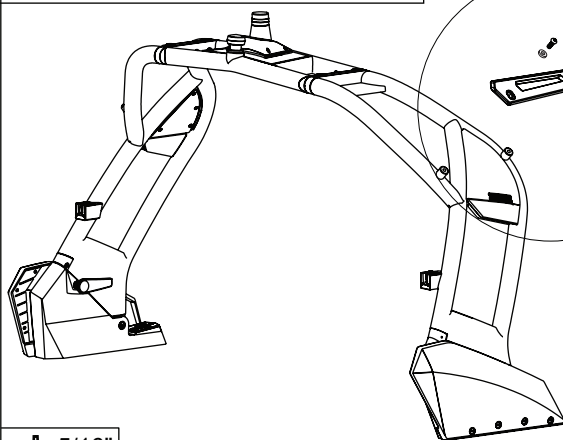
B**Installing Bimini Arms**

Remove the 2 bimini arms from your box. Carefully unwrap them. Assemble the bimini arms to the tower using the 4 bolts and 4 plastic washers. Apply red Loctite to all 4 bolts and assemble the arms as illustrated. Do not fully tighten down the arms yet, they need to be loose for the next installation step.

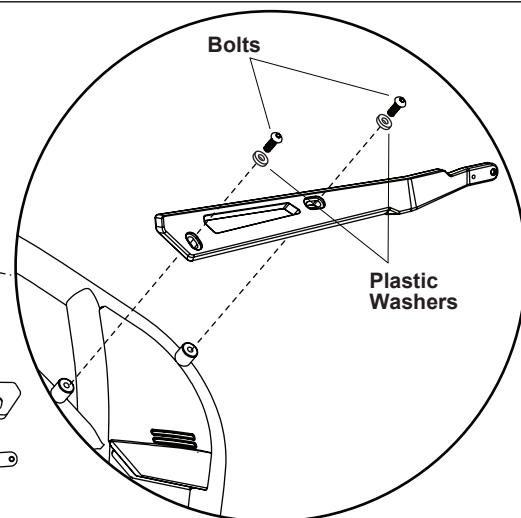
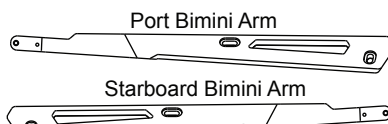
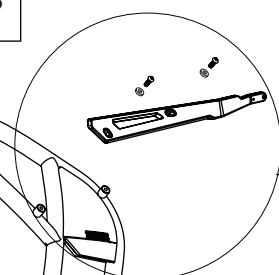
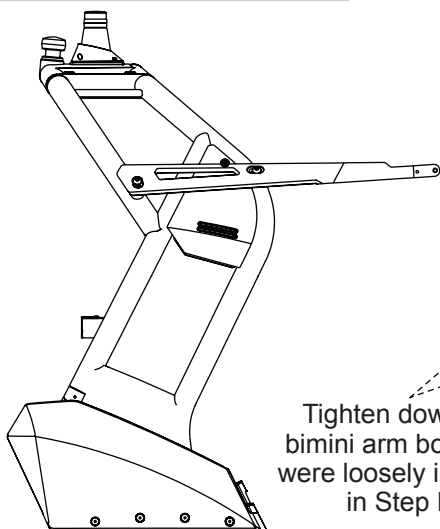
**C****Tighten Bimini Arm Bolts**

Tighten down the bimini arm bolts that were loosely installed in Step B.

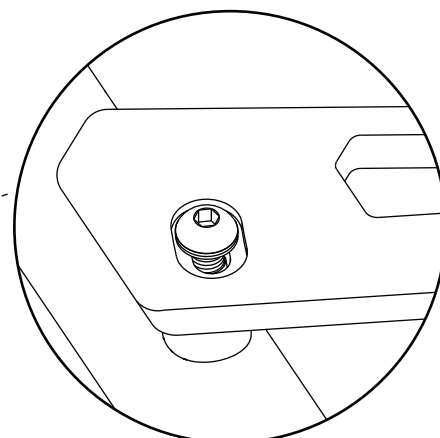
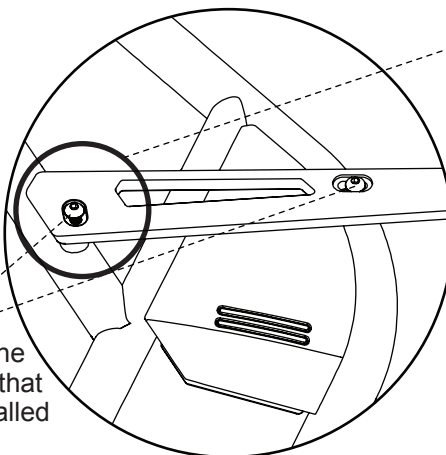

****IMPORTANT****

Tighten the Rear Bolts at the top of the slots as illustrated.



D Low tack masking tape

Apply a strip of 2 inch low tack masking tape along the entire rear tower tube from bimini arm to bimini arm. The strip should cover the portion of rear tube that faces the interior of the boat. This step is essential to avoid any accidental scratches to the tower paint.

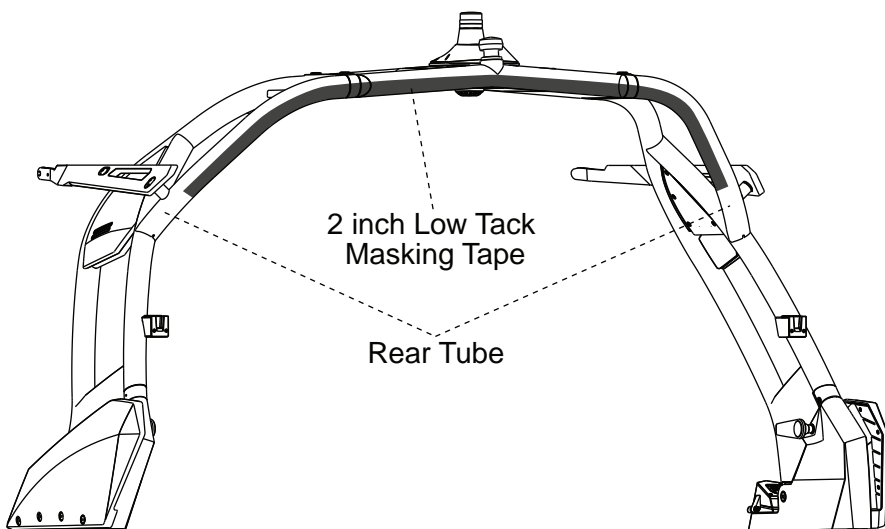
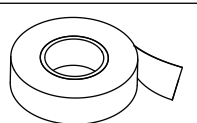

E Bimini Frame Assembly

****This step requires 2 people****

Remove the plastic wrapping from your bimini frame. Grab the 2 shoulder bolts, 2 pivot washers, and 2 shoulder bolt washers from your bimini box. Apply red Loctite to the 2 bolts. Attach the bimini frame to the bimini arms as illustrated. Make sure the pivot washers are sandwiched between the bimini arms and the bimini frame and that the shoulder bolt washers are under the heads of the shoulder bolts. Insert the folding quick release pins.



x2



x2



x2



****Refer to page 14 for Alignment Tip & Tricks****

*****To avoid installing the frame upside down make sure the middle bow bimini hinges are facing upward*****

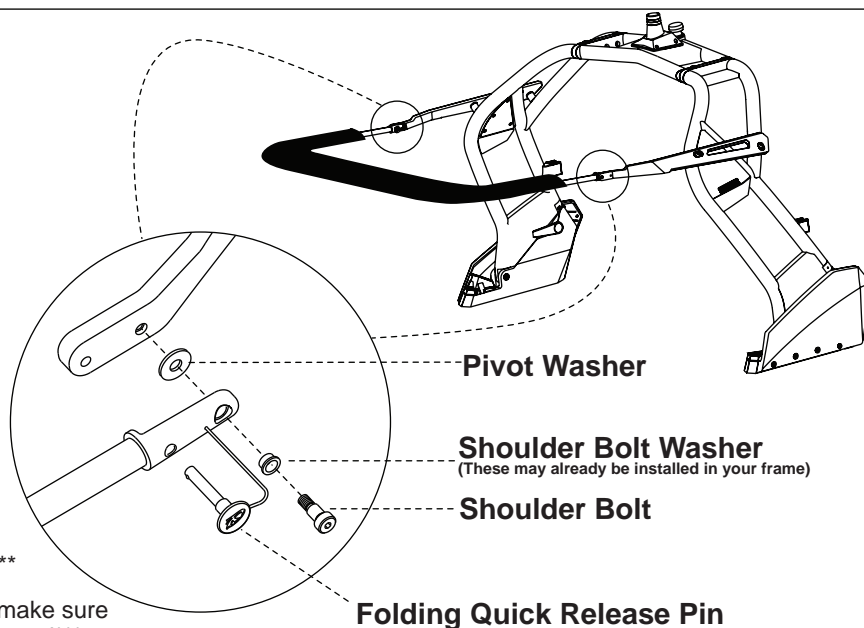

F Bimini Boot Removal

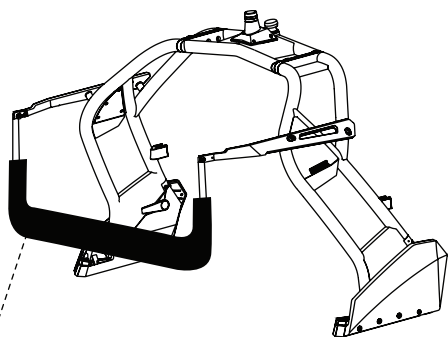

Bimini Boot

Unzip the bimini boot from the bimini frame. Unroll your fabric, clips and middle bow. Rotate the frame upwards and insert the quick release pins into the arms only. Clip all 6 clips onto the rear tower tube.

*****IMPORTANT*****

If you plan to clip/unclip the bimini clips, your bimini frame must be rotated upwards with the quick release pins in the ARMS ONLY.

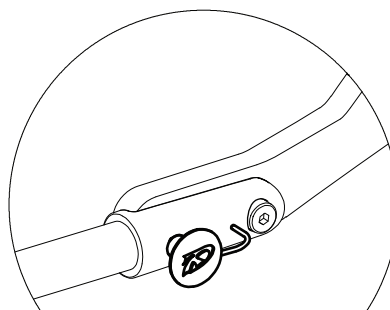

Position :
- Bimini is in use.
- For initial Installation of bimini clip hardware

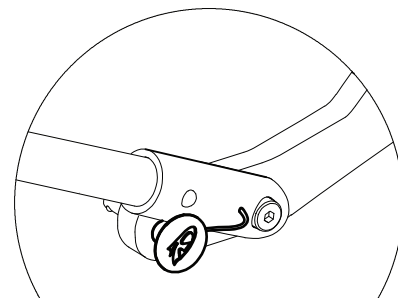

Position :
- For clipping or unclipping bimini clips



G Fabric-Clips Installation: Step 1

Snap the 6 bimini clips around the rear tube of the tower as illustrated. Adjust the bimini clip locations until they are symmetrical and the fabric is tight and wrinkle free.

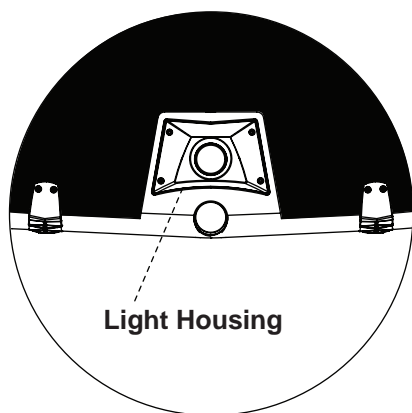

****IMPORTANT****

The position of the center Clips is the most important to begin with. Make sure that the clips are positioned along the rear tower tube so that the fabric is centered around the Light Housing.

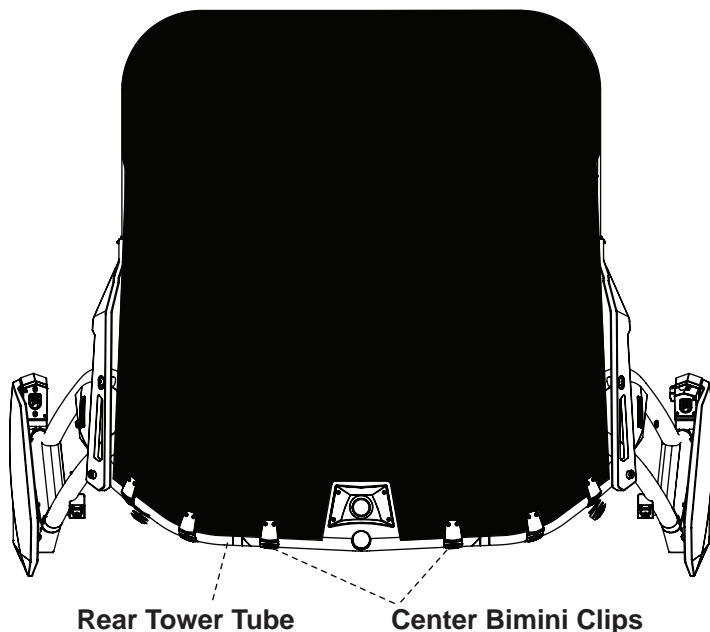

H Fabric-Clips Installation: Step 2

Prior to marking the center points for the 2 center clips in Step 1, it is important to pull/rotate the clips until the clip top surface is parallel to the top of the tower. With a good grasp on each clip, rotate them until the top is parallel then mark the center point with a black marker. Make sure your fabric stays centered around the light housing

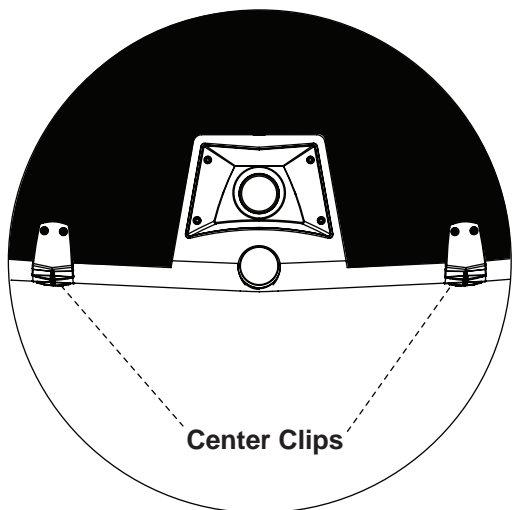

Start with the 2 center clips illustrated.

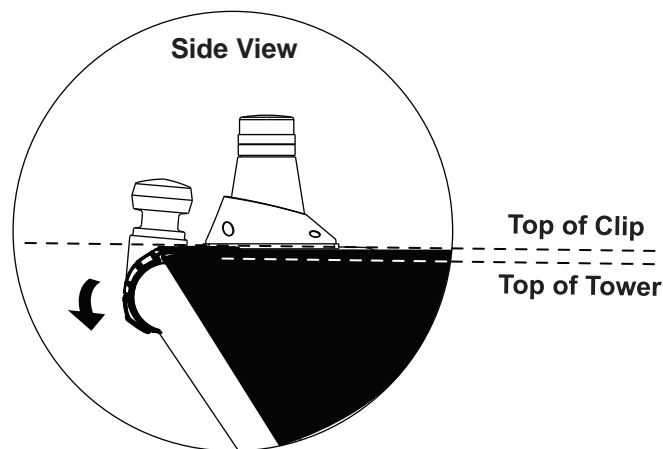

I Fabric-Clips Installation: Step 3

2 inch Low Tack Masking Tape

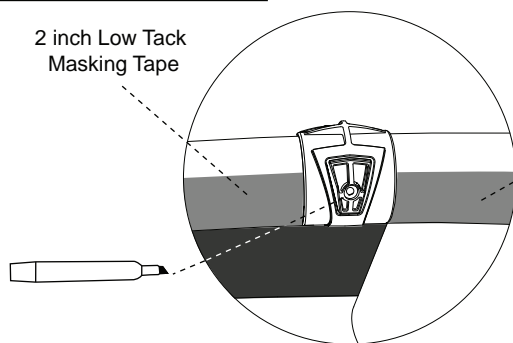

2 inch Low Tack Masking Tape

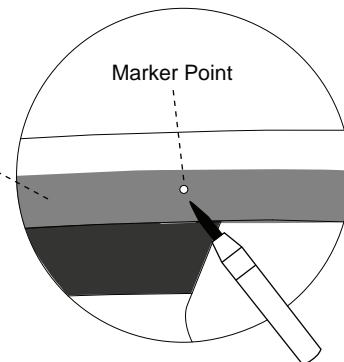

With the top surface of each clip parallel to the top of the tower, use a marker to mark the center mark for each bimini clip. Remove each center clip from the rear tower tube so they are out of the way of the center mark.

Center punch the 2 marker points on the masking tape.

J**Fabric-Clips Installation:
Step 4**

When drilling the holes for your bimini clip it is important to drill the holes perpendicular to the location of the hole to be drilled. This will allow for an optimal fit of the bimini clip.

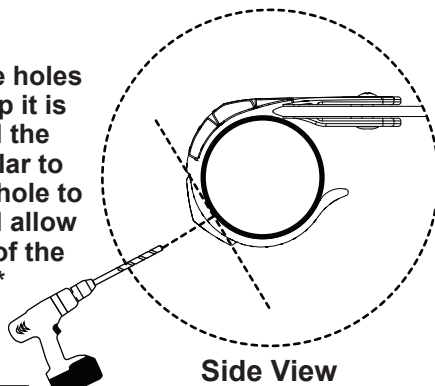
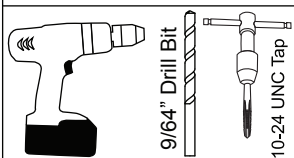
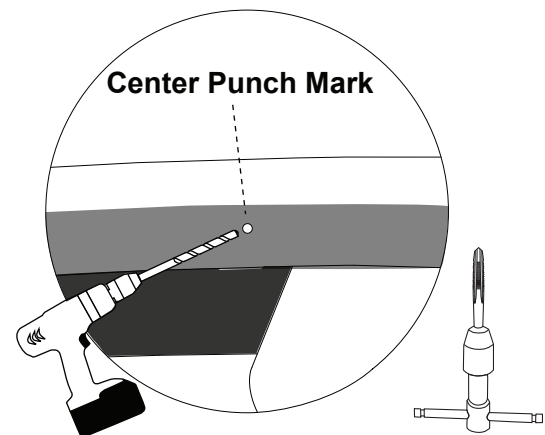
**Side View****9/64" Drill Bit****10-24 UNC Tap****Center Punch Mark**

Using a cordless drill and a 9/64" drill bit, drill holes through the tower where you made the 2 center punch marks. Using a tap and a 10-24 UNC bit, carefully tap each of the holes you just drilled.

K**Trimming the locator posts**

Clips are attached to the bimini Canvas. Bimini Canvas is not illustrated for image clarity

1: Push and break off the clip locator from the 2 center bimini clips.

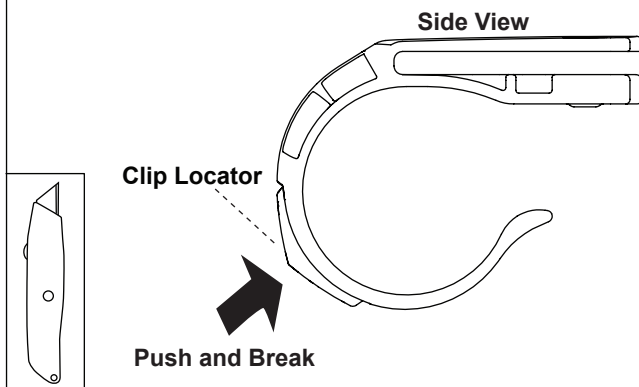
**Side View****Clip Locator****Push and Break**

2: Grab a sharp utility knife and carefully cut away the locator posts on each bimini clip and locator. There are 6 posts on each bimini clip and locator. When trimming the posts always cut away from yourself and the tower.

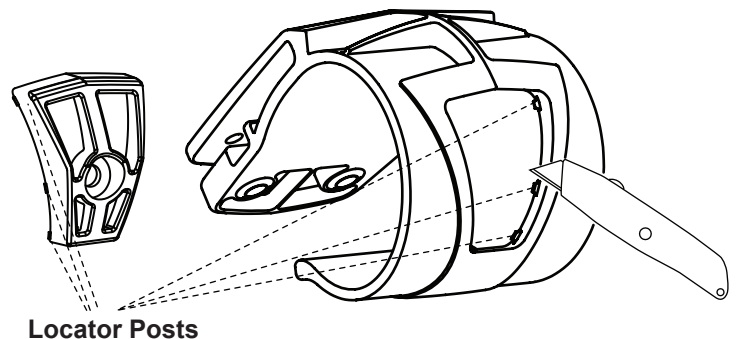
**Locator Posts****L****Fabric-Clips Installation:
Step 5**

Remove the masking around the 2 newly drilled holes only. Mount the 2 trimmed clip locators to the newly drilled and tapped holes with 2 of the provided bimini clip bolts from your bimini box. Apply a small amount of red Loctite to each bolt. Using a Phillips screwdriver, attach the bimini clip locators to the tower.

Do not overtighten these screws.

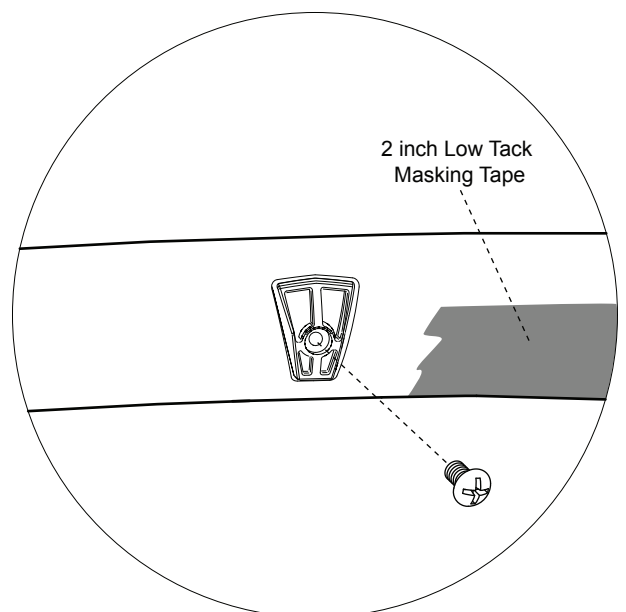
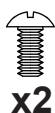
**2 inch Low Tack Masking Tape****x2****Phillips****LOCTITE**

M**Fabric-Clips Installation:
Step 6****Repeat Steps H, I, J, K & L for the 2
middle bimini clips illustrated**

Be sure to pull the middle bimini clips away from the newly installed center clips prior to marking their center points. Remember to rotate the middle clips until the clip top surface is parallel with the top of the tower.

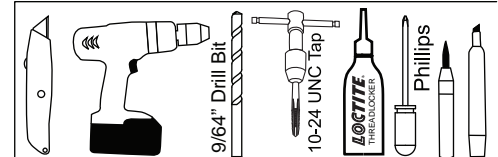
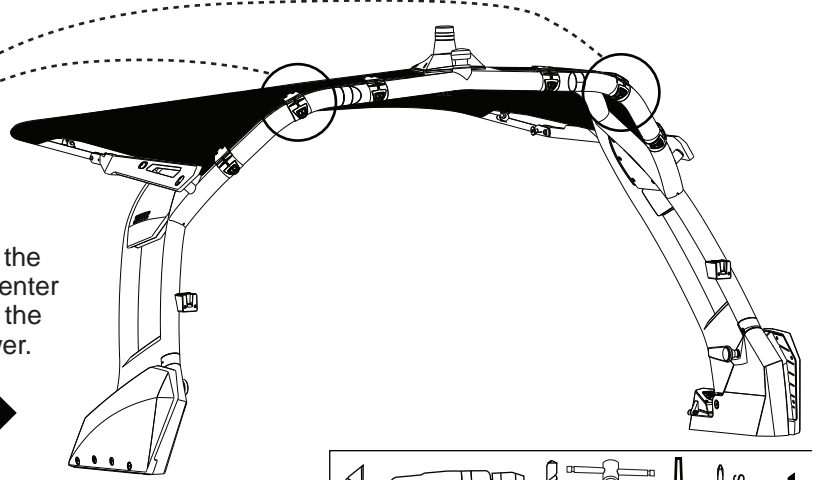
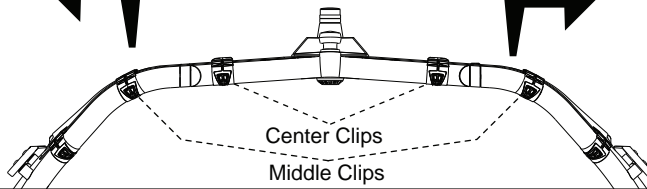
x2
**N****Fabric-Clips Installation:
Step 6****Repeat Steps H, I, J, K & L for the 2
outer bimini clips illustrated**

Be sure to pull the outer bimini clips away from the newly installed middle clips prior to marking the center points. Remember to rotate the outer clips until the clip top surface is parallel with the tower geometry.

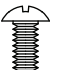
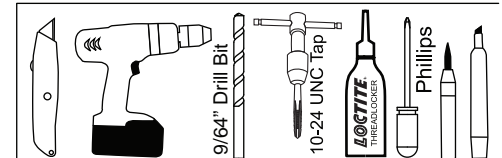
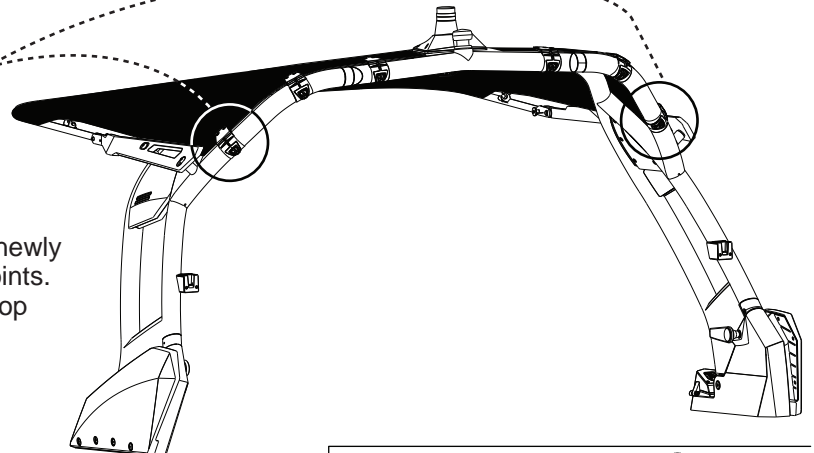
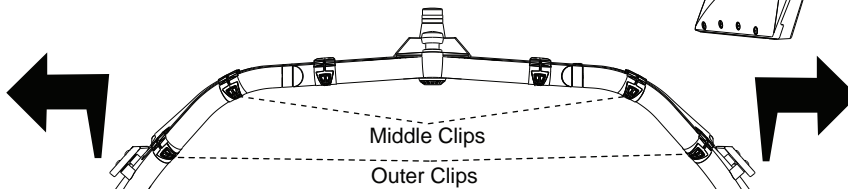

x2
**O****How your Bimini Clips
now look**

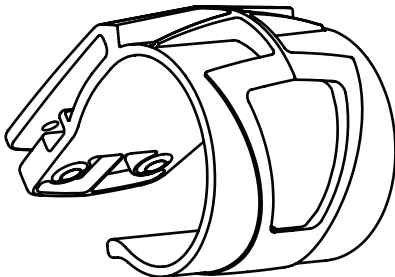
Clips are attached to the bimini Canvas. Bimini Canvas is not illustrated for image clarity

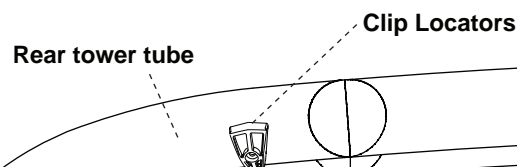

This is how your 6 bimini clips now look

This is how the locators will look on the tower.

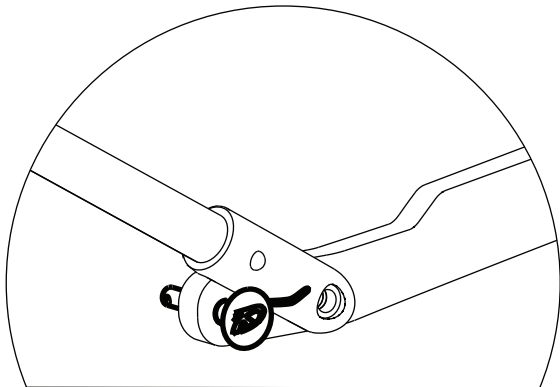

P**Re-Clip Bimini Clips**

1 : Remove the folding quick release pins. Rotate the frame upwards and insert the quick release pins into the bimini arm only. This will hold the frame in an up position and reduce tension on the bimini clips. This step is required to properly clip and unclip the bimini clips.

2 : Re-clip all of your bimini clips to the tower. Use the finger tab to flex the clips over the tubing.

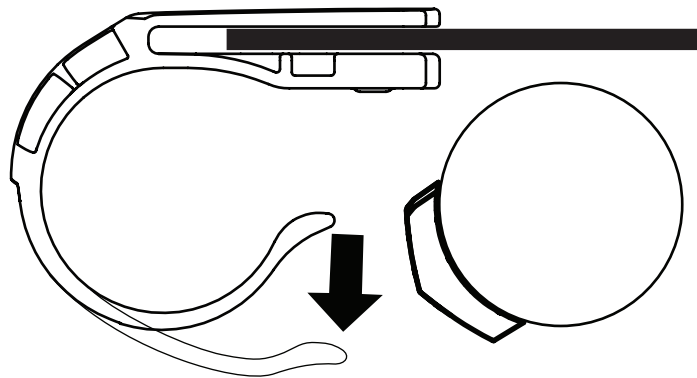

Do not apply excessive force when flexing the clips.

Q**Final Step**

Insert the 2 folding quick release pins through the frame and bimini arms to lock your bimini frame in place. Loop the 4 Bimini fabric loops around the frame and Velcro.

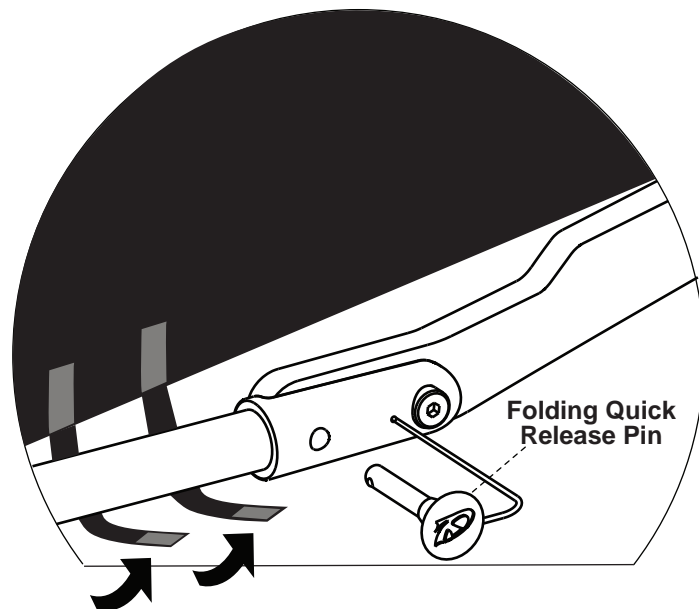
**R****Happy Boating!!**

Your bimini is now ready for use.

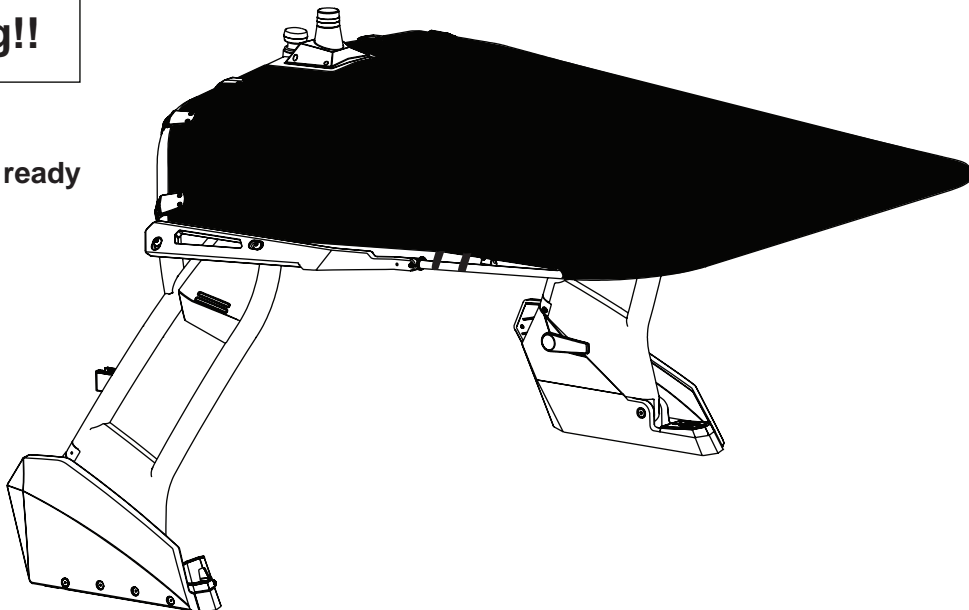

Important

Read & follow these instructions carefully. Failure to do so may result in damage to parts.
Damage to parts from improper use is not covered under warranty.

! Attention !

Using your bimini clips in freezing or near freezing temperatures is NOT recommended.
Failure to do so will result in broken bimini clips. Damage to parts from improper use is not covered under warranty.

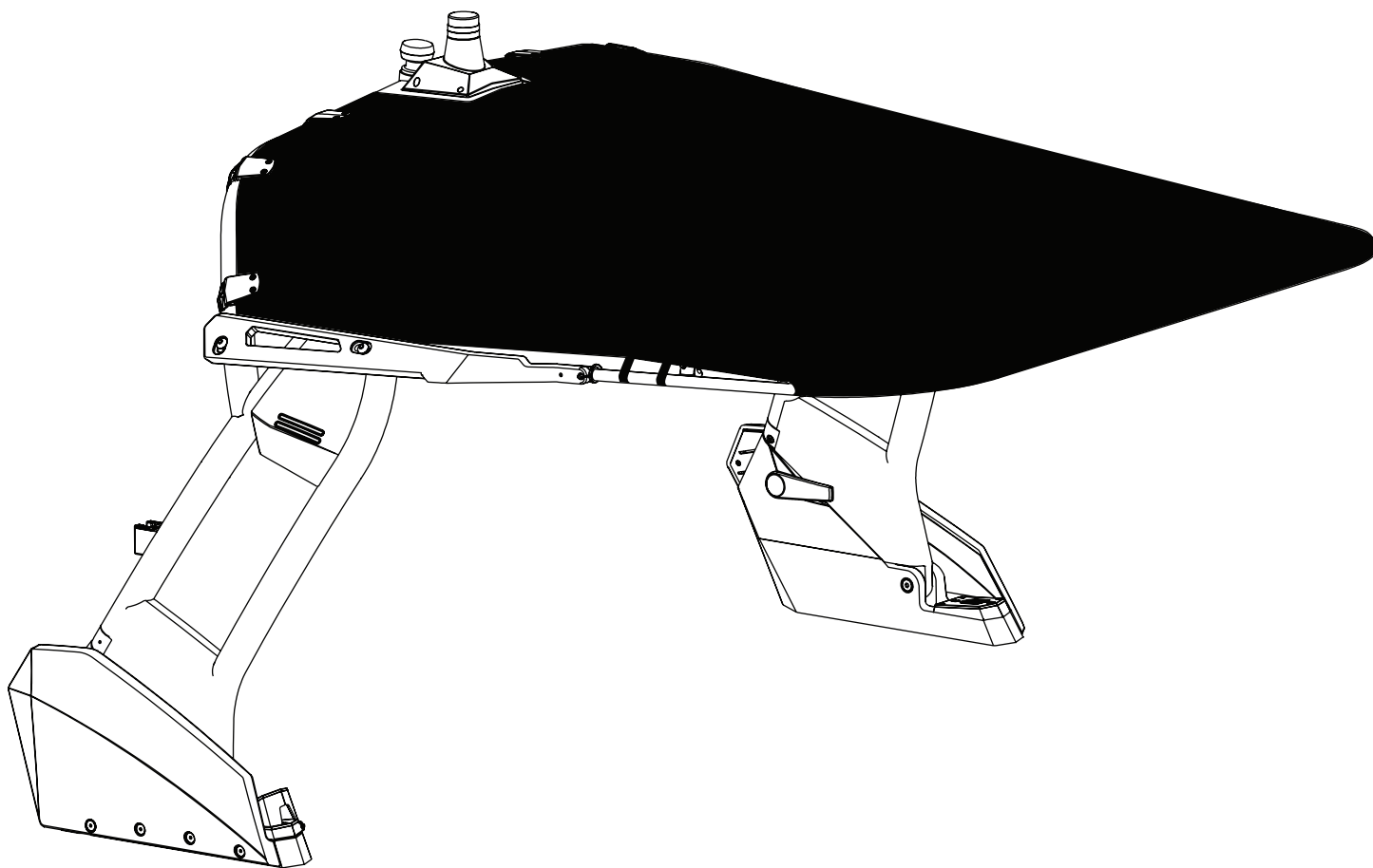

www.roswellwakeair.com

Information: info@roswellwakeair.com

Warranty: warranty@roswellwakeair.com

If you have any questions please call : 1-855-962-WAKE(9253)



A

Unfolding your Pro Edge Tower Bimini

1 : Undo the 2 straps that secure the bimini to your tower.

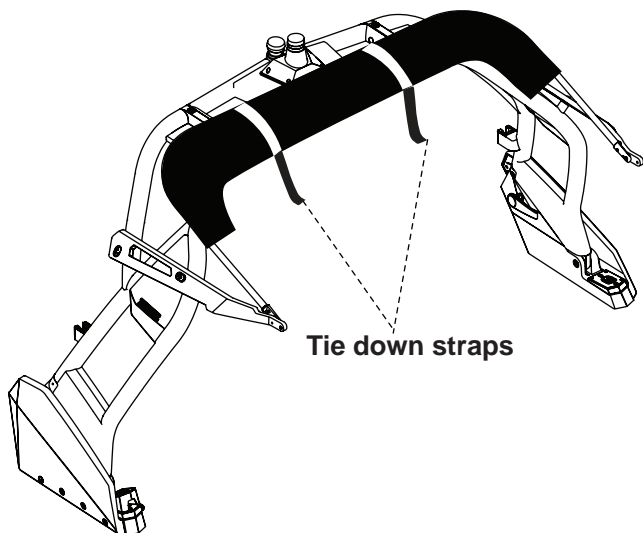

2 : Unfold the frame from the tower. Unzip the bimini boot from the bimini frame. Unroll your fabric, clips and middle bow.

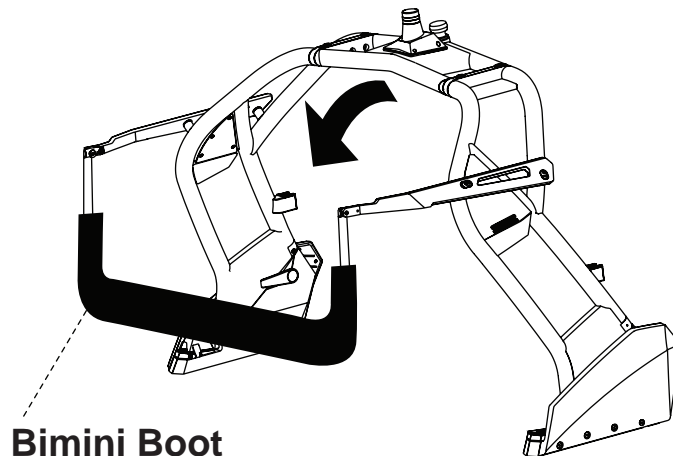

3 : Rotate the frame upwards and insert the quick release pins into the bimini arm only. Rotate the bimini frame down until it rests on the quick release pins as illustrated

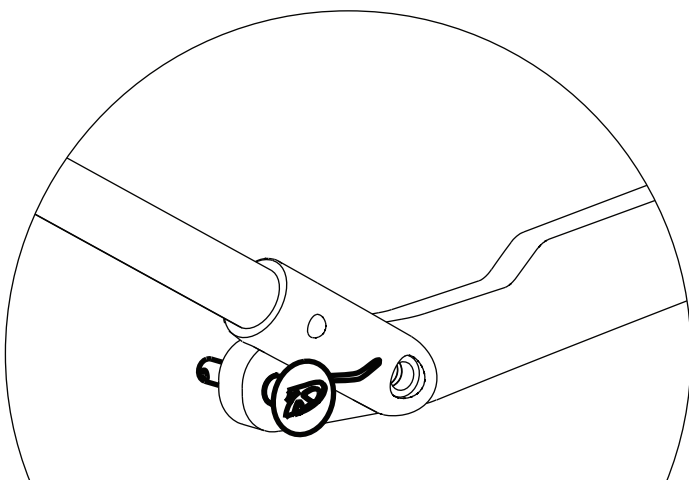

4 : Clip all of your bimini clips to the tower. Use the finger tab to flex the clips over the tubing.

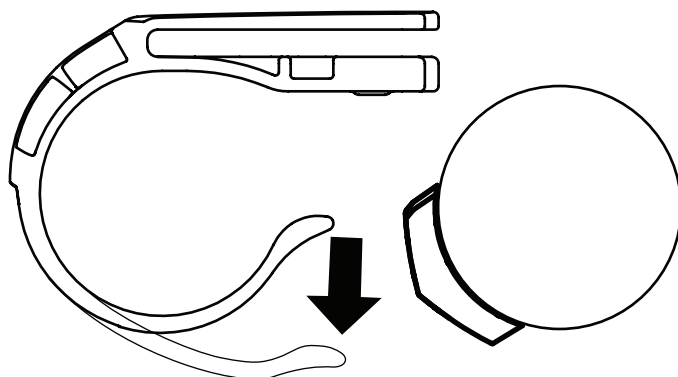

5 : Remove your 2 quick release pins from your bimini arms. Pull down lightly on the bimini frame and re-insert the quick release pins through the bimini frame and arms. Loop the 4 Bimini fabric loops around the frame and Velcro. Your Bimini is ready to use.

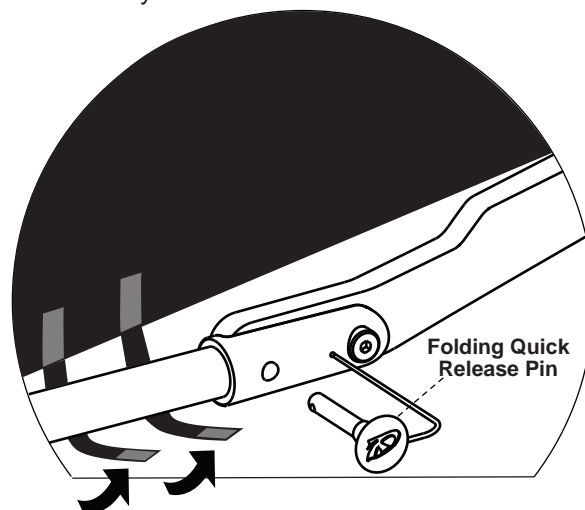
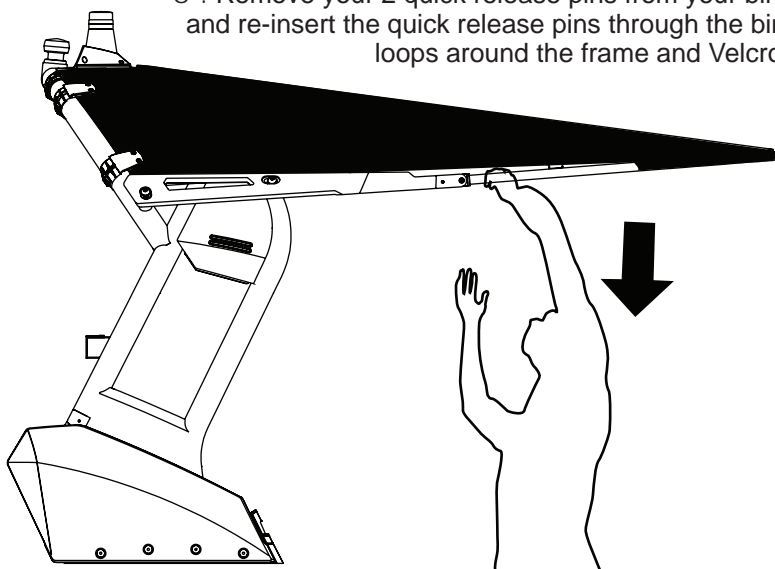

B

Folding up your Pro Edge Tower Bimini

1 : Remove your 2 folding quick release pins and undo the 4 Velcro loops.

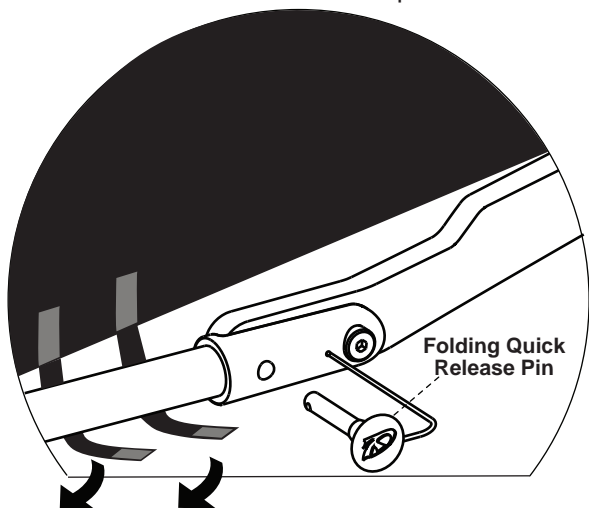

2 : Rotate the frame upwards and insert the quick release pins into the bimini arm only.

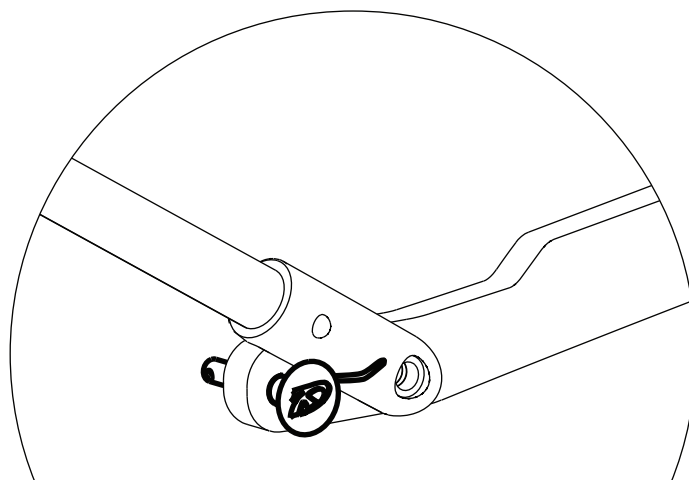

3 : Unclip all of your bimini clips from the rear tower tube.

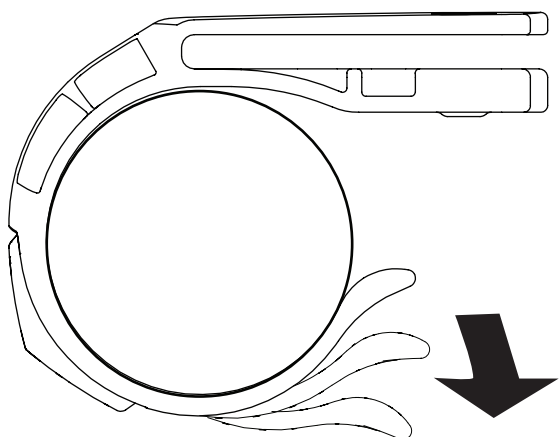

4 : Remove the quick release pins and lower the frame. Fold the middle bow toward the front bow and wrap the fabric and clips around both bows. Zip the bimini boot over the bows and fabric.

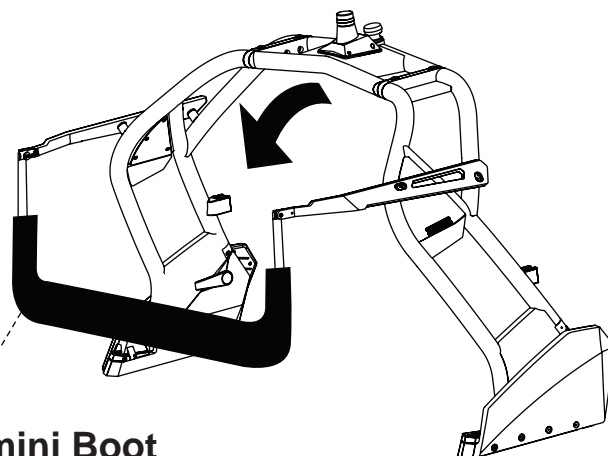

Bimini Boot

5 : Fold the bimini towards the tower until it rests on top of the tower.

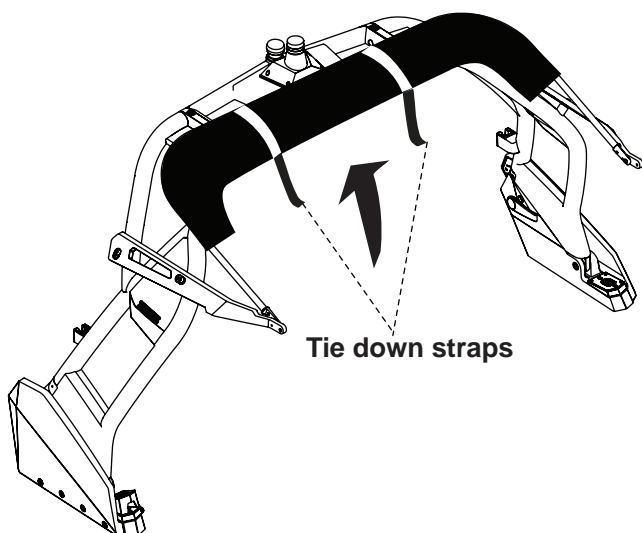

Tie down straps

6 : Loop the tie down straps over and under the front tower tube. Adjust the straps to tighten the bimini to the tower.

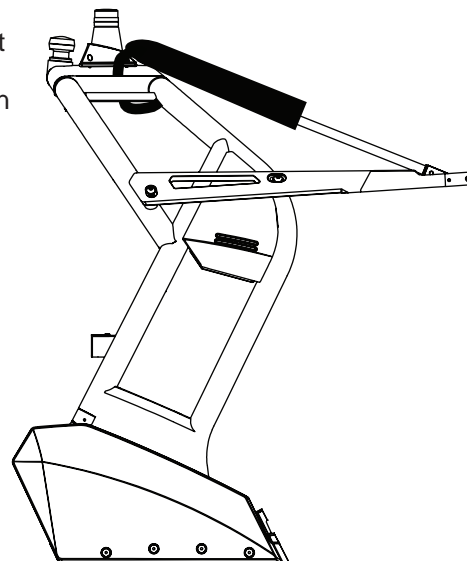

C

Tower folding / Trailing

Quick release pins must be inserted into the bimini arms for trailering to avoid damage to parts

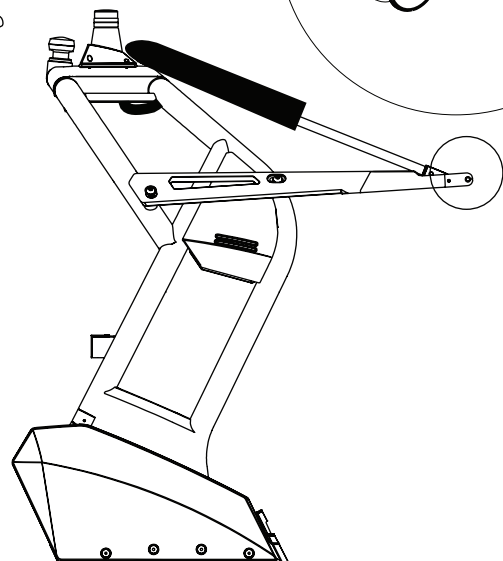
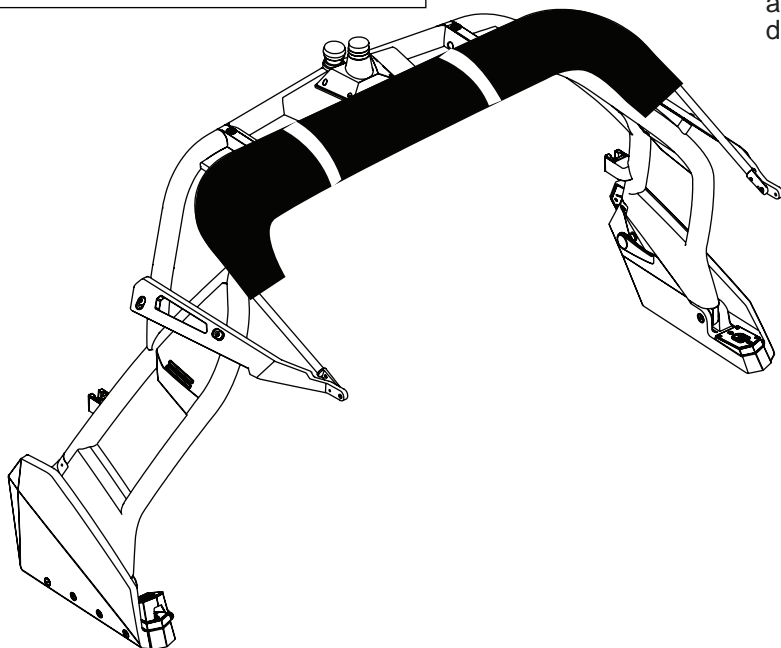

***** Illustrated is the ONLY acceptable way to safely fold your Pro Edge Tower or trailer your Supra boat with the bimini on*****

! ATTENTION !

DO NOT TRAILER YOUR BOAT WITH THE BIMINI IN ITS OUTSTRETCHED POSITION

DO NOT FOLD YOUR TOWER WITH THE BIMINI IN ITS OUTSTRETCHED POSITION

DO NOT USE YOUR BIMINI IN ITS OUTSTRETCHED POSITION IN ANY HIGH WIND CIRCUMSTANCES

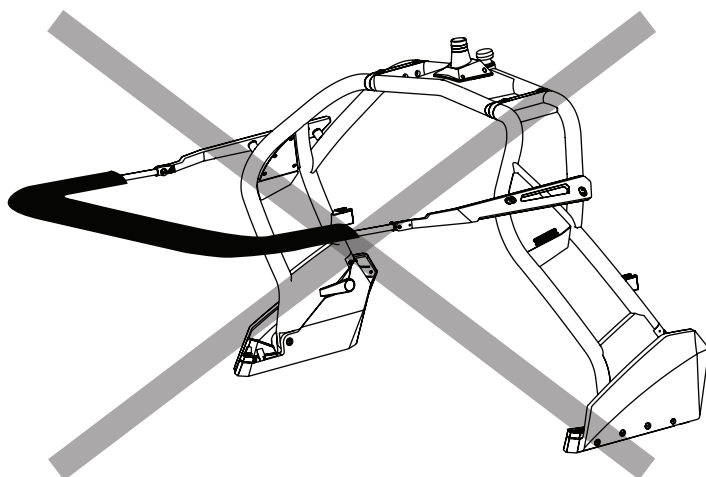

DO NOT FOLD THE TOWER OR TRAILER BOAT WITH BIMINI IN THIS POSITION

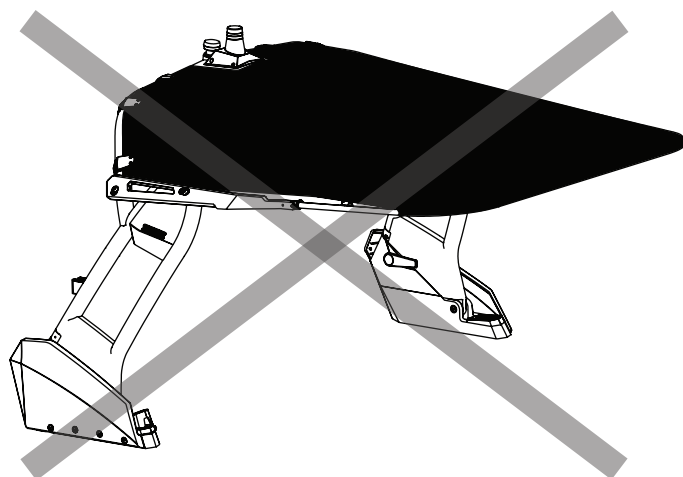

DO NOT FOLD THE TOWER OR TRAILER BOAT WITH BIMINI IN THIS POSITION



D Tightening your Pro Edge Tower Bimini Canvas

It is normal that your bimini canvas will stretch over time and use. Your Pro Edge Tower Bimini has been designed to allow you to tighten your canvas as needed.

There are 2 ways you can tighten your bimini canvas. You can use method 1, method 2 or a combination of both.

Canvas Tightening method 1

Your bimini clips are mounted to plates that are sewn to your bimini canvas. These plates have 5 sets of holes designed to allow you to move your bimini clip position to achieve a tighter canvas.

Your clips are factory installed in the middle position

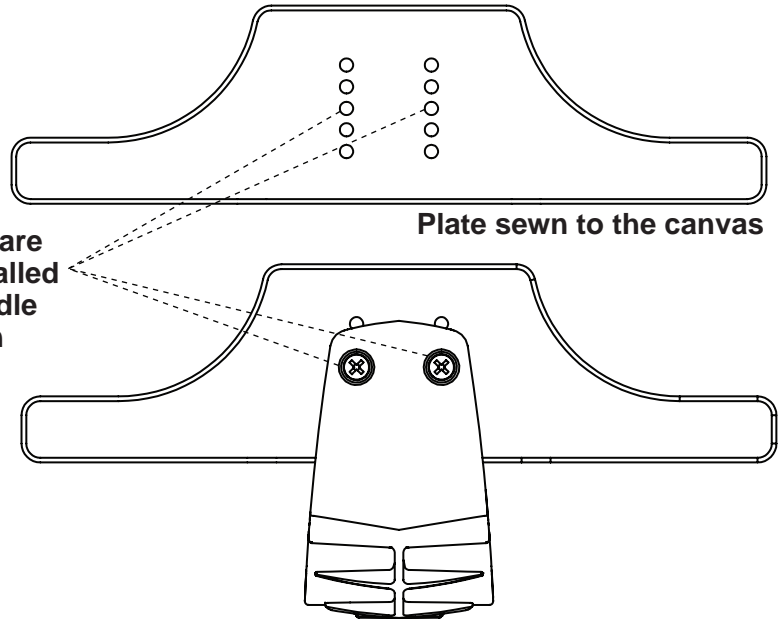

Clips are attached to the bimini Canvas. Bimini Canvas is not illustrated for image clarity

With a Phillips screwdriver, remove the 2 bolts that secure each bimini clip to the canvas. Slide each bimini clip over the new hole set that you would like to install them in.

It is recommended that the clips only be moved 1 hole position at a time.

Once the clip is lined up over the desired holes, re-secure the clips to the canvas using a Phillips screwdriver and the 2 bolts.

Do not overtighten these bolts

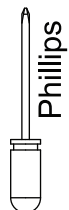
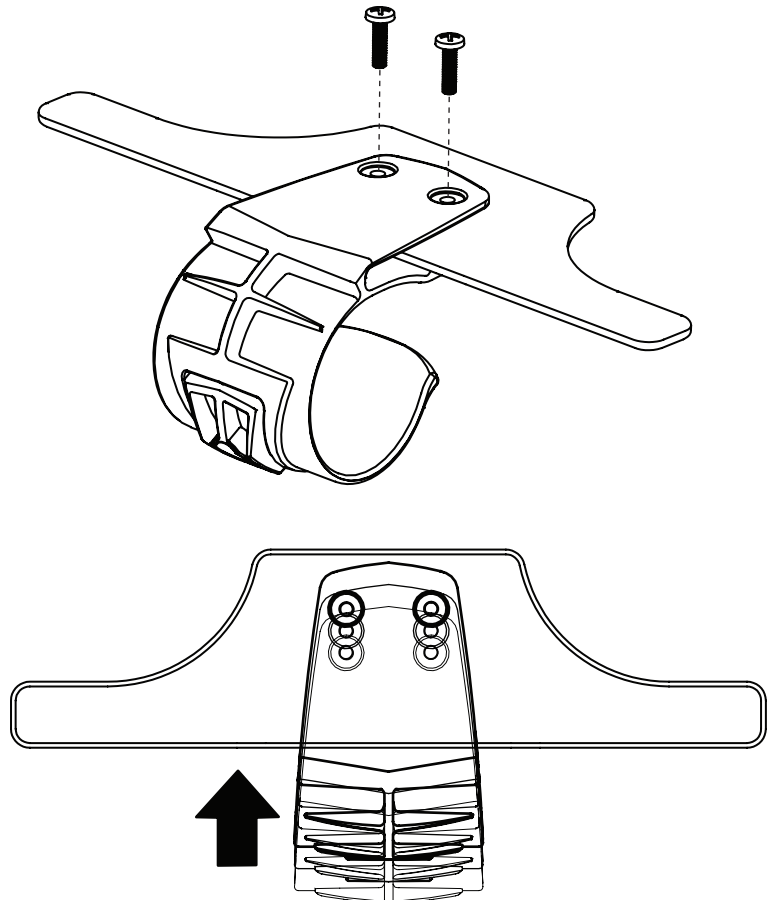

E Tightening your Pro Edge Tower Bimini Canvas

It is normal that your bimini canvas will stretch over time and use. Your Pro Edge Tower Bimini has been designed to allow you to tighten your canvas as needed.

There are 2 ways you can tighten your bimini canvas. You can use method 1, 2 or a combination of both.

Canvas Tightening method 2

This method is best executed with 2 people

Remove the rear bimini arm bolts on port and starboard sides. Do not remove the front bimini arm bolts. Once both rear bolts are removed, re-apply Loctite to each bolt and re-thread them loosely back into the tower. Have a friend lightly pull down on the bimini arms one side at a time. With the arm being pulled down, re-tighten the rear bimini arm bolt. Repeat on the other side.

Dealer installed
rear bolt
position

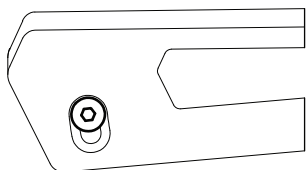

Tighter Canvas
rear bolt
position

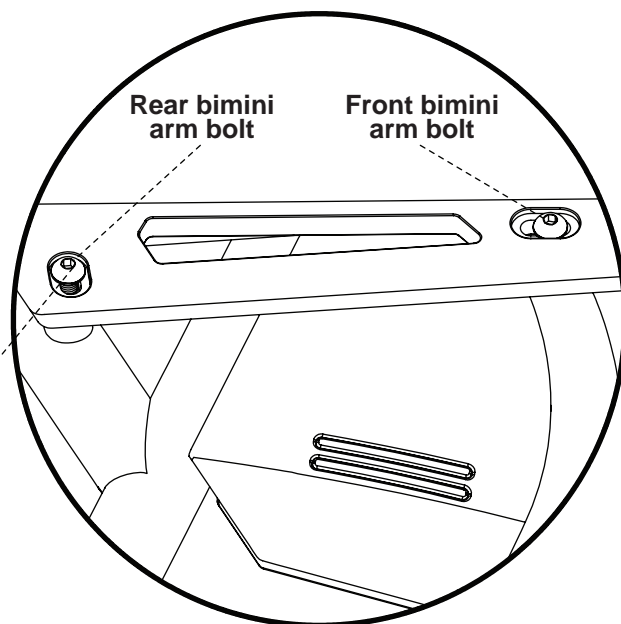
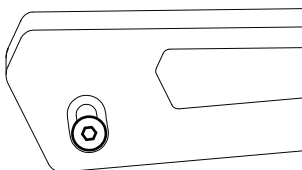

Remove
this bolt

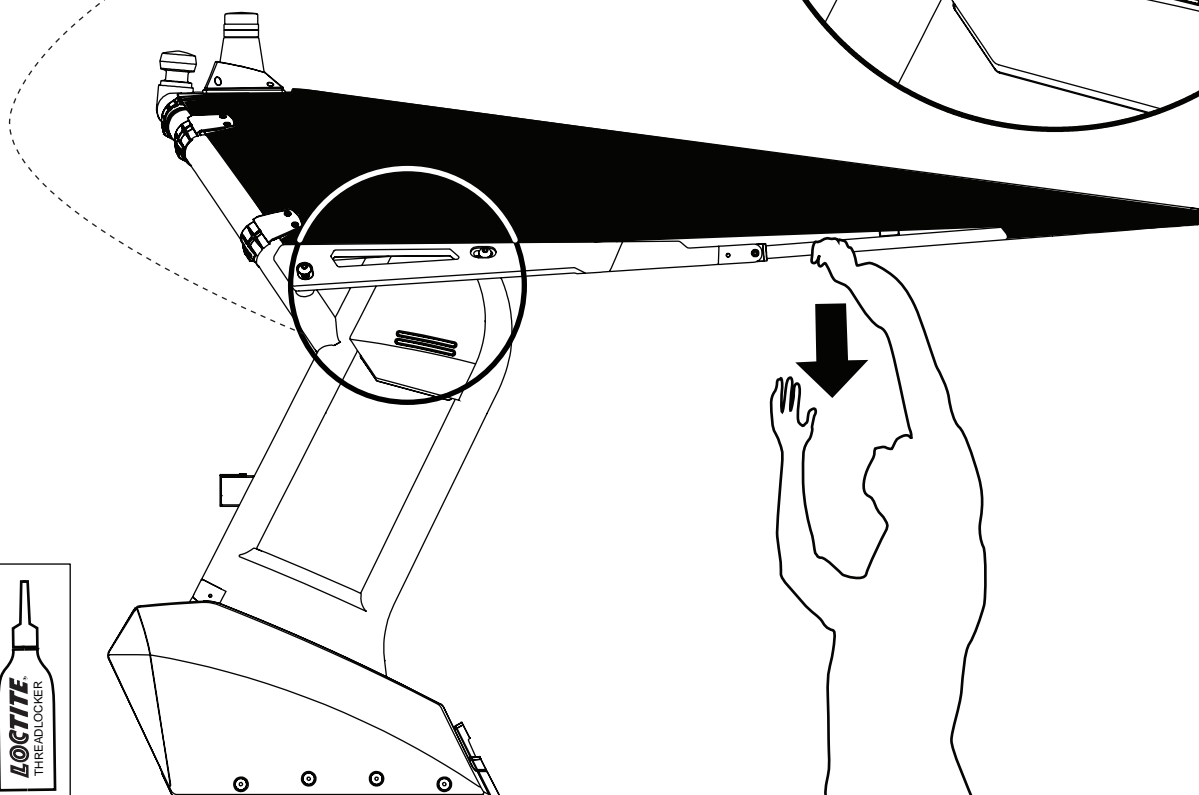

5/16"

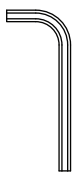

Tips and Tricks for your Bimini

It is normal that there is potentially a slight variation from one tower bimini to another. Listed below are some tips and tricks to ensure that your bimini is installed and functioning properly. This process is not mandatory for all biminis.

1 : It is possible that once your bimini is installed your frame and arms are not parallel where they pivot. This could make inserting and removing your quick release pins difficult.

If you are not experiencing any issues, skip this page.

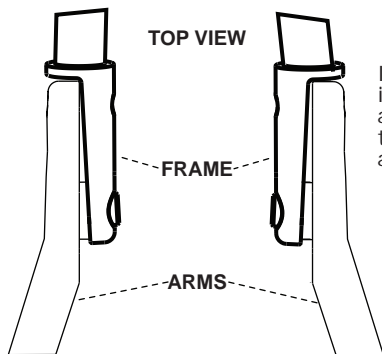

If your bimini looks like this, in Step 2 you will need to add shim washers between the forward bimini mounts and your bimini arms

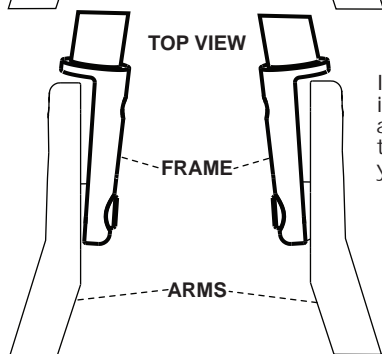

If your bimini looks like this, in Step 2 you will need to add shim washers between the rear bimini mounts and your bimini arms

2 : Choose one side of your tower to work on first. Determine which bimini mount the shim washers will need to be added to. Completely remove the bolt that secures the bimini arm to your chosen bimini mount. Loosen the other bimini arm bolt. Add the shim washer(s) in between the chosen bimini mount and bimini arm. (In some cases 2 washers may be required under each arm) Re-insert the bolt with loctite applied. Remove the loosened bolt, apply Loctite and re-insert. Tighten down the front and rear bimini arm bolts in the same position they were in prior to loosening them. Repeat on the other side of your tower.

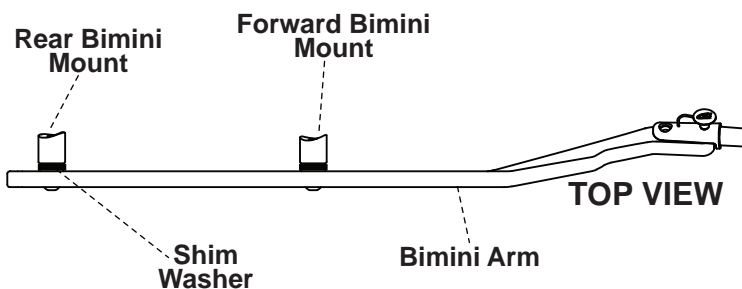

3 : Now that your shim washers have been added your frame and arms should be parallel or much closer. Test removing and inserting your quick release pins. If it is still difficult to remove or insert the pins proceed to the next step.

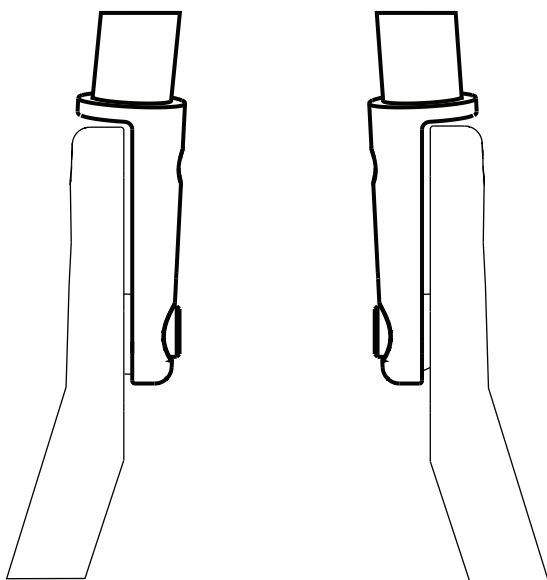

4 : If your quick release pins are still difficult to remove and insert with the addition of the arm shim washers, Roswell recommends using a drill with a 5/16" drill bit to clean out the holes. Drill through the frame and bimini arms at the same time. This will help with the alignment and ensure an accurately aligned hole.

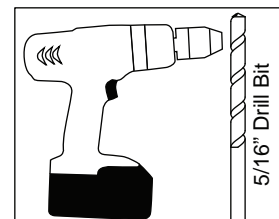
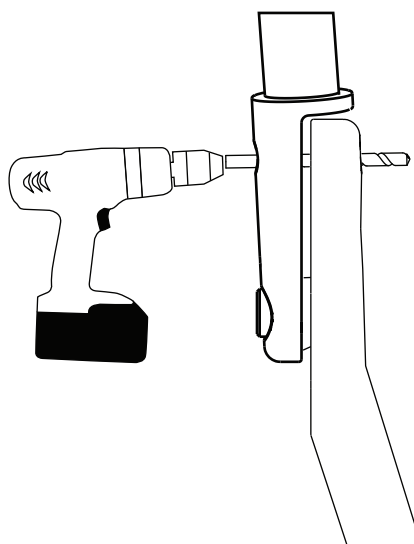

www.roswellwakeair.com

Information: info@roswellwakeair.com
Warranty: warranty@roswellwakeair.com

If you have any questions please call : 1-855-962-WAKE(9253)

