

Speaker Hardware

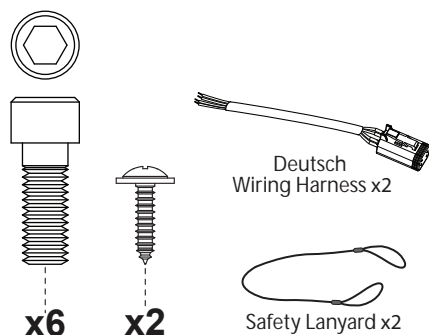

Tools Required

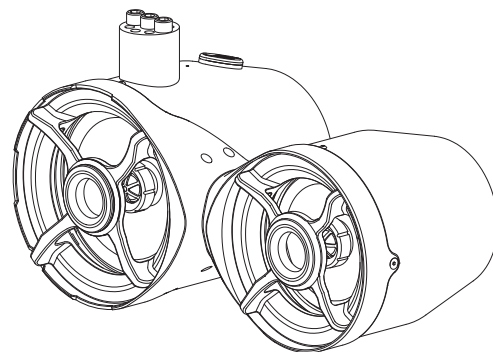
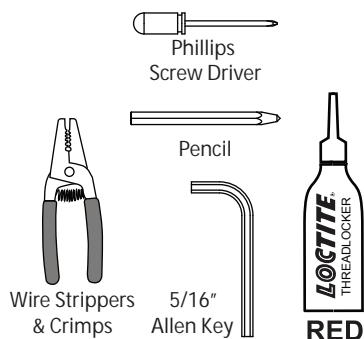

NOTES

BEFORE WIRING ANYTHING PLEASE MAKE SURE YOUR BOAT, DECK, AND AMP ARE ALL TURNED OFF

A

- You will need to connect the included 20" Deutsch wiring harnesses to your tower wires according to the chart in **STEP B**. Please note the Black and Blue wires of the wiring harnesses are not used in this installation

B

Wiring Diagram

	<u>Speaker Wire</u>	<u>Tower Wire</u>	<u>Function</u>
Port	White	Green	Port Speaker +
	White/Black	Green & Black	Port Speaker -
	<u>Speaker Wire</u>	<u>Tower Wire</u>	<u>Function</u>
Starboard	White	Purple	Stbd Speaker +
	White/Black	Purple & Black	Stbd Speaker -

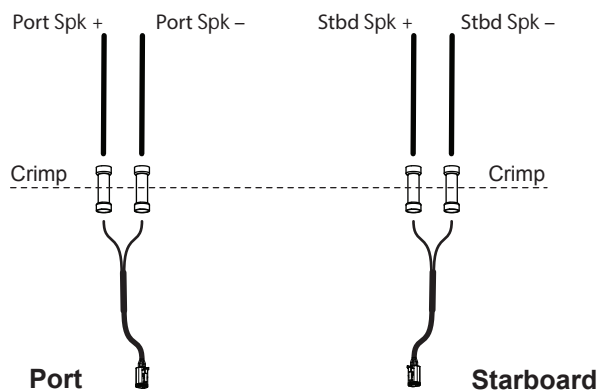

B Apply RED Loctite to 3 bolts and fasten speaker through tower speaker plate using a 5/16" allen key.

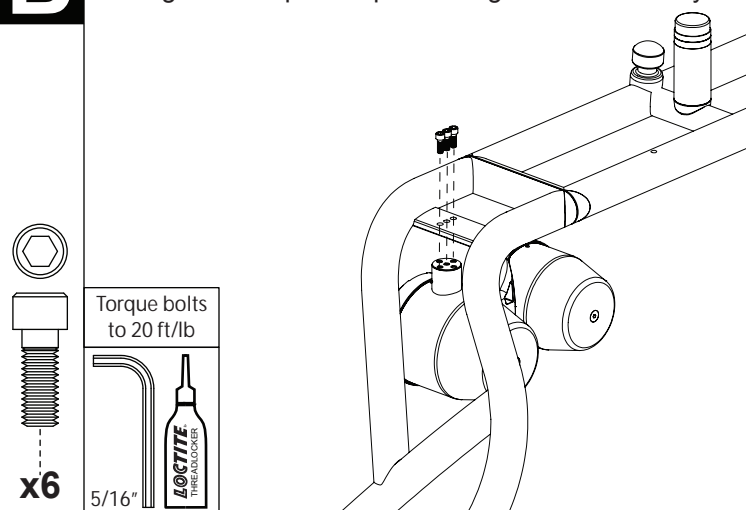

C With your stereo/amp switched off, insert the Deutsch wiring harness into speaker.

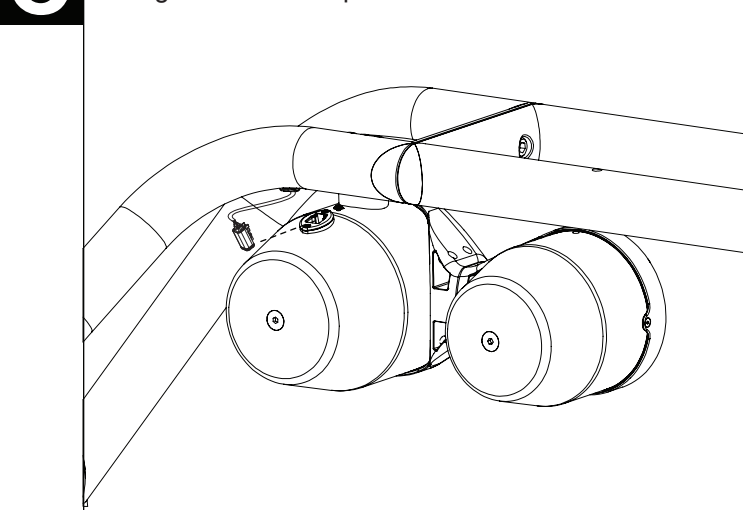

D Loop the safety lanyard over the tower next to the speaker clamp.

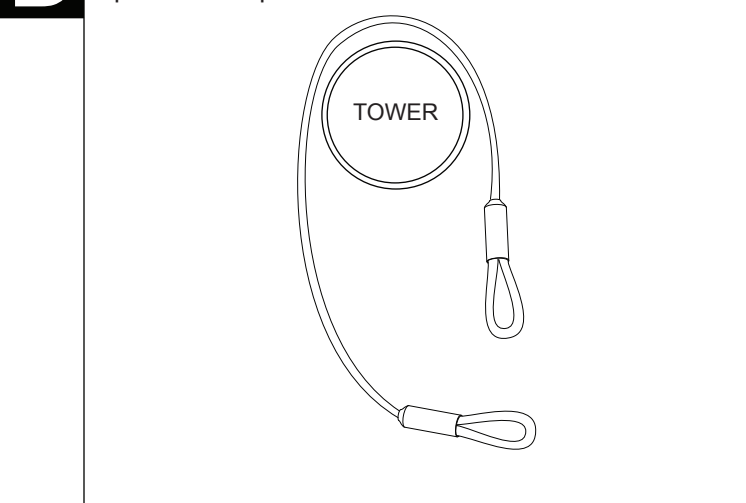

E Feed one end of the lanyard through the other end.

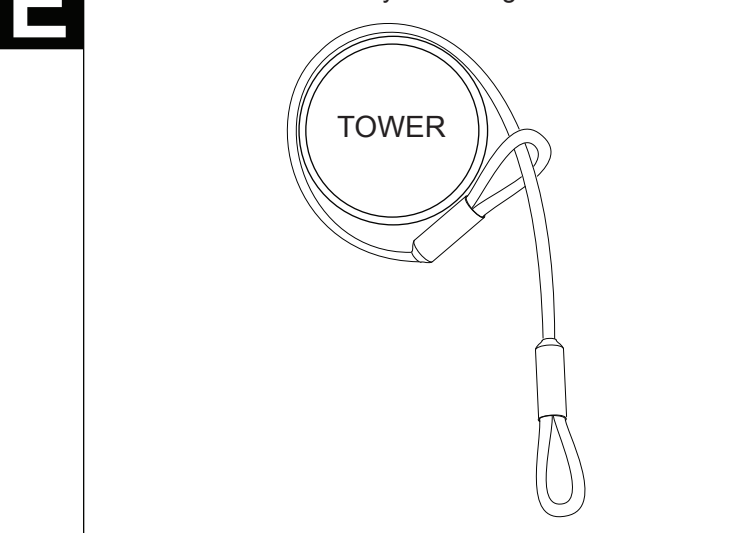

F Insert the screw through the washer and lanyard loop.

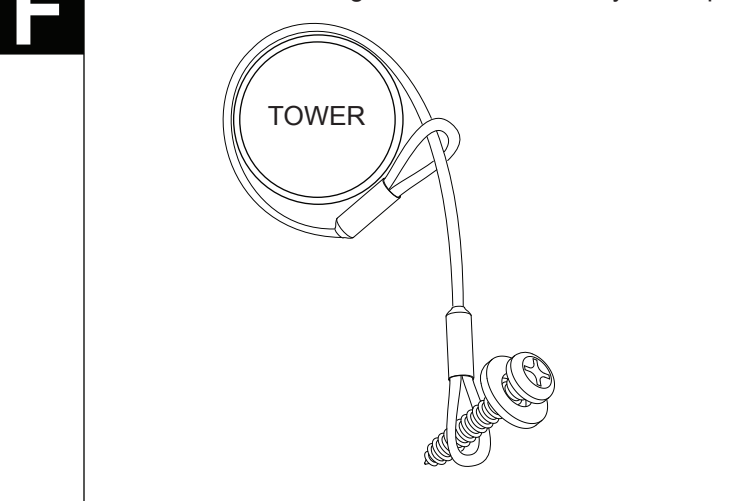

G Using a Phillips head screwdriver, securely attach the lanyard to the small hole on the speaker between the base of the clamp and the Deutsch connector.. Do not over tighten.

