

### Light Bar Hardware

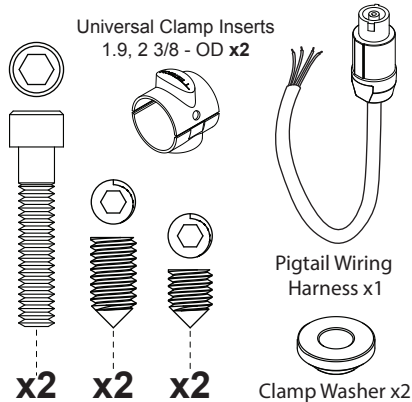

### Tools Required

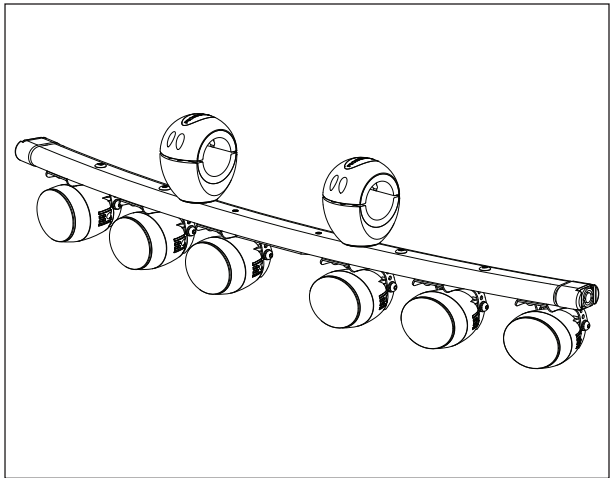
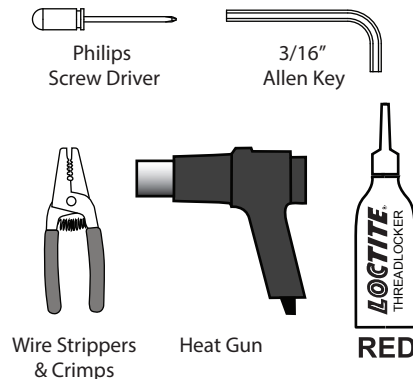

### NOTES

If you purchased our Master Wiring Harness you will only need to provide wire and a fuse for the interior boat wiring. You will need wire for both the lights and the LED interior light – enough length to run from the rear of the starboard mount to your desired power source or switch (depending on your install).

We recommend a minimum 16 to 14 gauge wire for powering both the lights and the interior LED. You must mount an inline fuse between your battery and the switch. The inline fuse is designed to protect your wires connecting your light bar. Each light on the light bar draws 0.25 amps of current, thus the C4 Light Bar draws 1.5 amps. We recommend using a 5 amp fuse, however 2 to 15 amps is an acceptable range.

### MOUNTING OPTIONS

Your new Elite Light Bar can be mounted anywhere on your tower – it has been designed to have the interior LED facing down but can be mounted to face upward. The lights will rotate to face either direction so it's up to you to choose a suitable mounting location.

Both ends of the light bar are equipped with a speakon connector, however only one end needs to be plugged in. This allows you to mount the light bar above or below the top section of the tower.

## A

The Elite C6 Light Bar is equipped with a blue LED lens cover and includes red and clear lenses. If you wish to change the LED lens to a different colour you can do so before installation, otherwise jump to **STEP E**.

Carefully remove the two centre screws from the top of the light bar.

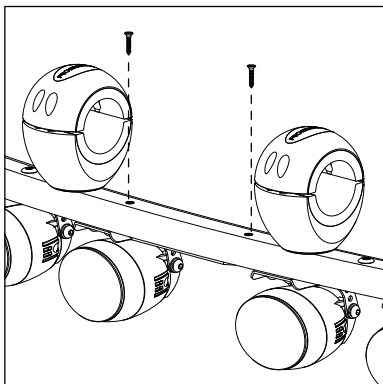

## B

Carefully pull the LED assembly down and out of the bar. With the LED plate and lens out of the bar, remove the two remaining screws attaching the LED plate and lens.

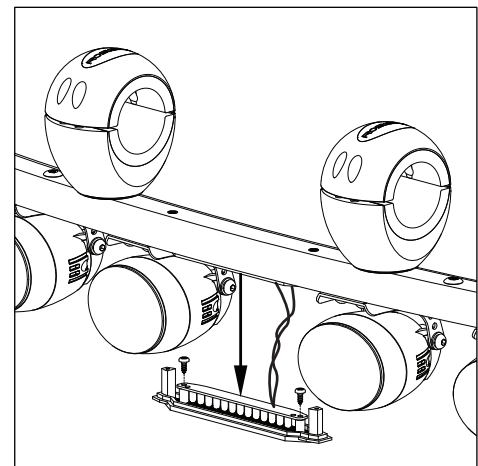

**C** Align the new LED lens and tighten the two screws. Replace the assembly in the bar and align the top two screws.

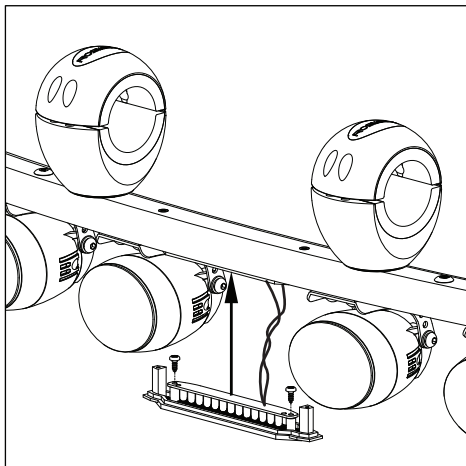

**D** Tighten the top two LED screws and you're ready for the rest of the install (BE CAREFUL NOT TO PINCH ANY WIRES).

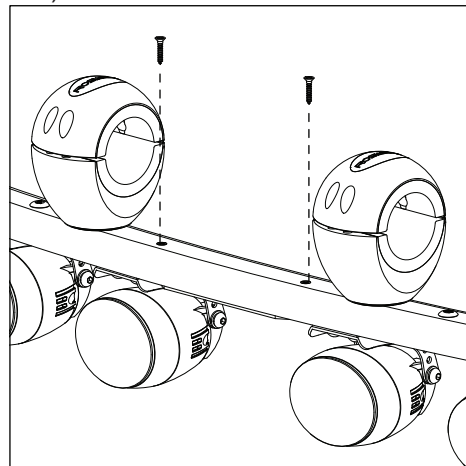

### **E** Light Bar Wiring Harness

#### Wire Colour

Red  
Black  
Yellow  
Blue

#### Function

Directional Lights +  
Directional Lights -  
Interior LED +  
Interior LED -

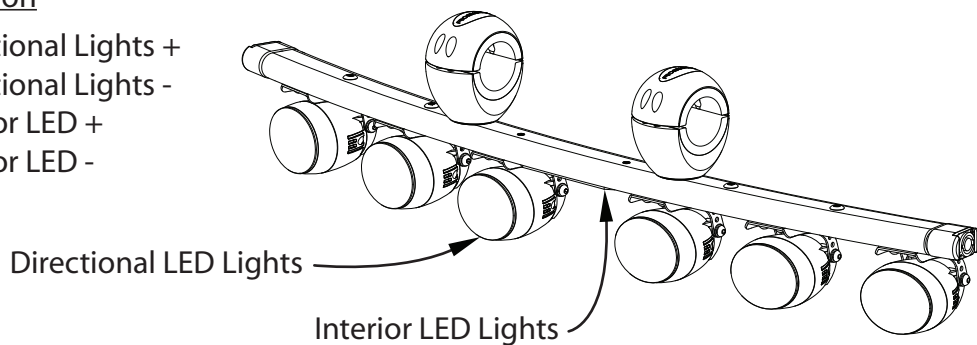

**F** Unfasten the two 1/4" bolts holding the clamp together and pull back the top half of the clamp.

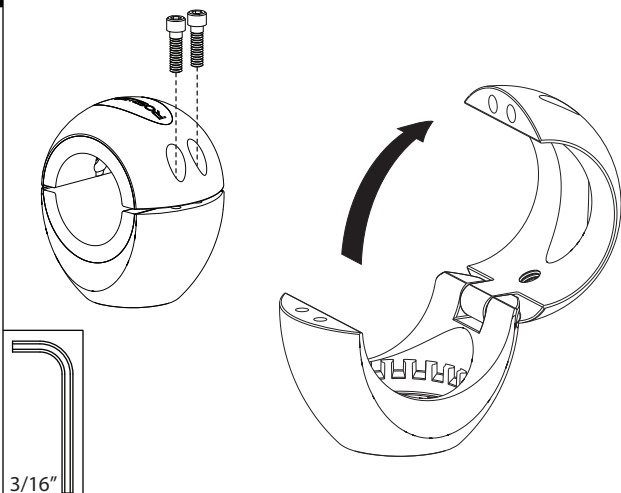

**G** Remove the bottom clamp insert. Place the clamp washers over the two outer holes, then insert the long 1/4" bolt through the washer, fastening the clamp to light bar. RED LOCTITE must be used. Repeat for second clamp.

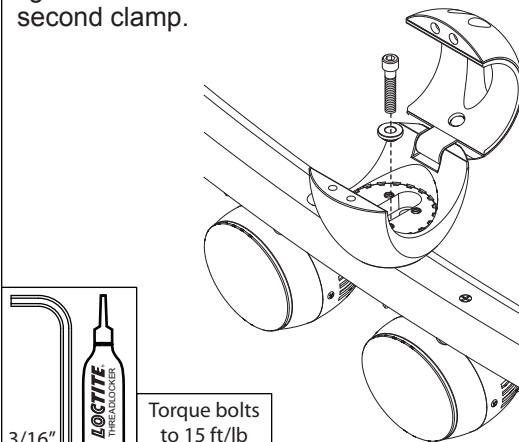
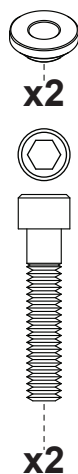

Torque bolts  
to 15 ft/lb

**H** Select the appropriate clamp inserts\* for your tower, for the 2 3/8" clamp inserts use the shorter set screws.

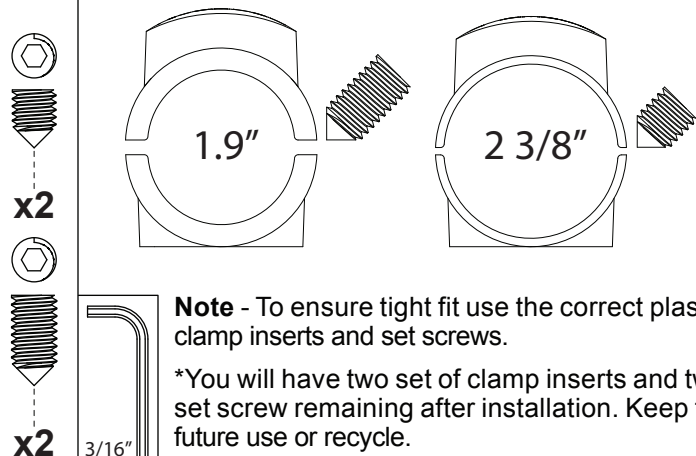

**Note** - To ensure tight fit use the correct plastic clamp inserts and set screws.

\*You will have two set of clamp inserts and two set screw remaining after installation. Keep for future use or recycle.

**I** Hold the bar in the position you would like (see recommendations for mounting options at the beginning of these instructions).

If the light bar does not fit where you would like due to cross members or bars, you will be able to get around this with the multiple mounting positions.

Remove the rubber plugs from the extra holes and attach clamp to new position following **STEP G**.

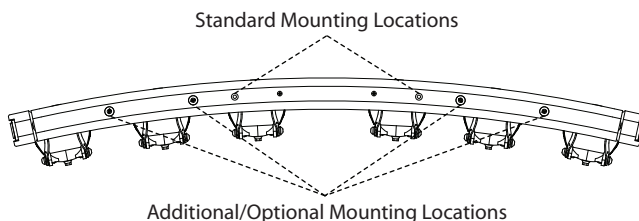

**J** Align the top half of the clamp around the tower and re-insert the 1/4" bolts tightening each one evenly, be careful not to strip the threads. RED LOCTITE must be used on all 4 bolts and both set screws.

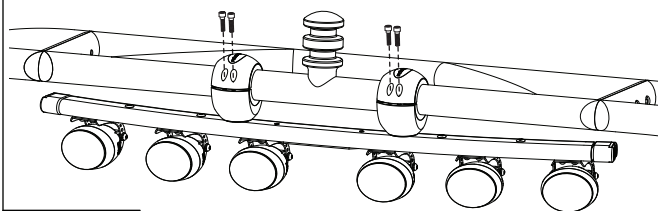

Torque bolts  
to 15 ft/lb



Once the light bar is secured to your tower, insert the appropriate set screw on the back of the clamp. This tightens the light bar to the tower and prevents it from rotating and moving around.

**K** With your boat and all switches turned off you can now

- 1) plug the speakon into the light bar.
- 2) Insert the second male speakon into the female connector on the deck, twist clockwise to engage.

