

Light Bar Hardware

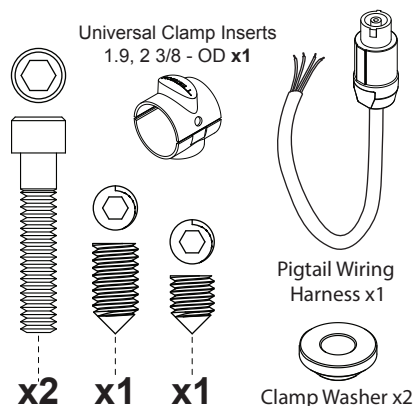

Tools Required

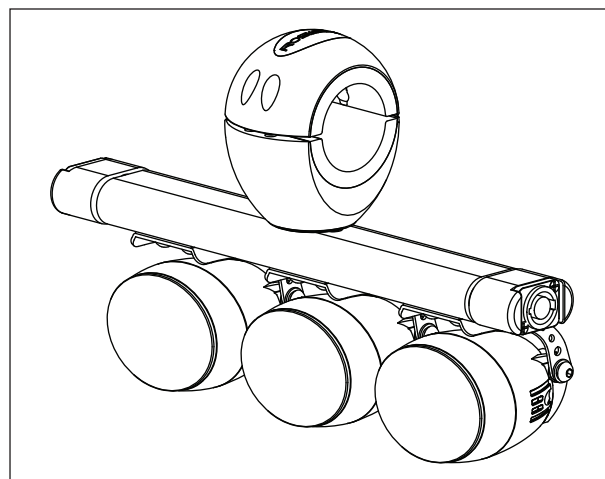
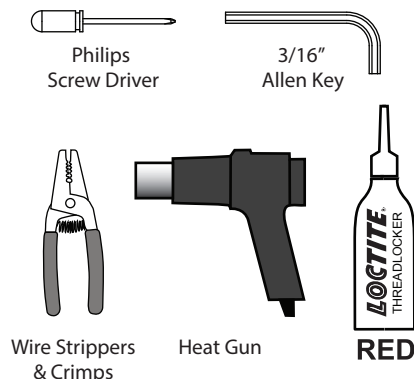

NOTES

If you purchased our Master Wiring Harness you will only need to provide wire and a fuse for the interior boat wiring. You will need wire for both the lights and the LED interior light – enough length to run from the rear of the starboard mount to your desired power source or switch (depending on your install).

We recommend a minimum 16 to 14 gauge wire for powering both the lights and the interior LED. You must mount an inline fuse between your battery and the switch. The inline fuse is designed to protect your wires connecting your light bar. Each light on the light bar draws 0.25 amps of current, thus the C4 Light Bar draws 1.0 amps. We recommend using a 5 amp fuse, however 2 to 15 amps is an acceptable range.

MOUNTING OPTIONS

Your new Elite Light Bar can be mounted anywhere on your tower – it has been designed to have the lights rotate to face either direction so it's up to you to choose a suitable mounting location.

Both ends of the light bar are equipped with a speakon connector, however only one end needs to be plugged in. This allows you to mount the light bar above or below the top section of the tower.

A

Light Bar Wiring Harness

<u>Wire Colour</u>	<u>Function</u>
Red	Lights +
Black	Lights -

B Unfasten the two 1/4" bolts holding the clamp together and pull back the top half of the clamp.

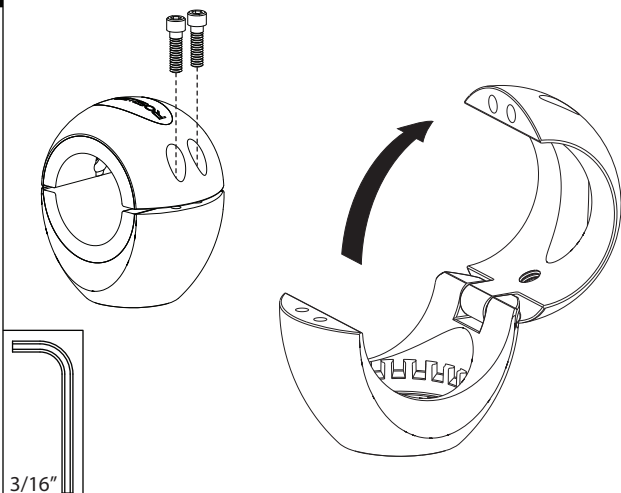

C Remove the bottom clamp insert. Place the clamp washers over the center holes, then insert the long 1/4" bolts through the washers, fastening the clamp to light bar. RED LOCTITE must be used.

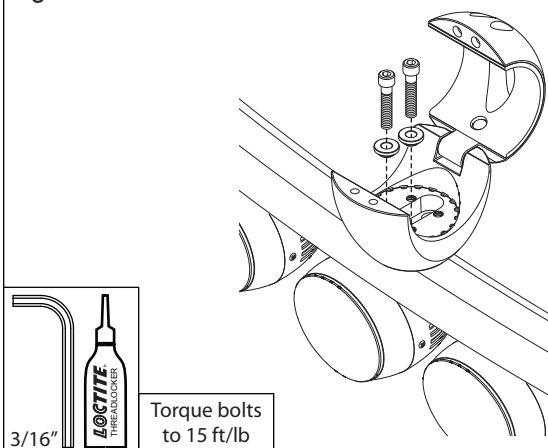
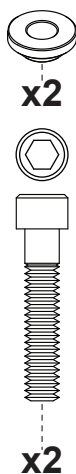

D Select the appropriate clamp inserts* for your tower, for the 2 3/8" clamp inserts use the shorter set screws.

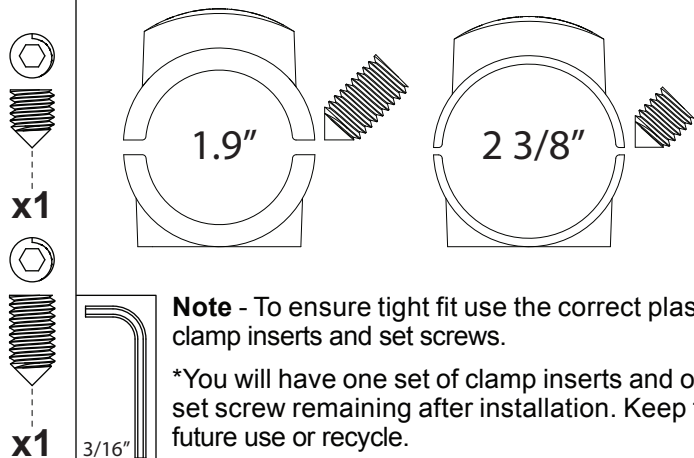

E Align the top half of the clamp around the tower and re-insert the 1/4" bolts tightening each one evenly, be careful not to strip the threads. RED LOCTITE must be used on both bolts and set screw.

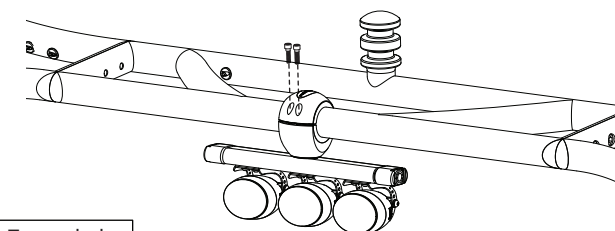

Torque bolts to 15 ft/lb



Once the light bar is secured to your tower, insert the appropriate set screw on the back of the clamp. This tightens the light bar to the tower and prevents it from rotating and moving around.

F With your boat and all switches turned off you can now
1) plug the speakon into the light bar.
2) Insert the second male speakon into the female connector on the deck, twist clockwise to engage.

