

ROSWELL.

WAKE-AIR

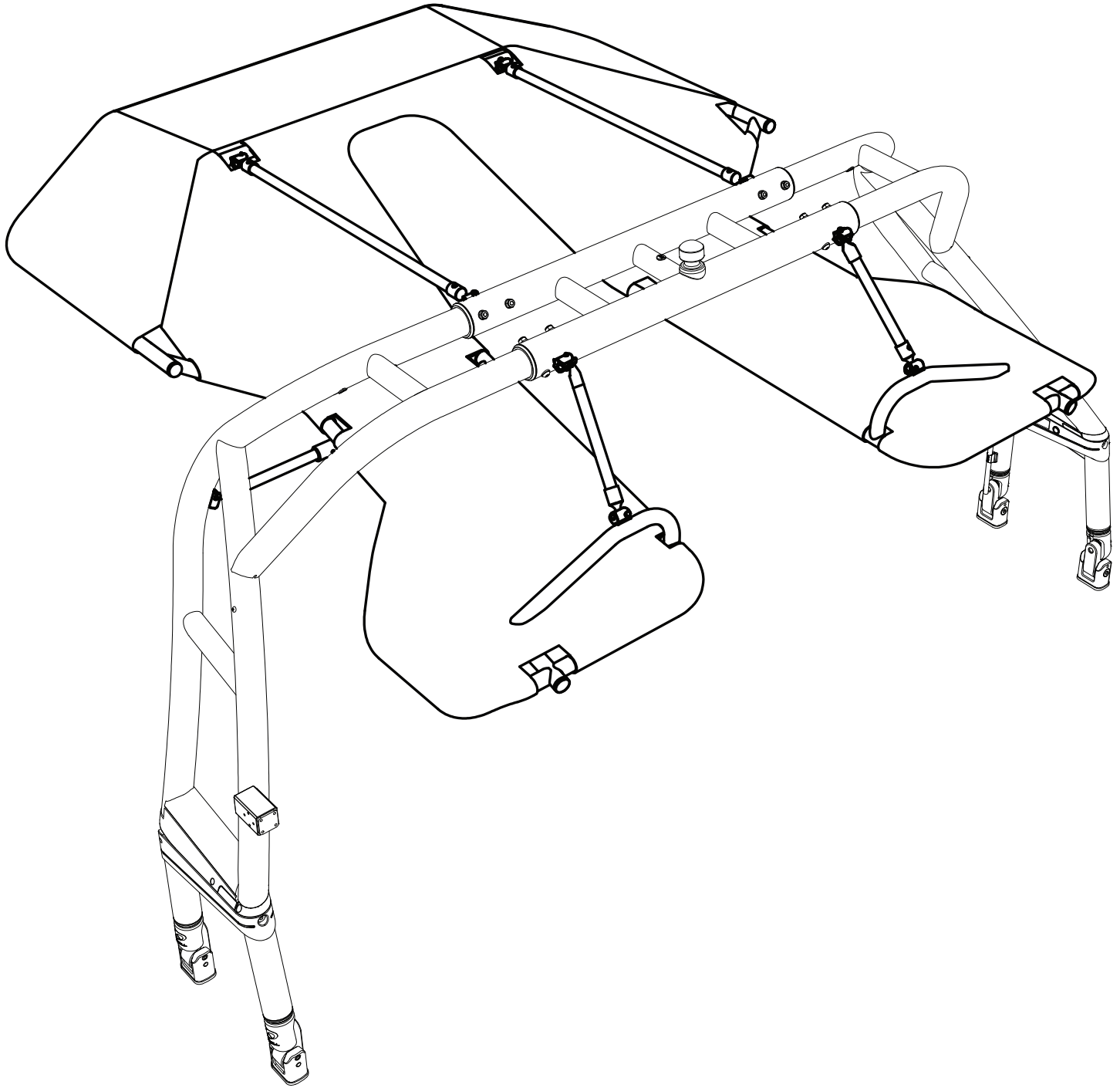

Roswell Aviator Shadow Top Installation Instructions

C910-2021

Rev. 22-Aug-13

SETUP

Prepare your workspace:

Clear a setup area near the boat. Make sure there is an unobstructed path from the boat to the setup area. We suggest unwrapping the Shadow Top on a dropcloth to prevent damaging or scratching the finish. Be careful to avoid marking or scratching the Shadow Top when removing its packaging. As you unpack each part, carefully lay them out on the dropcloth.

Shadow Top Main Components:

There are 6 main components to the Shadow Top:

1. Shadow Top frame
2. Long Support arms (x2)
3. Short Support arms (x2)
4. Main Fabric
5. Walkway Fabric
6. Telescopic Arms (x2)

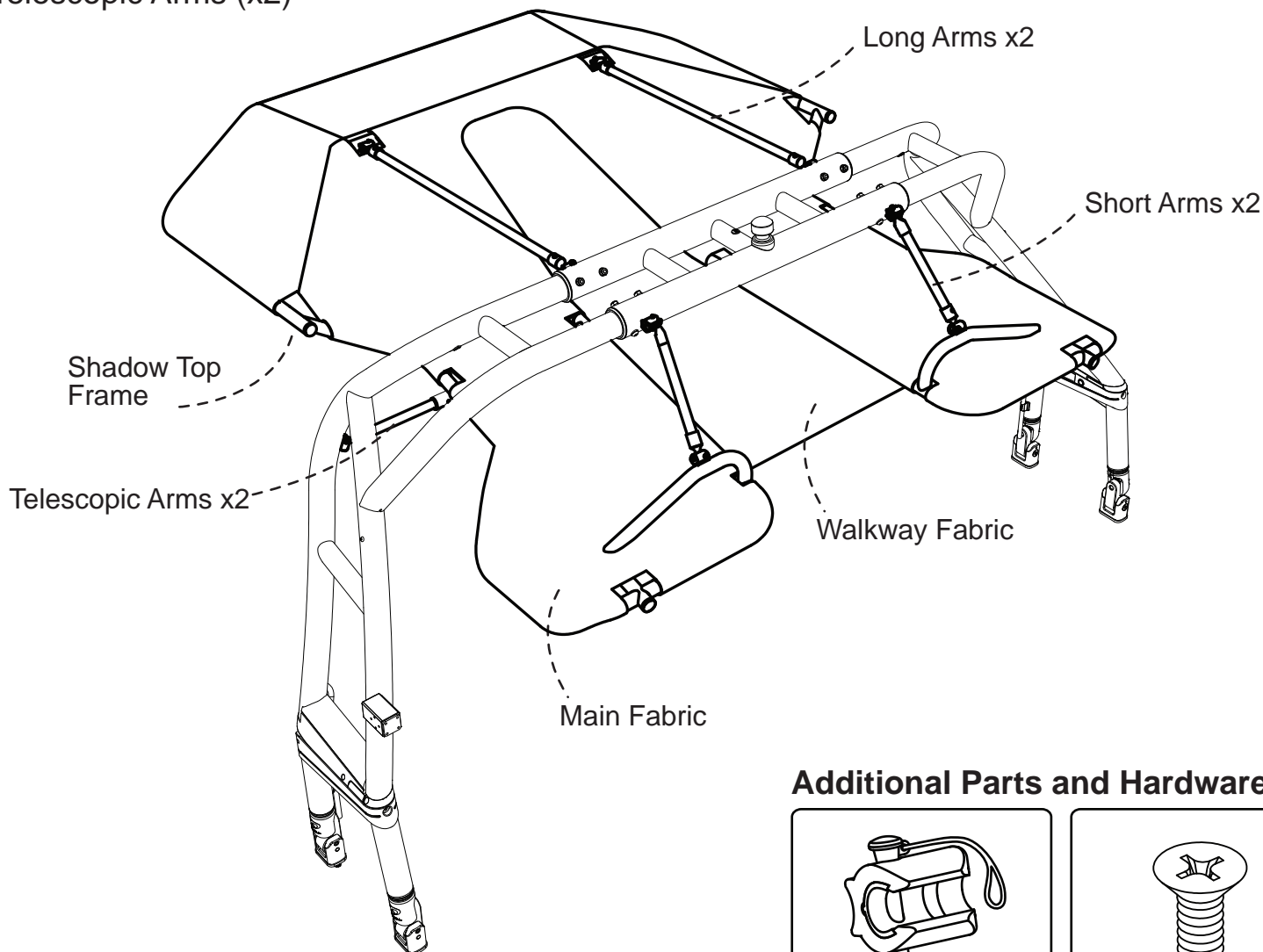

Additional Parts and Hardware:

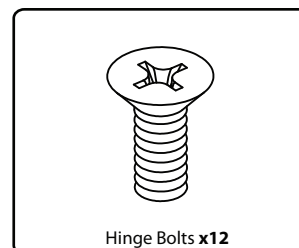
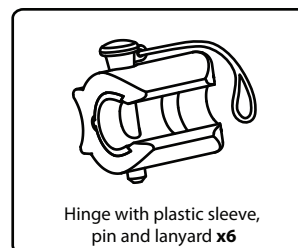

Tools you will need:

Phillips
Screwdriver

Red Loctite

Drop Cloth

Rubber Mallet

1/8" Allen Key

Tape Measure

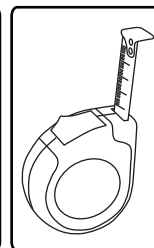
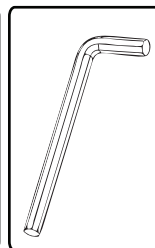
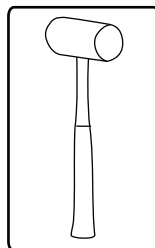
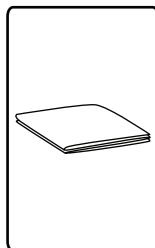
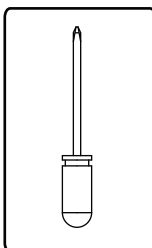

Roswell strongly recommends 2 people to install your Shadow Top. Failure to do so may result in injury and/or damaged parts. Damaged parts due to improper assembly are not covered under warranty.

A

Before final mounting of a hinge, it's important to ensure that the lanyard loop of the pin is located under the hole on the notched side of the hinge. The screw needs to go through the hinge, lanyard loop and into the tower.

x4

x2

Mount 2 of the hinges onto the sides of the tower in the pre-drilled holes. Mount the hinges so that the pin hole is on the top side. Apply a small drop of loctite to each bolt before mounting.

Warning :
Wipe off any excess loctite from the painted tower surface. Loctite will damage the paint finish.

B

Once you've installed both hinges and have verified the lanyard loops have been correctly installed under the hinges, slide a black plastic insert into each of the hinges as illustrated. You may need to gently tap the inserts into place with a rubber mallet. Do not insert the pins yet.

ROSWELL
wake-air

2

C

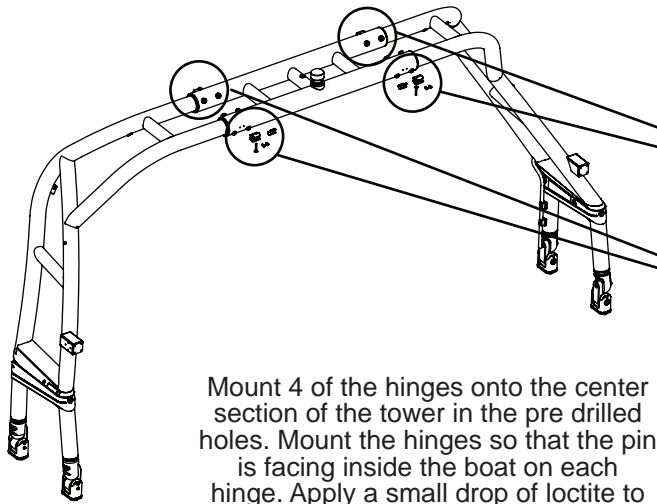

Mount 4 of the hinges onto the center section of the tower in the pre drilled holes. Mount the hinges so that the pin is facing inside the boat on each hinge. Apply a small drop of loctite to each bolt before mounting.

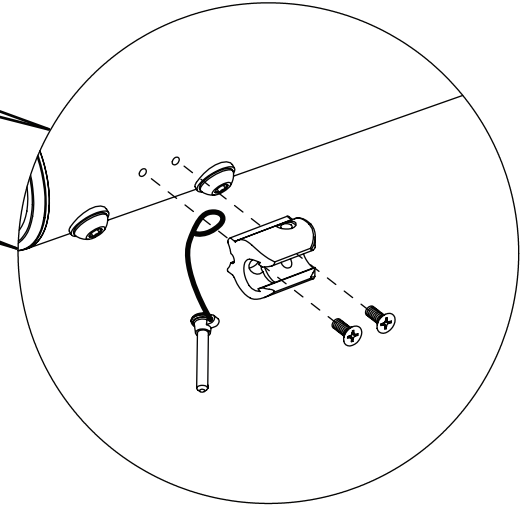

D

Once you've installed all 4 hinges and have verified the lanyard loops have been correctly installed under the hinges, slide a black plastic insert into each of the hinges as illustrated. You may need to gently tap the inserts into place with a rubber mallet. Do not insert the pins yet.

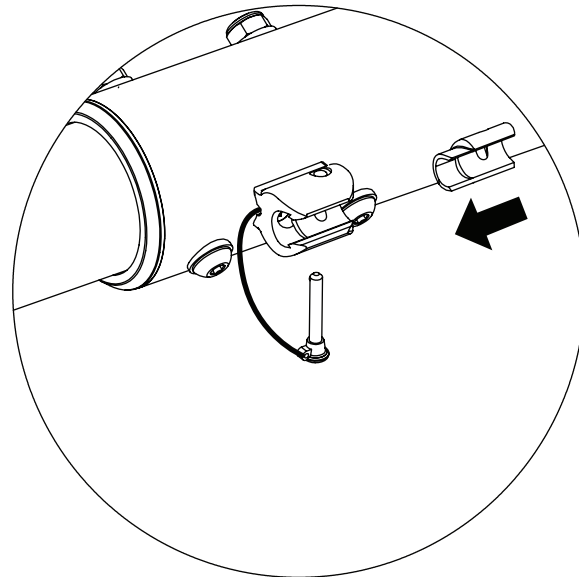

E

****This step requires 2 people****

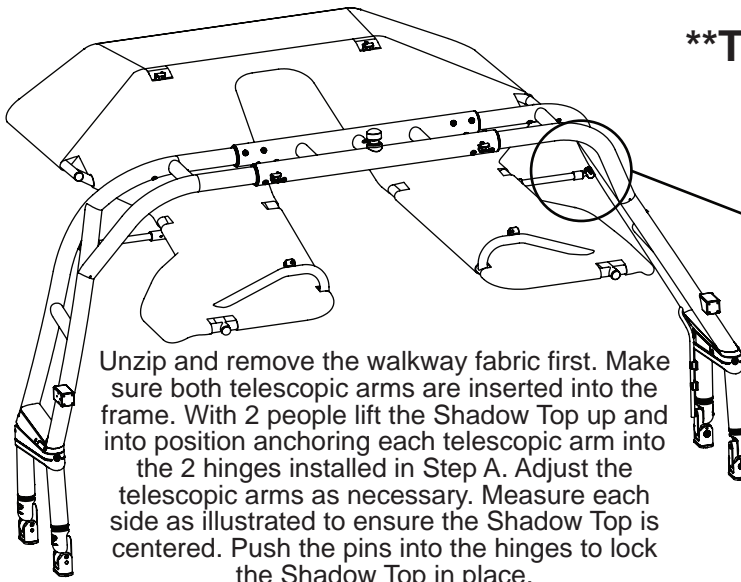

Unzip and remove the walkway fabric first. Make sure both telescopic arms are inserted into the frame. With 2 people lift the Shadow Top up and into position anchoring each telescopic arm into the 2 hinges installed in Step A. Adjust the telescopic arms as necessary. Measure each side as illustrated to ensure the Shadow Top is centered. Push the pins into the hinges to lock the Shadow Top in place.

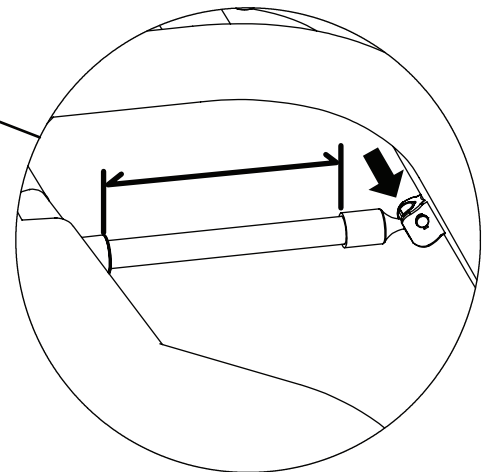

F****This step requires 2 people****

With 1 person holding the Shadow Top from rotating, insert both of the short arms into the rear hinges of the tower and Shadow Top as illustrated. The 90 degree fitting goes into the tower hinges, the straight fitting goes into the Shadow Top hinges. Lock the short arms in place by inserting all 4 hinge pins.

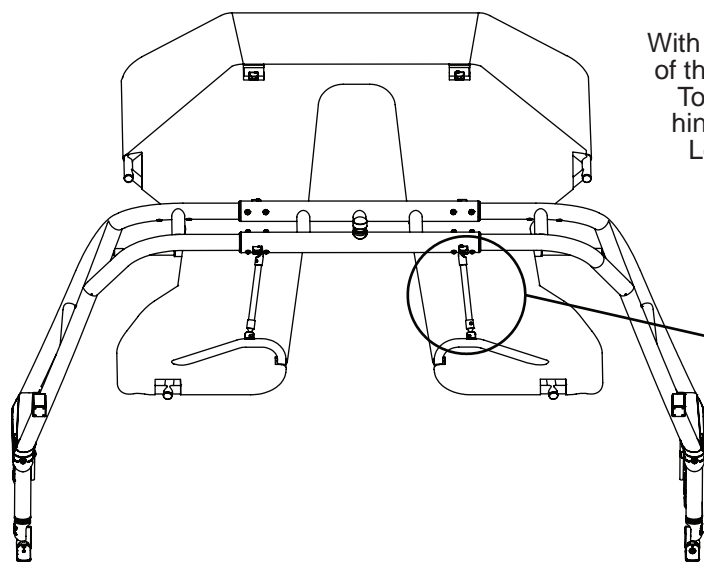

90 degree Fitting

Straight Fitting

G

Insert both of the long arms into the front hinges of the tower and Shadow Top as illustrated. Lock the long arms in place by inserting all 4 hinge pins.

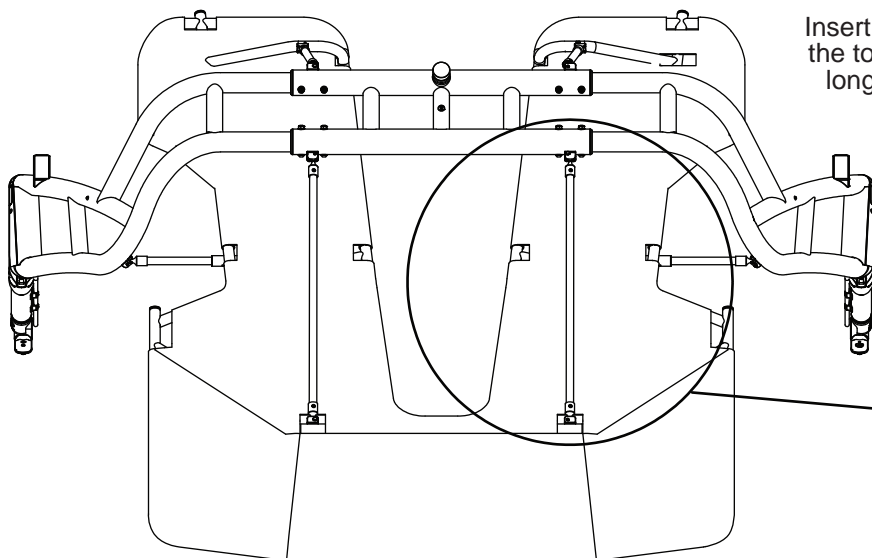
**H**

It may be necessary to make some minor adjustments to your support arm fittings to achieve an optimal fit. This can be done by loosening the set screw on each fitting and sliding them to a new position. Retighten the set screws.

Set screws

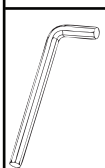
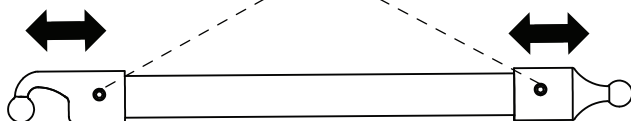
**I**

**Your Shadow Top is now installed and ready to use.
Enjoy!**

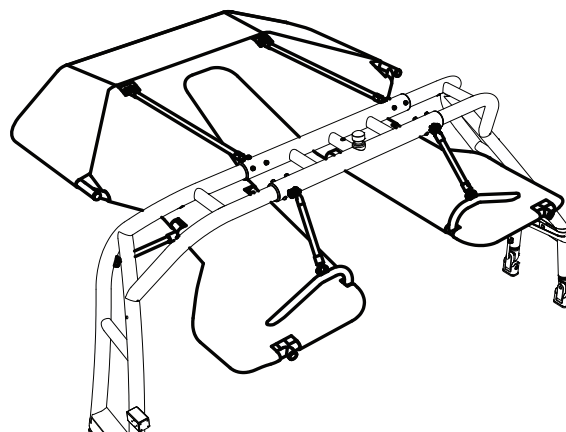

Depending on your preference, the Shadow Top features a walkway filler piece of fabric to increase the amount of shade provided.

J

To attach your walkway filler fabric first zip the 2 rear zippers, then the 2 front zippers and finish by securing the front velcro tab. To remove the filler fabric, repeat the steps in reverse.

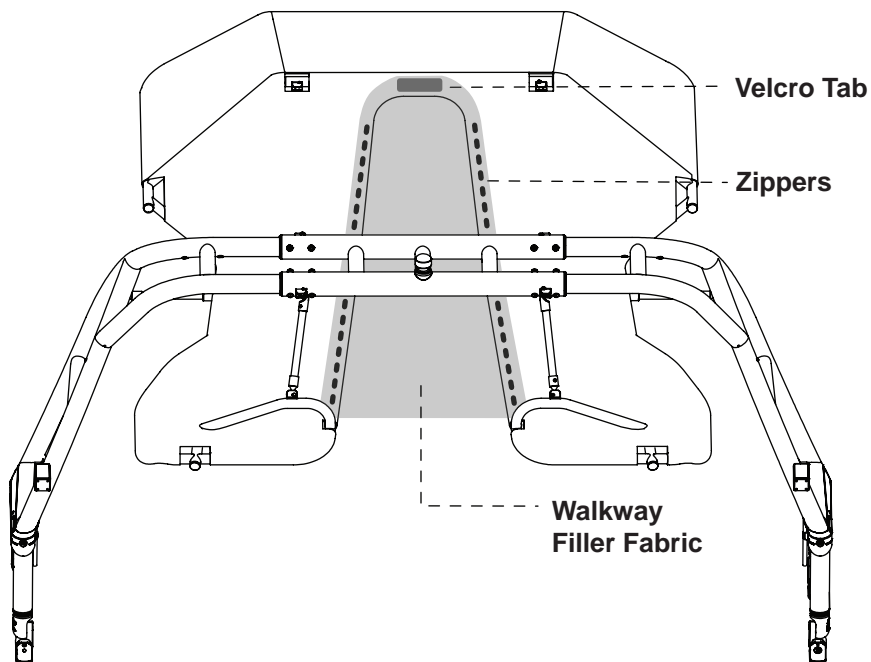

Your Shadow Top is designed to fold up easily with your Aviator tower.

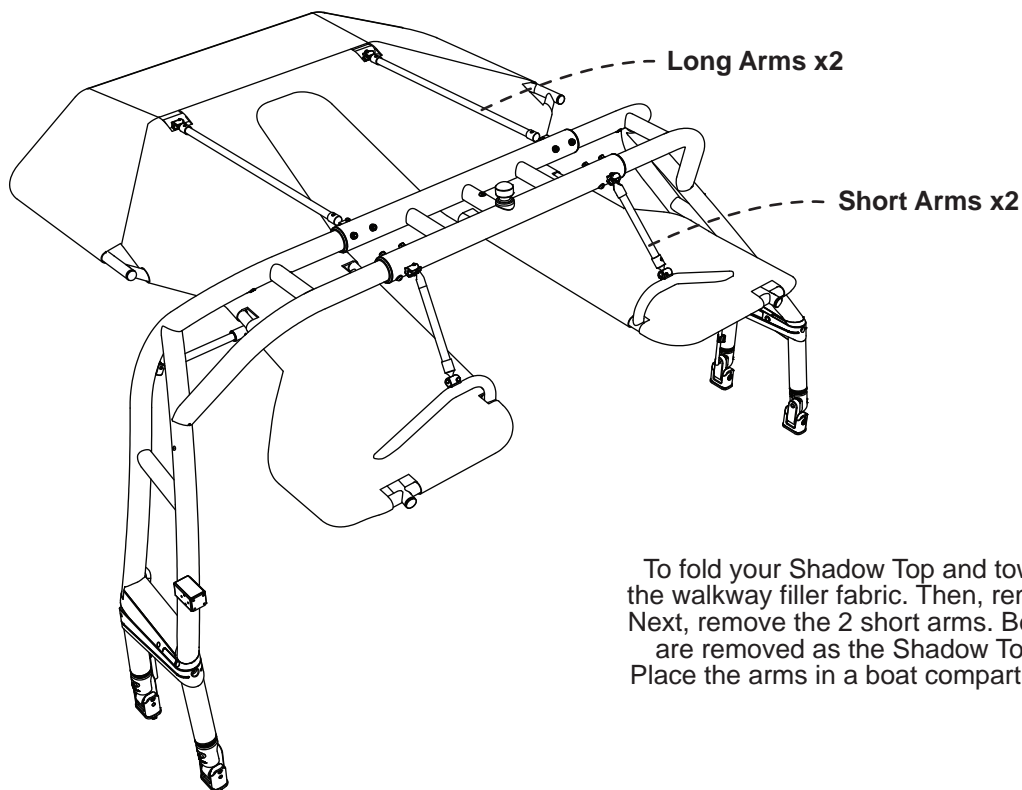
K

To fold your Shadow Top and tower start by removing the walkway filler fabric. Then, remove the 2 Long arms. Next, remove the 2 short arms. Be careful once all arms are removed as the Shadow Top will want to rotate. Place the arms in a boat compartment for safe keeping.

L

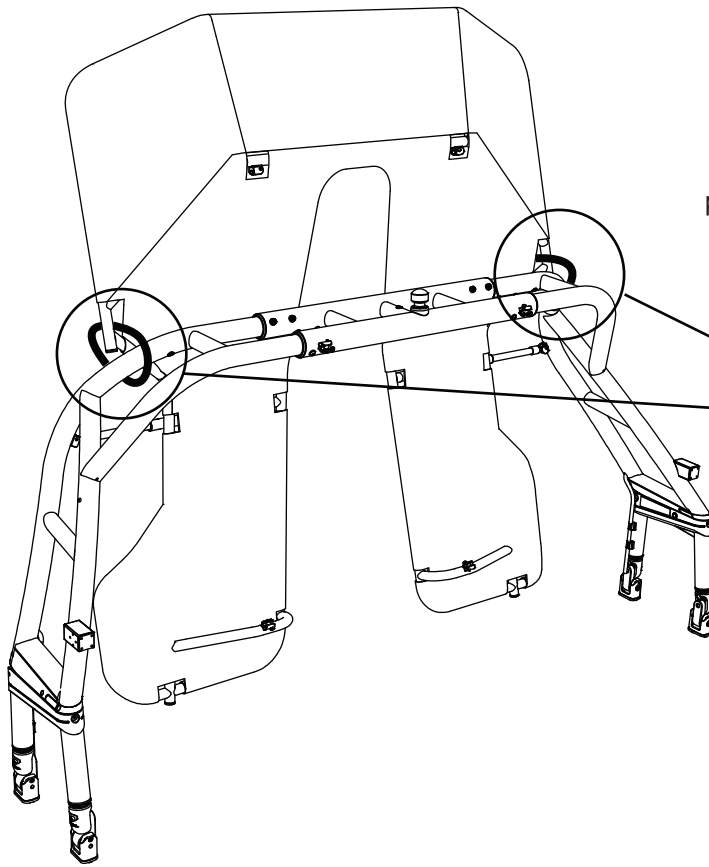

Rotate the Shadow Top upwards and secure it to the tower in the upright position with the 2 straps provided. Loop the straps around the tower tubing wherever it is convenient and tighten.

Straps x2

M

Release your tower cam latches and rotate the tower and Shadow Top forward. To put your Shadow Top up, repeat these steps in reverse.

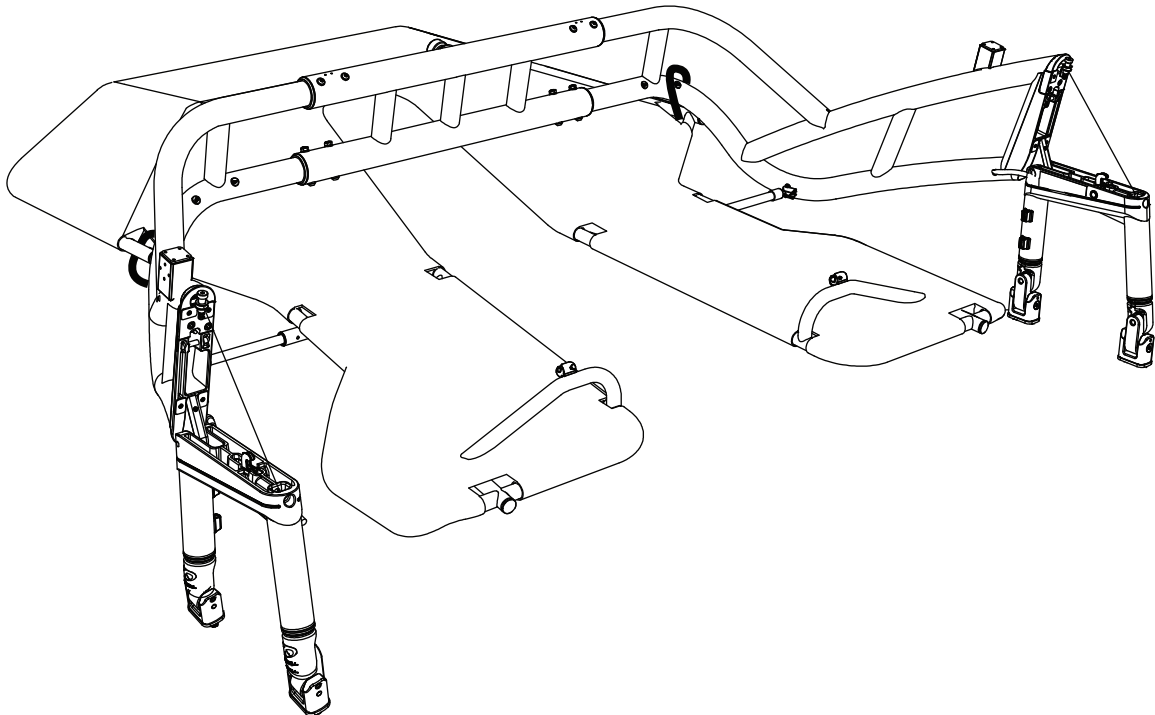

N

*****The Illustration below shows the Shadow Top and tower in the upright position with the fabric removed. This is the ONLY safe way to trailer your boat with the Shadow Top.*****

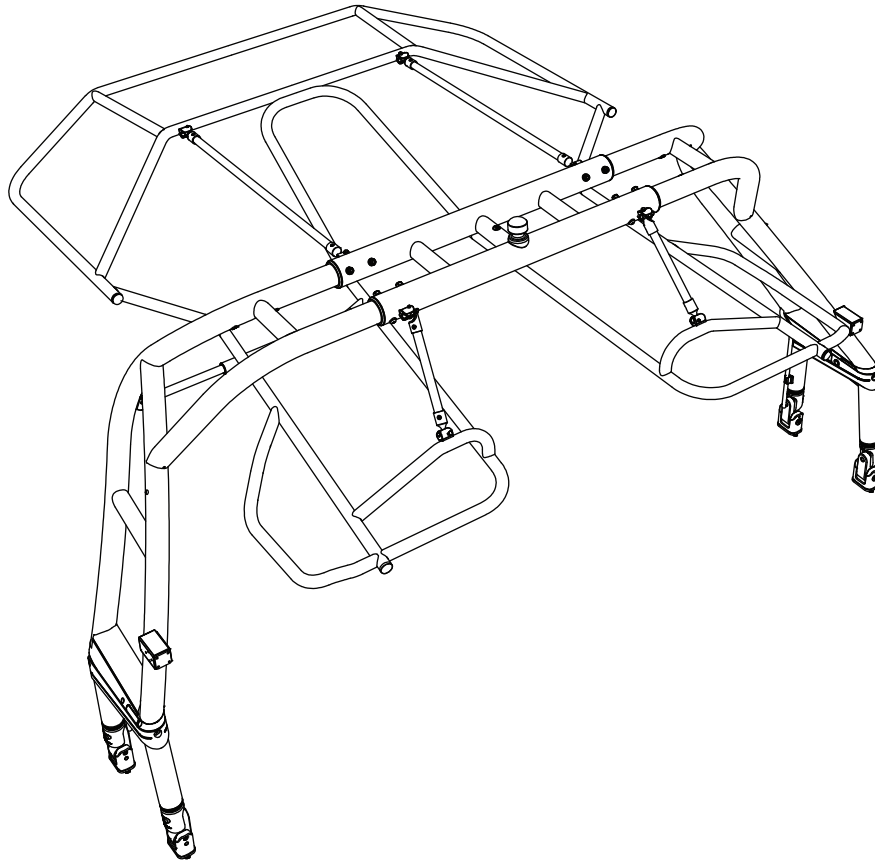

! ATTENTION !

DO NOT TRAILER YOUR BOAT WITH THE SHADOW TOP FABRIC INSTALLED

DO NOT FOLD YOUR TOWER WITH THE SHADOW TOP IN ITS OUTSTRETCHED POSITION

DO NOT USE YOUR SHADOW TOP IN ITS OUTSTRETCHED POSITION IN ANY HIGH WIND CIRCUMSTANCES

