

Parts

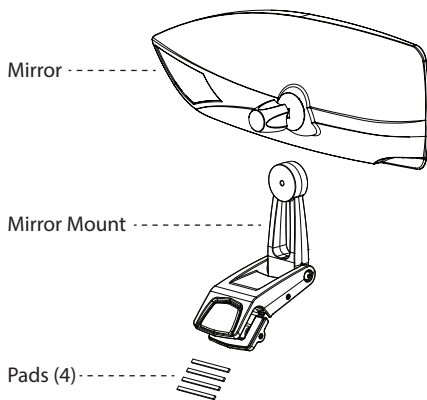

Tools Required

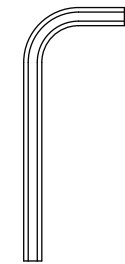

5/32" & 3/16"
Allen Key

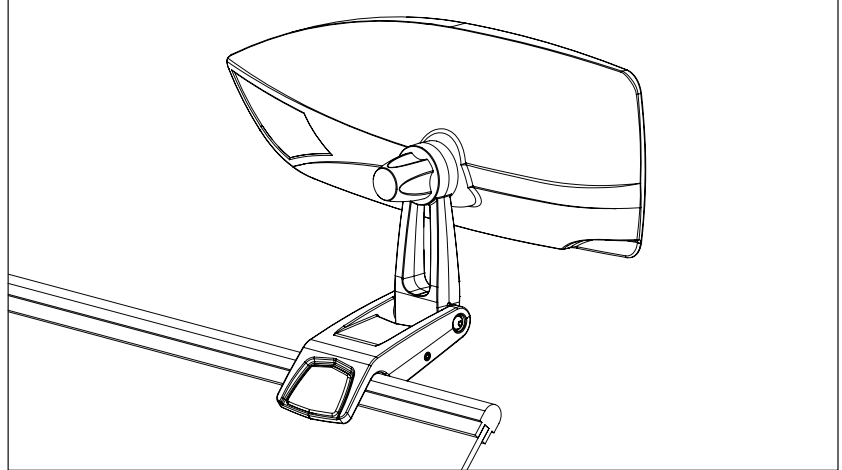

A

Remove the mirror mount from the packaging and make sure all parts (illustrated above) are accounted for. Turn the mount upside down and using a 5/32 allen key, loosen the adjustment bolt so that the opening is big enough to fit over your windshield's header.

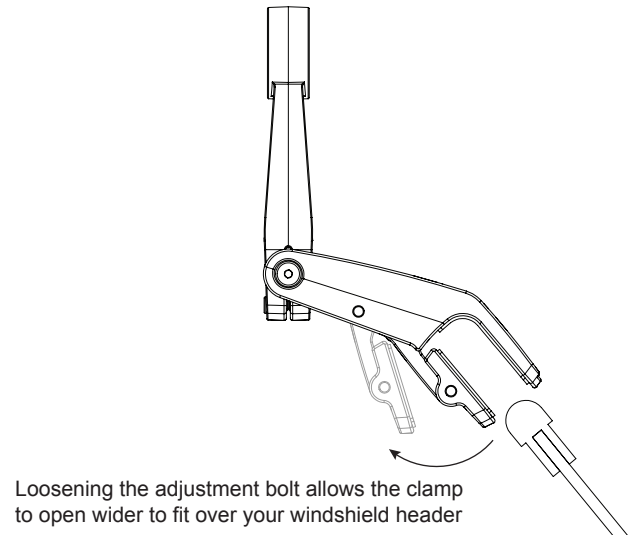
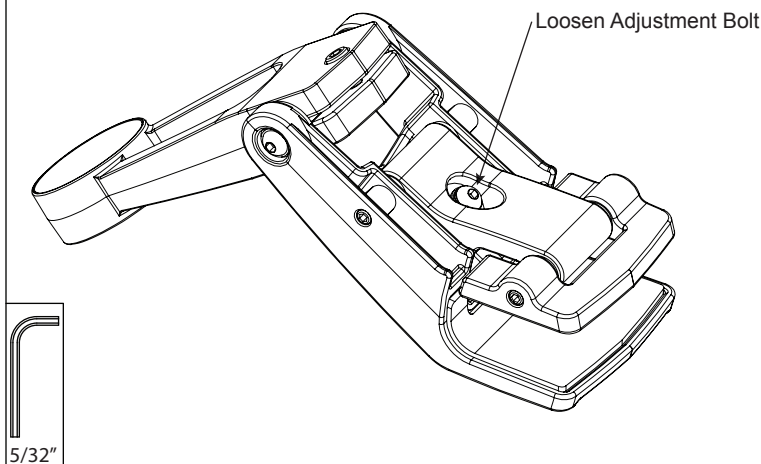

B

Slide the open clamp over the header. If there are gaps between the padded mount surface and the header use the self-adhesive pads to fill in the gaps. Use as many as necessary so that there is as much surface contact as possible between the mount and the windshield header.

OR

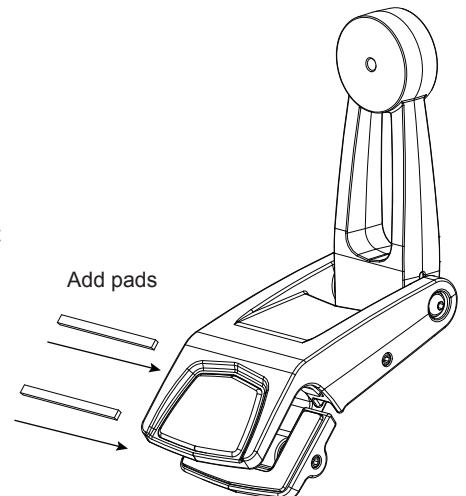
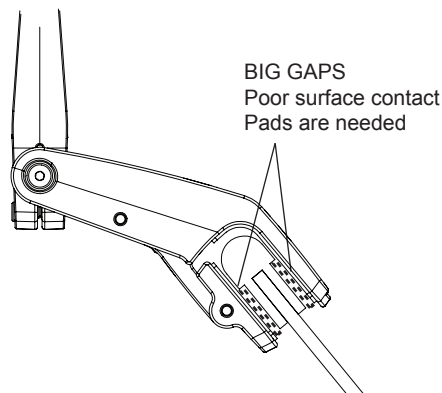
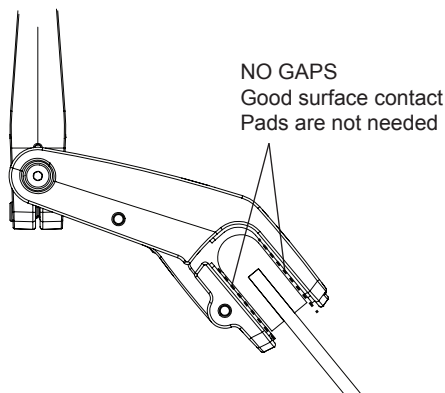

C

Using a 3/16 allen key, loosen the single bolt at the base of the mirror mount arm. This will allow you to adjust it to the desired viewing angle. When the desired angle is achieved, re-tighten the bolt. Don't tighten it too much so that you can still fold the mirror down and out of the way without needing an allen key.

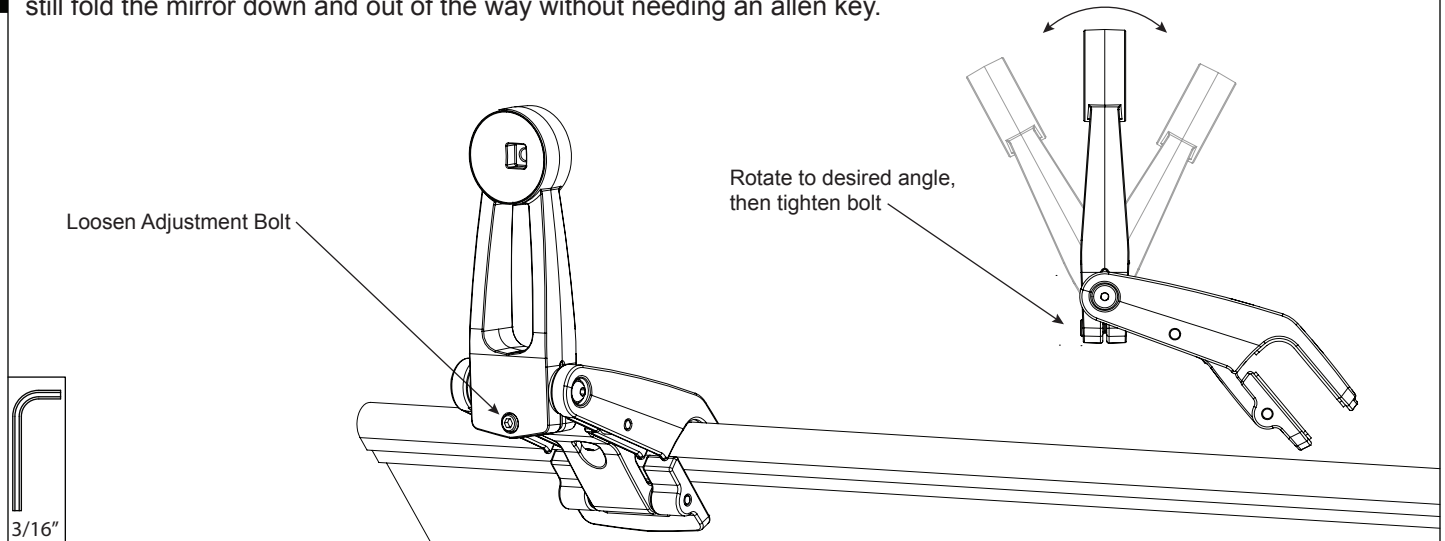

D

Attach the Roswell mirror to the mirror mount as shown. You can micro-adjust the mirror angle further before tightening the hand knob completely. Your mirror is ready to go!

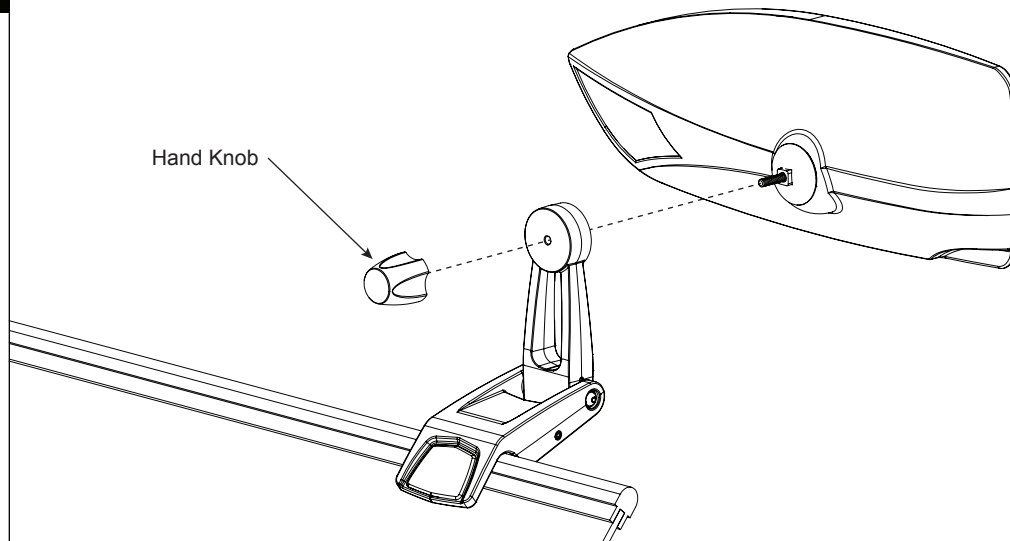

****Regularly check the tightness of all bolts to make sure the mirror mount is secured tightly to the windshield.****