

ROSWELL.

WAKE-AIR

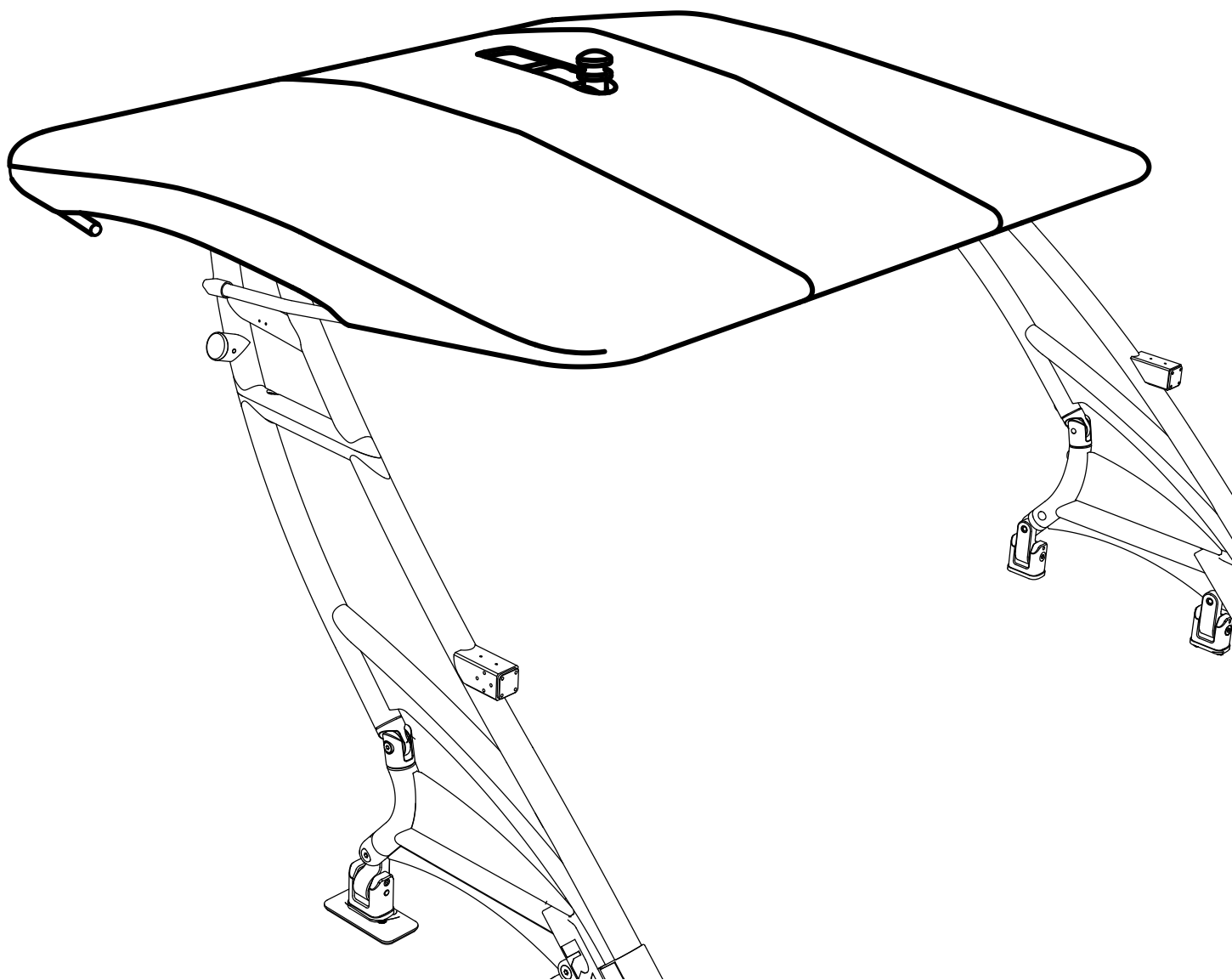

CamRT Sun Top Bimini Installation Instructions

C910-2027 & C910-2028

Rev. 16-Jun-15

www.roswellmarine.com

Information: info@roswellglobal.com

Warranty: warranty@roswellglobal.com

Questions? Please call us at (321) 638-1331

Setup:











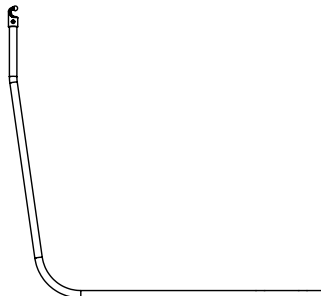

Prepare your workspace:

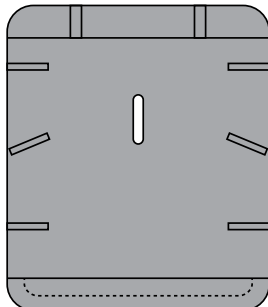
Clear a setup area near the boat. Make sure there is an unobstructed path from the boat to the setup area. We suggest unwrapping the CamRT Bimini parts on a drop cloth to prevent damaging or scratching the finish. Be careful to avoid marking or scratching the bimini components when removing the packaging. As you unpack each part, carefully lay them on the drop cloth.

AVX Tower owners:

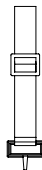
The tower shown in this manual is the CamRT. If you are using an AVX tower any differences in the installation process will be noted.

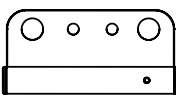
CamRT Sun Top Bimini Parts Contents

						
Bow Support Tube (x2)	Bow Outer Tube (x2)	Stern Outer Tube (x2)	Centre Tube (x2)			
						<div>Not included for wiring</div> 
Main Fabric Width: Small 76" Wide 86"	Deck Hinge (x2)	#10-24 x 1/2" (x8)	#8-18 x 1/2" (x12)	Padeye Strap Large (x2)	Padeye Strap Small (x2)	Heat Shrinkable Butt Connectors
						
	Padeye (x2)	Halo Plate (x2)	Protective strap (x2)			

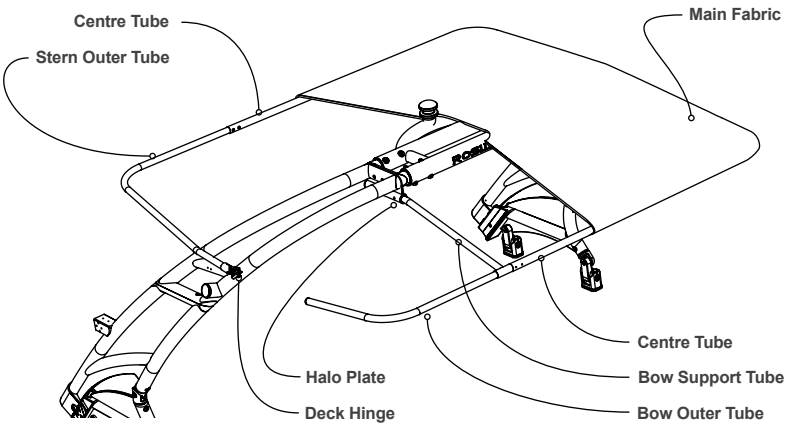

Tools you will need:

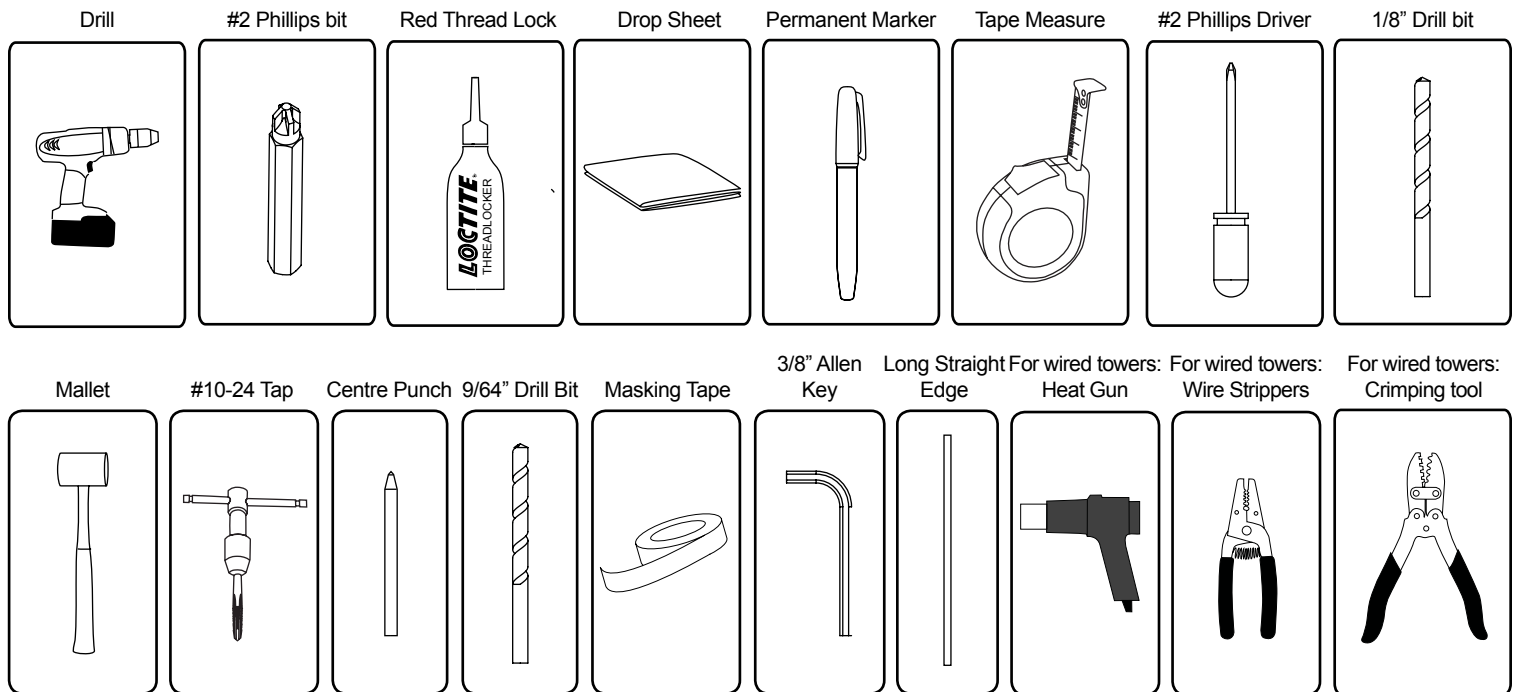

Roswell strongly recommends 2 people to install your CamRT Sun Top Bimini. Failure to do so may result in injury and/or damaged parts. Damaged parts due to improper assembly are not covered under warranty.

A

*** Follow this step if installing a tower & bimini at the same time ***

*** Go to step B for installation of the CamRT Sun Top onto a tower that is already installed ***

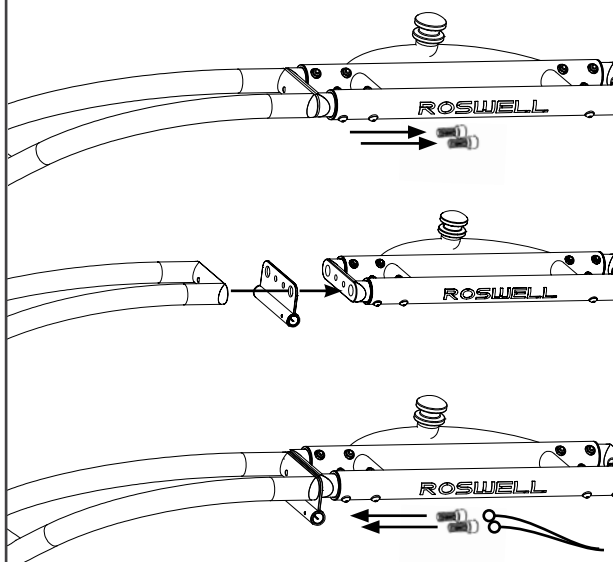

Complete these steps one side at a time.

1. Remove the 2 bolts from the connection between the centre section and the upper side section of the tower.
2. Pull wires through the halo plate and feed them into the centre section.
3. Apply red thread lock to the bolts and re-install the 2 bolts from the centre section to the upper side section.

Note: Refer to your tower's instructions for information on wire routing and pull string locations. Refer to any electronics instructions for information on wiring requirement.

B

*** Follow this step if installing a bimini on a pre-installed & wired tower ***

Complete these steps one side at a time.

1. Cut your existing wires.
2. Thread your wires through the Halo plate & reconnect using heat shrinkable butt connectors.
3. Use a heat gun to shrink the connectors.
4. Apply red thread lock to the bolts and re-install the 2 bolts from the centre section to the upper side section.

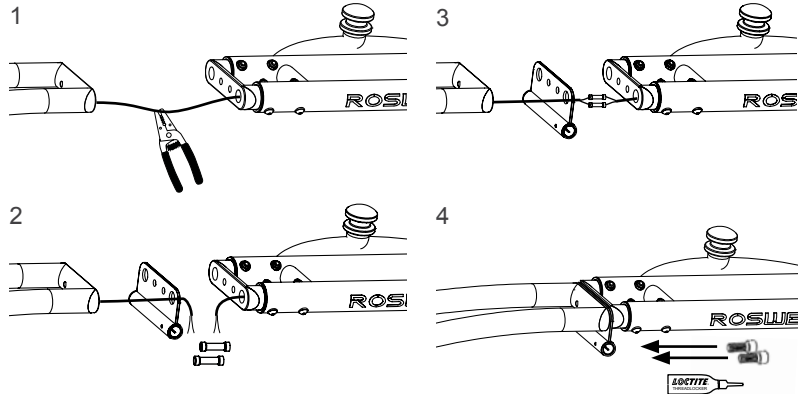

Butt
Connectors (not
included)

**C****CamRT Tower**

1. Install deck hinges using countersunk machine screws. Ensure the stern screw goes through the hinge locking pin's lanyard. Position the locking pin lanyard through the slot on the bottom of the deck hinge. Apply red thread lock to screws.
2. Install the deck hinge's plastic inner sleeve.

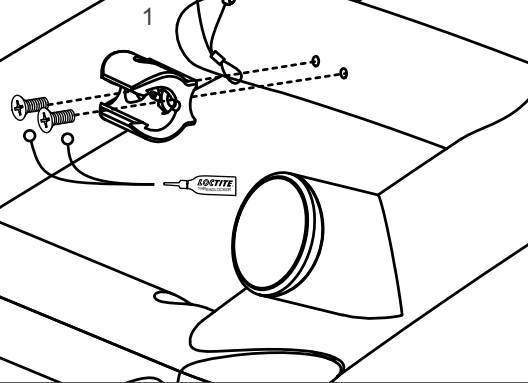
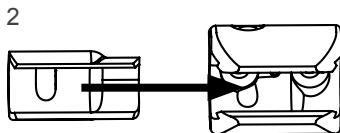

Lanyard exit slot

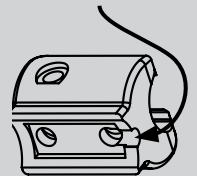

Note Direction

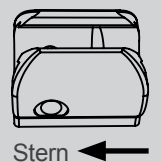

Stern

x2
x2
x4

**D****CamRT Tower**

Install your padeyes with the 1/2" counter sunk machine screws. Apply red thread lock to the screws.

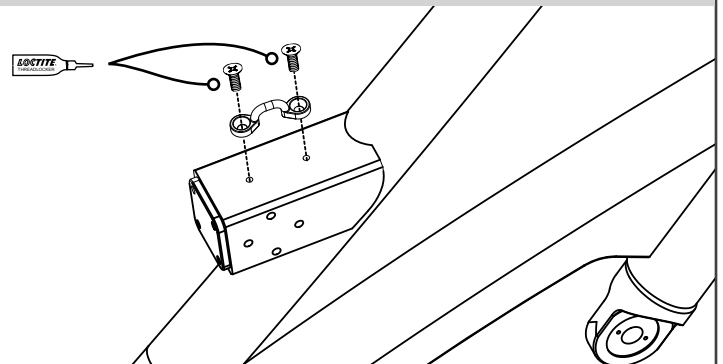

x2
x4

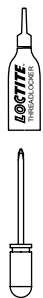

E**AVX Tower**

1. Apply tape to deck hinge mounting area: 13-19" from the speaker mount illustrated.
2. Make a mark 16" up from the tower's speaker mount.

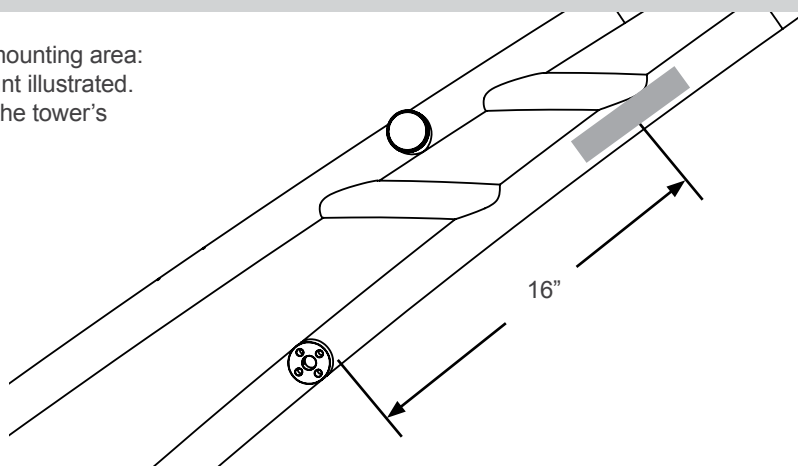
**F****AVX Tower**

1. Place the deck hinge on the tower's tube so it is parallel to the long axis of the tube.
2. Position the deck hinge so the lower hole is over top of the mark made in step C1.
3. Mark both holes with permanent marker.

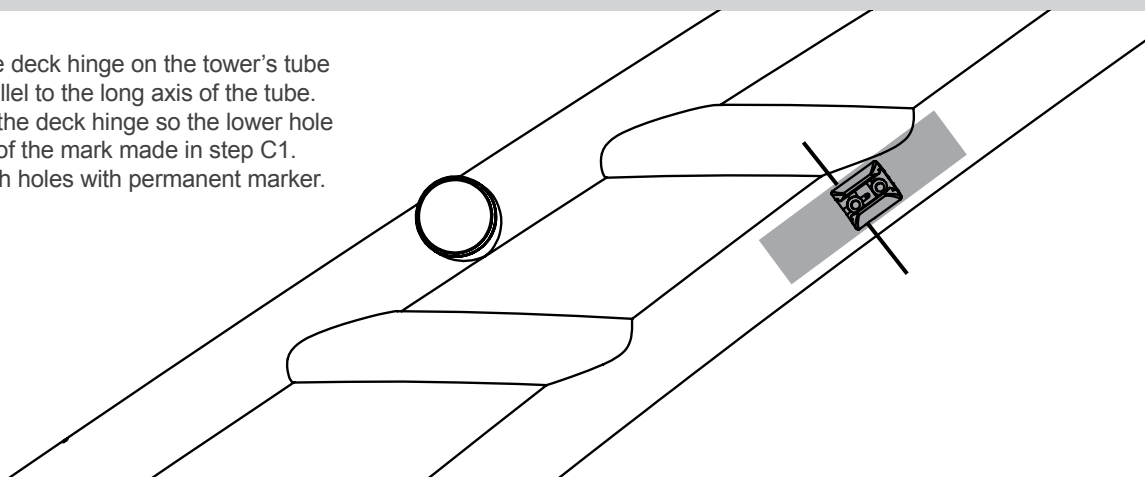
**G****AVX Tower**

1. Use a centre punch to make centre marks on your tower's tube.
2. Use a 9/64" or #25 drill bit to drill the holes for each deck hinge.
3. Use a #10x24 tap to thread the holes.



9/64"

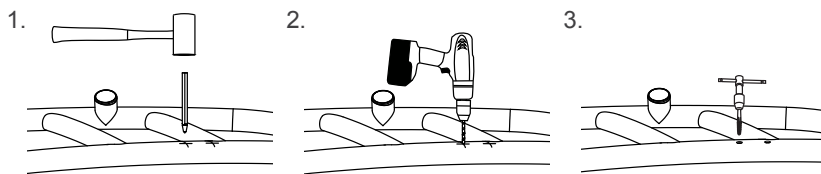

H**AVX Tower****4**

x2



x2



x4



1. Install deck hinges using countersunk machine screws. Ensure the stern screw goes through the hinge locking pin's lanyard. Position the locking pin lanyard through the slot on the bottom of the deck hinge. Apply red thread lock to screws.
2. Replace the plastic inner sleeve in the deck hinge.

2

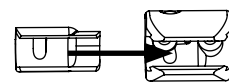

1

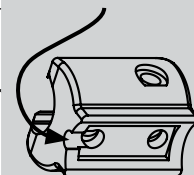
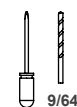

Lanyard exit slot

**I****AVX Tower****1**

x2



x4



1. Use a 9/64" or #25 drill bit to drill the holes for each padeye.
2. Use a #10x24 tap to thread the holes.
3. Install the padeyes with the provided countersunk machine screws. Apply red thread lock to the threads.

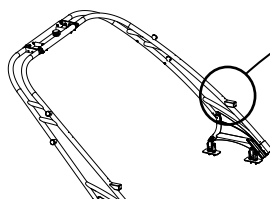

1

2

3

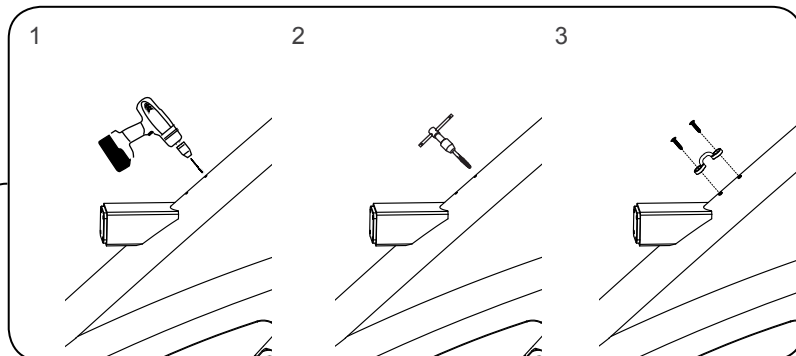
**J**

1. Slide the bow support tubes over the bow outer tubes.
2. Slide the centre tube over the bow support tubes.

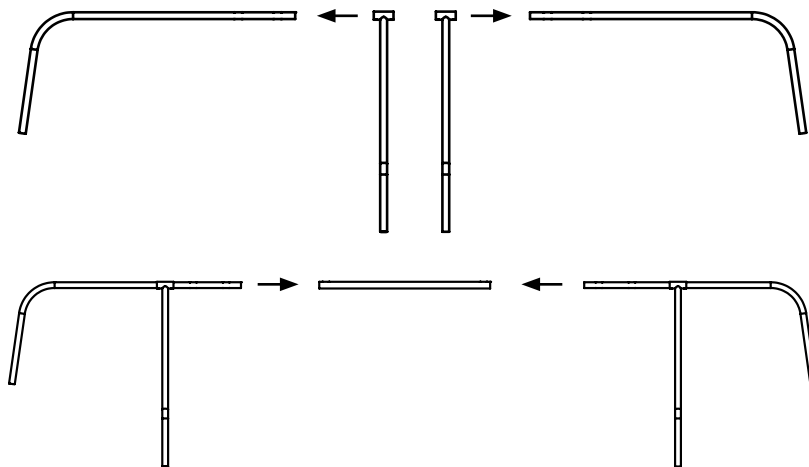

K

Attach the centre tube to the bow outer tubes using four self tapping screws. Use the holes that face inwards as indicated in the illustration. Use the holes marked in the illustration for your bimini size.

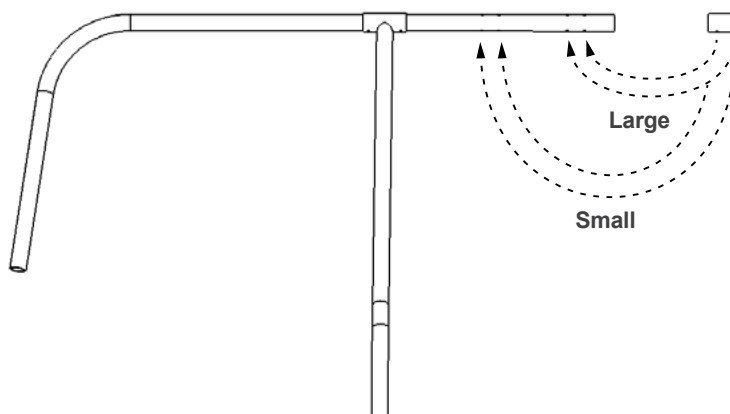

x4

**L**

Measure the distance between the halo plates then slide the bow support tubes to a distance equal to the halo plate spacing. Insert the bow support tubes into the Halo plate tubes until they bottom out at the back.

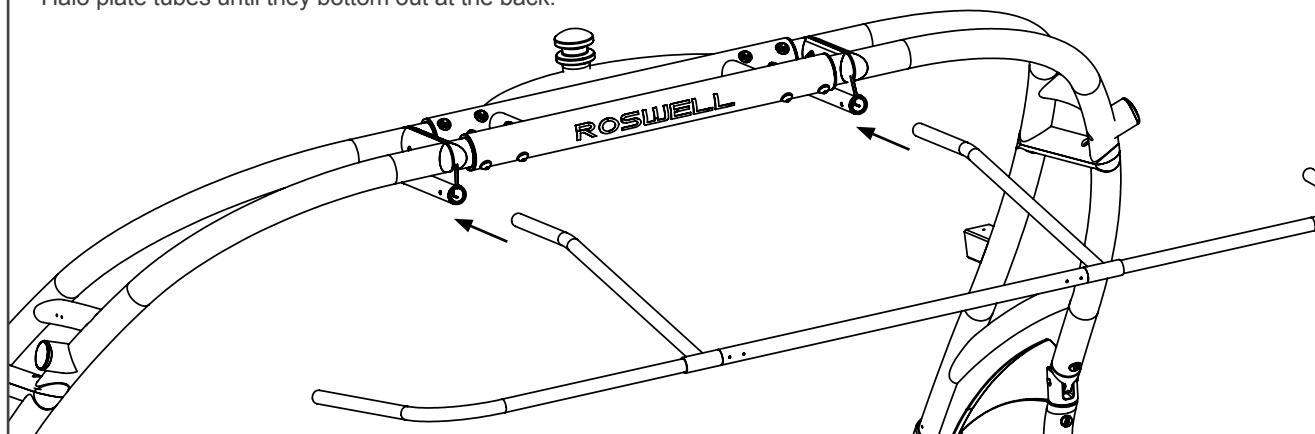
**M**

Check the centering of the bow tubes relative to the bow supports. The left and right distances should be equal. Wrap masking tape around the bow outer tubes where they meet the bow support tubes on the inside to mark the alignment of the tubes as centered.

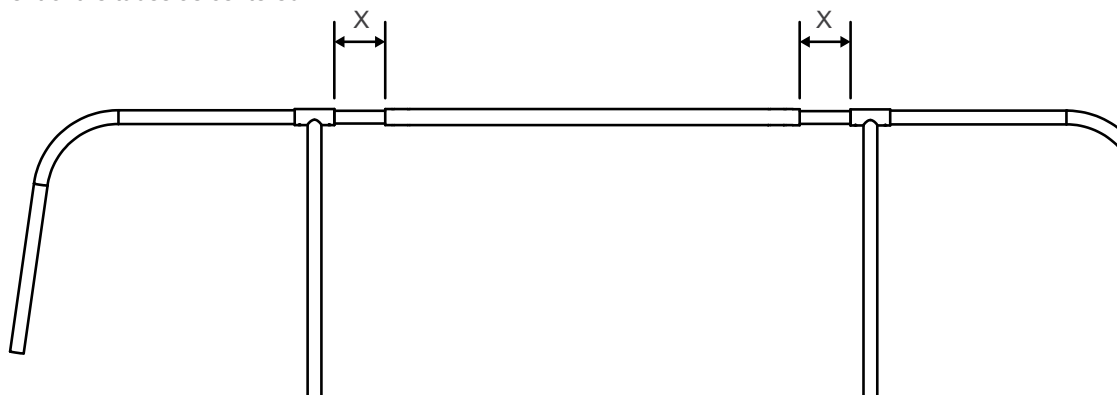

N**This step requires 2 people**

Leveling the bow tubes:

1. Have one person ready to mark the hole location on the bow outer support tubes with a permanent marker.
2. Rotate the bow tubes so that the ends of the tubes which point towards the stern are parallel to the upper side brace on your tower. Use a straight edge to gauge this.
3. Mark the location for the screws which attach the bow supports to the bow outer tubes.

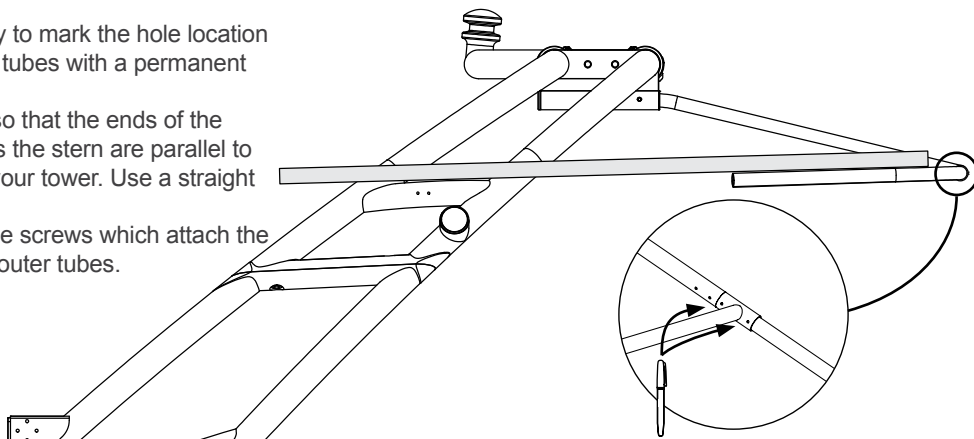
**O**

Drill four 1/8" pilot holes in the outer support tubes in the locations you marked.

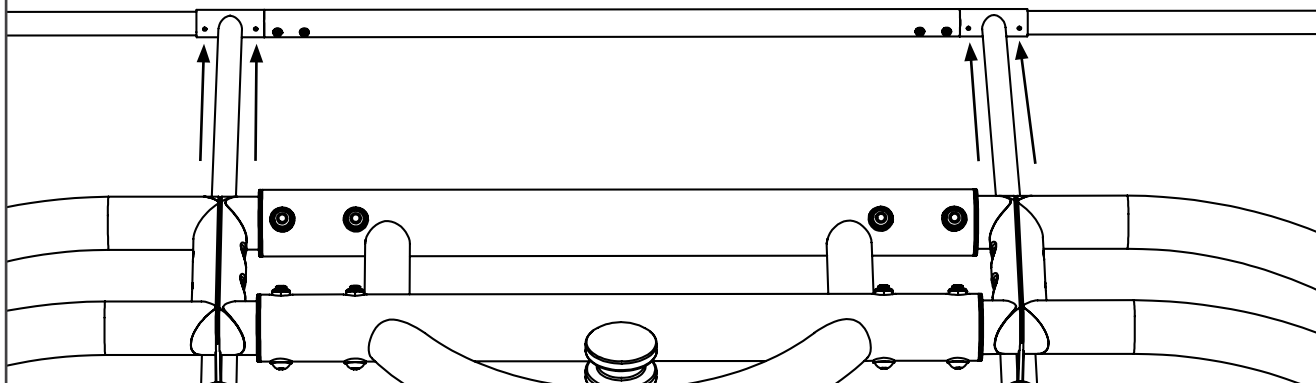

1/8"

**P**

Install four self tapping screws through the bow supports and into the bow outer tubes.



x4

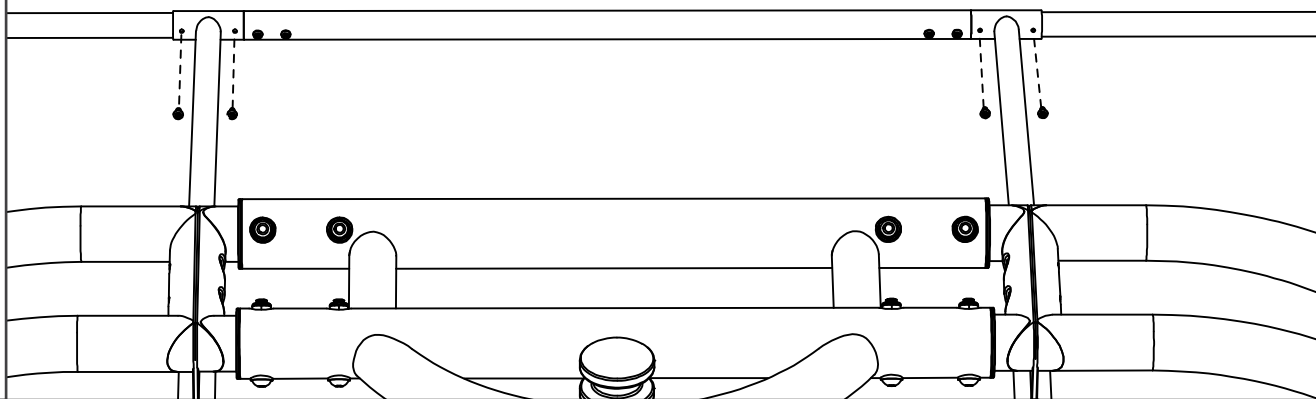

Q

1. Insert the stern outer tubes into a centre tube.
2. Use four self tapping screws to secure the outer tubes onto the centre tube. Use the holes that face inwards towards your tower. Use the holes marked in the illustration for your bimini size.



x4

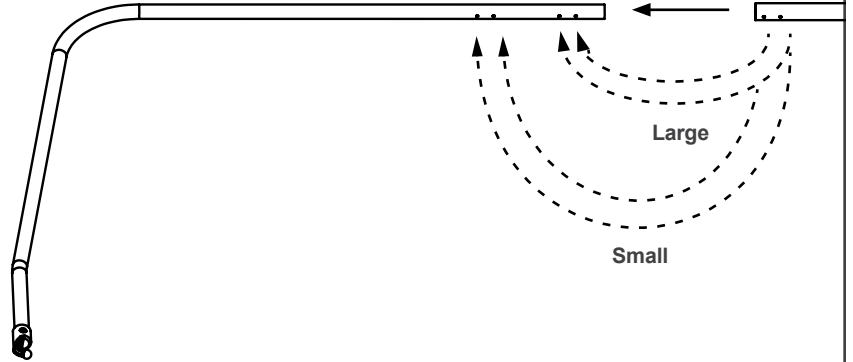

R

1. Feed the stern tube through the sewn in channel on the stern side of the bimini fabric.

Stern

1.

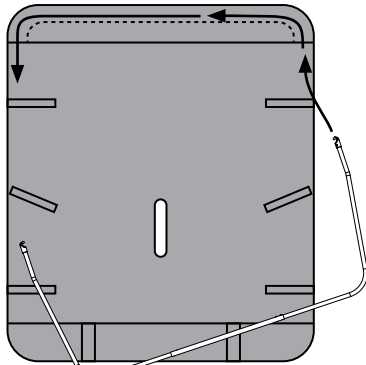

Bow

2. Slide the padeye straps over the stern support tubes. Use small straps for CamRT towers and large straps for AVX towers.
3. If your beam width is near the maximum beam width for your bimini slide a protector wrap over the stern tube 6-8" from the end. This will be adjusted to sit directly over the tower's tubes later.

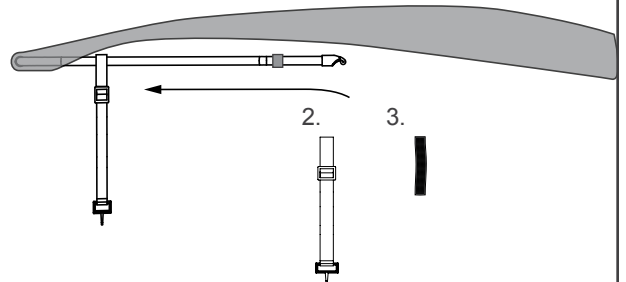

S

1. Insert the stern tube assembly into the deck hinges. You may have to pull or push the ends of the assembly apart to line them up with the deck hinges.
2. Insert the locking pins into the deck hinges to hold the tube assembly in place.

*Note: Canvas omitted from image for clarity

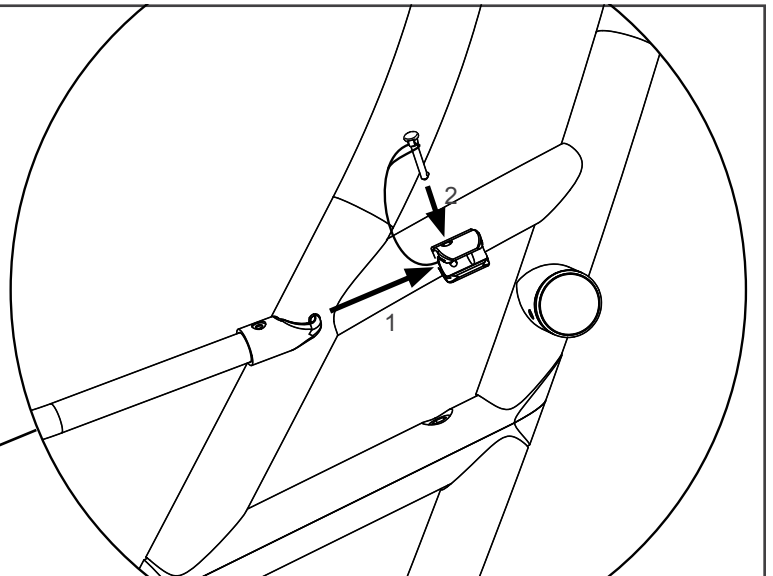
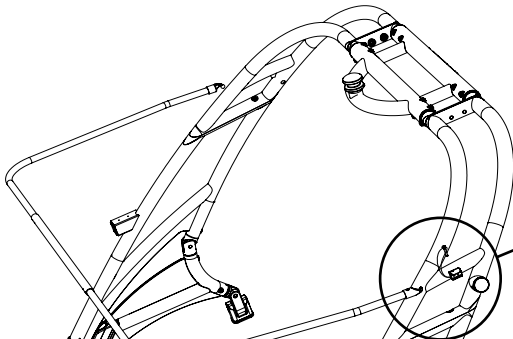

T

1. Grab the bow end of the Bimini fabric and toss it over the top of the tower and pull it up to the bow tubes.
 2. Wrap pocket fabric around bow tubes and velcro in place to secure the front of the bimini in place.
- *Note: tower omitted from second illustration for clarity.

1

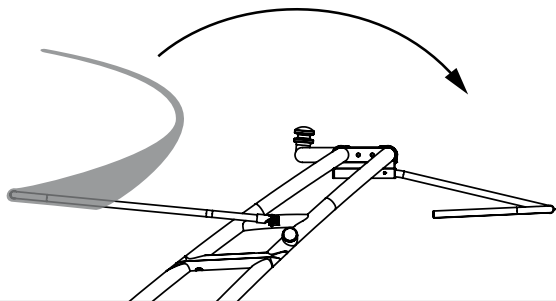

2

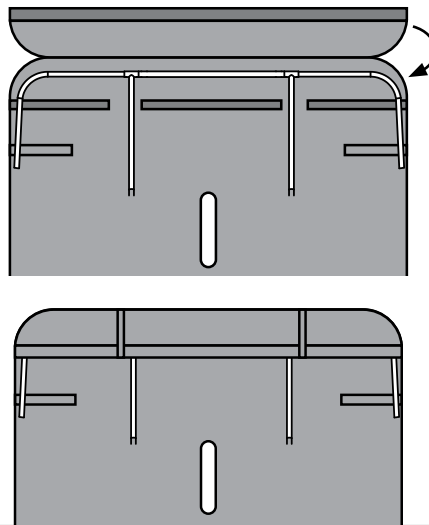
**U**

Wrap the six final straps around the bimini frame and tower to tighten up the fabric and provide side support. The center straps wrap around the front tube on the tower.

Centre straps

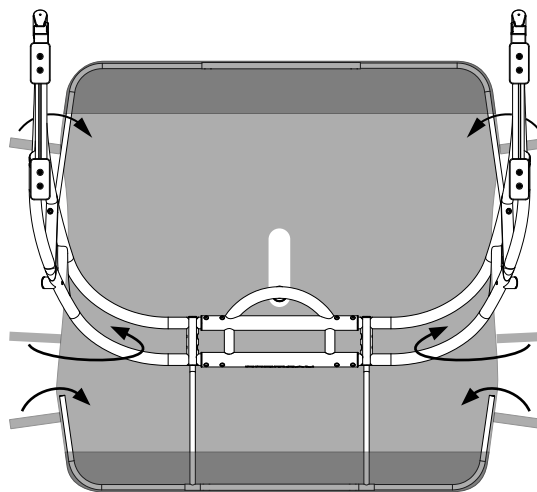

Bottom View

V

Stretch the padeye straps down and clip the hooks onto the padeyes. Tighten the straps until they hold the stern tubes in place securely.

Congratulations, you are done!
Now get out on the water!

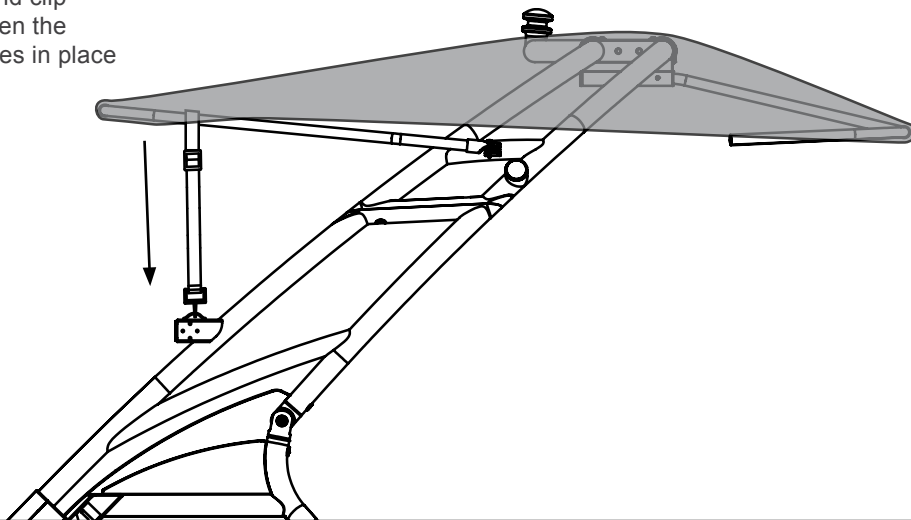

A**Folding & Stowing the CamRT Soft Top Bimini**

Undo all the six velcro straps and the bow tube pocket.

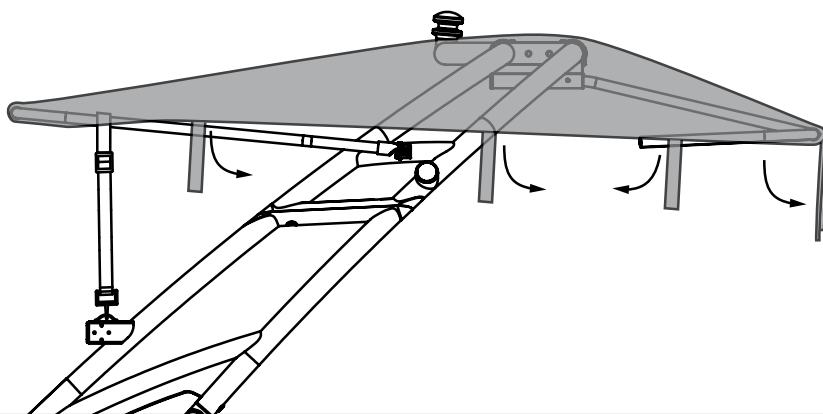
**B****Folding & Stowing the CamRT Soft Top Bimini**

1. Toss the canvas back to the stern over top of the tower (A). Pull the bow end of the canvas through the stern bimini frame (B).
2. Tightly wrap the canvas around the stern tube in a clockwise direction (viewed from the starboard side).
3. Wrap the bow pocket (A) around the canvas to enclose it.

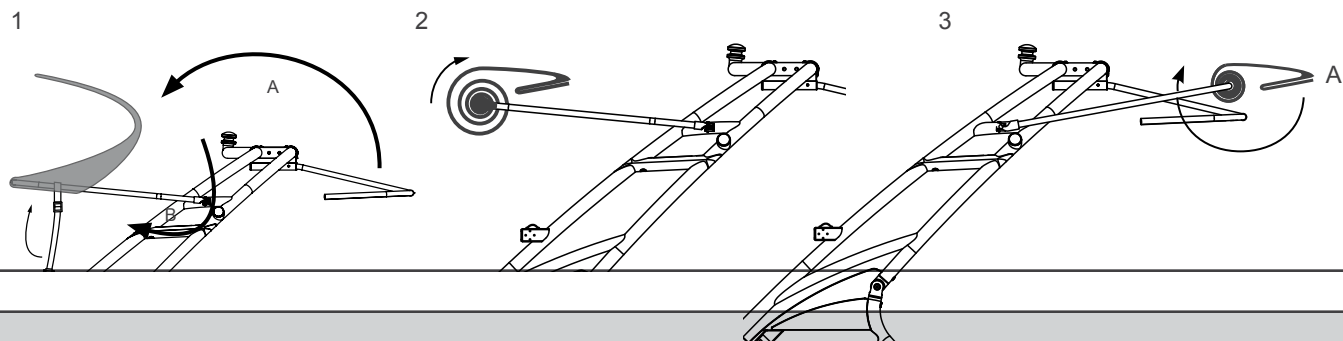
**C****Folding & Stowing the CamRT Soft Top Bimini**

1. Unfold the two velcro straps (B) on the outside of the fabric.
2. Wrap the two velcro straps around the two frames and fabric.

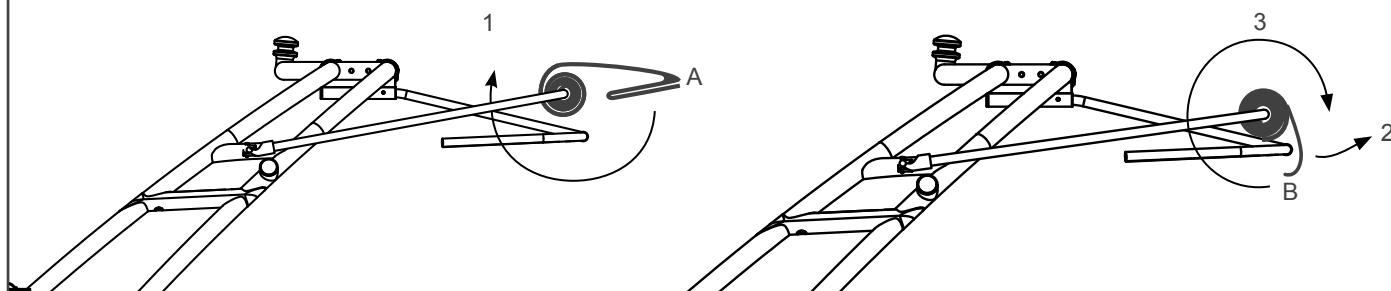

Trailer the CamRT Soft Top Bimini

****Never transport your boat with the CamRT Bimini fabric deployed****

When transporting your boat on land you must always fold the CamRT Bimini into the stowed position shown here.

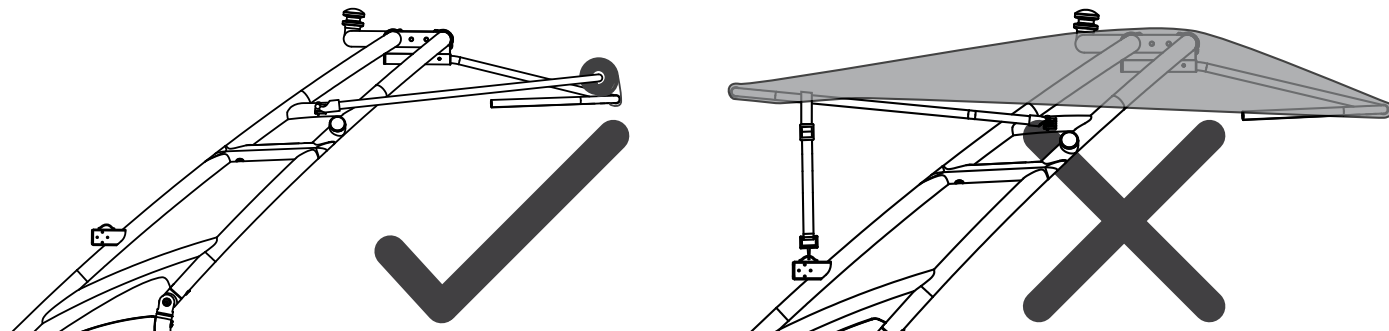

Folding your Tower with CamRT Bimini

****Never transport your boat with the CamRT Bimini fabric deployed****

Never fold your tower down with the Bimini fabric deployed.

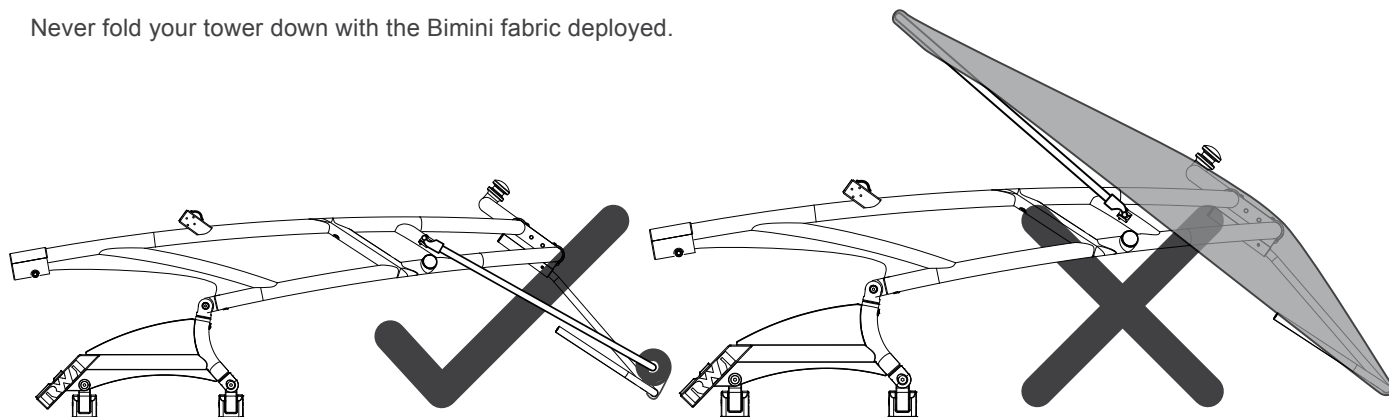

General usage notes and precautions

- Never travel at speeds in excess of 30mph / 48kph (i.e. towing the boat on a trailer) with the Bimini in it's deployed state. ONLY travel with the bimini in it's folded state secured to the tower.
- Be aware of the tow rope at all times. Ensure that it is not attached to anything on the tower other than the tow head, and that the rope is clear of any cleats or objects on the boat before pulling the rider up and out of the water. Only use your Bimini with tow rope length which do not touch the Bimini frame.
- Never hang from the bimini frame. Do not climb or sit on the bimini.
- Do not use the bimini as entry/exit handles to get in and out of the boat – it are not designed for this purpose.
- NEVER USE CLEANERS ON YOUR TOWER OR ACCESSORIES!
The CamRT Bimini has been coated with a protective layer using a process called anodization. A mild soap and water combination may be used to remove traveling grime or water spots. Clean with each use. Use only a soft cloth and never use any chemical cleaners. Treat as you would your vehicle.