

*You will have two sets of clamp inserts and two set screws remaining after installation. Keep for future use or recycle.

Speaker Hardware

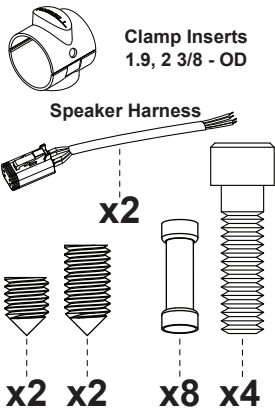

Tools Required

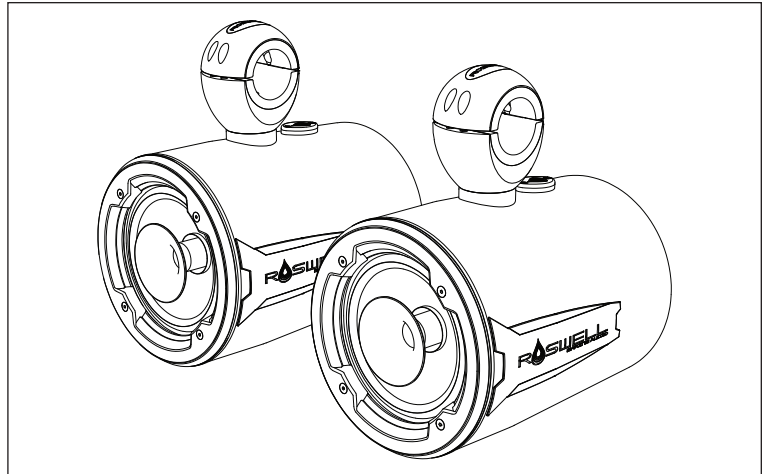
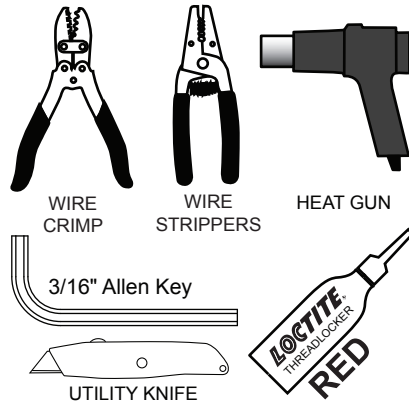

A

Remove the plug to access the wires. Carefully pull the wires out of the tower.

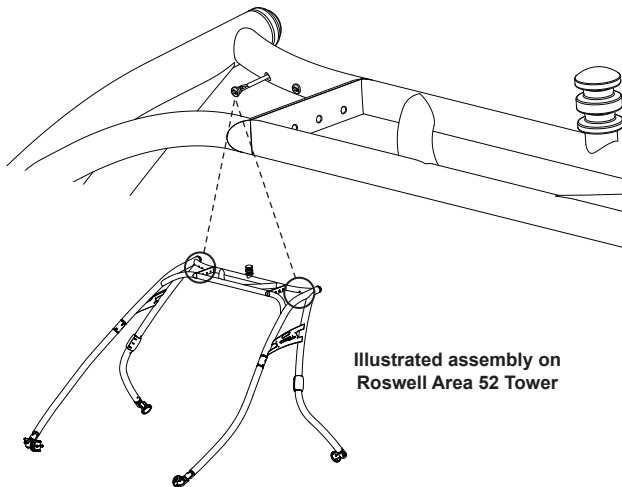

B

Carefully cut the first piece of shrink wrap with a utility knife to expose all 4 of the speaker wires and remove the plug. **Be very cautious not to cut through the wire's insulation.**

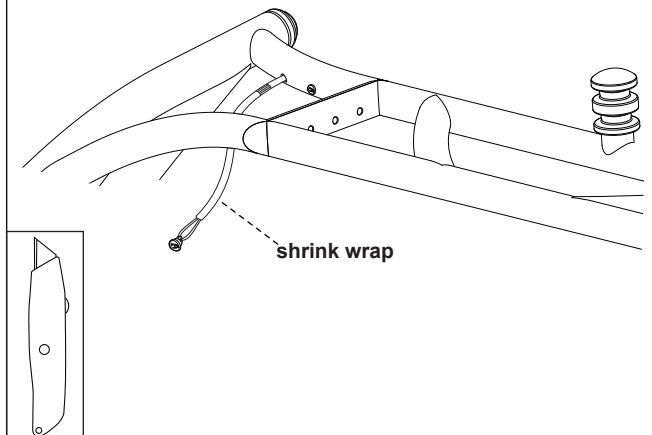

C

- 1) Use wire strippers to expose 1/4" of wire on all wires.
- 2) Slide matching wires (as illustrated) into opposing ends of the connectors and crimp.
- 3) Heat shrink the connectors.
- 4) Carefully push the wires back into the tubing.



x2

x8

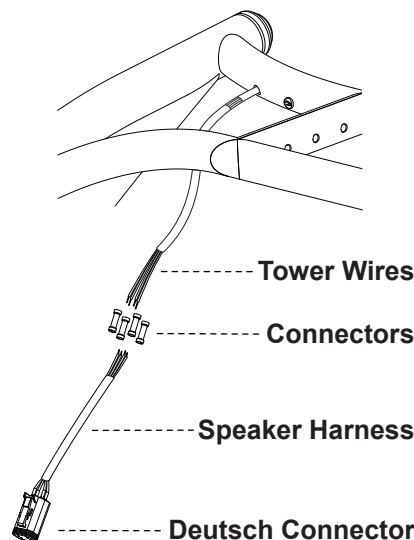
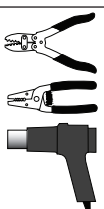

Tower Speaker Harness

Port	Crimp	
Red (spk +)		Red
Black (spk -)		Black
Yellow (led +)		Yellow
Blue (led -)		Blue
Starboard		
Red (spk +)		Red
Black (spk -)		Black
Yellow (led +)		Yellow
Blue (led -)		Blue



D

Apply red Loctite to 4 hex bolts prior to mounting speakers. Position the speaker clamp on the tower and close the clamp around the tubing, do this step one speaker at a time.

Secure the clamp around the tubing with 2 bolts containing Loctite. Insert the appropriate set screw and tighten the speaker at desired angle.

x2



x4



Note: to ensure tight fit use the correct plastic clamp inserts and set screws.

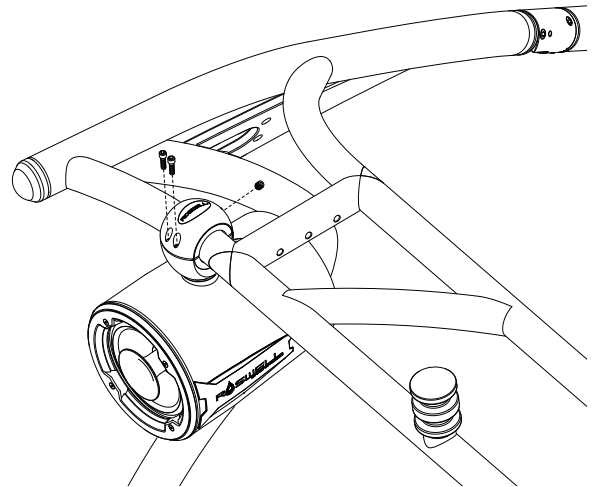
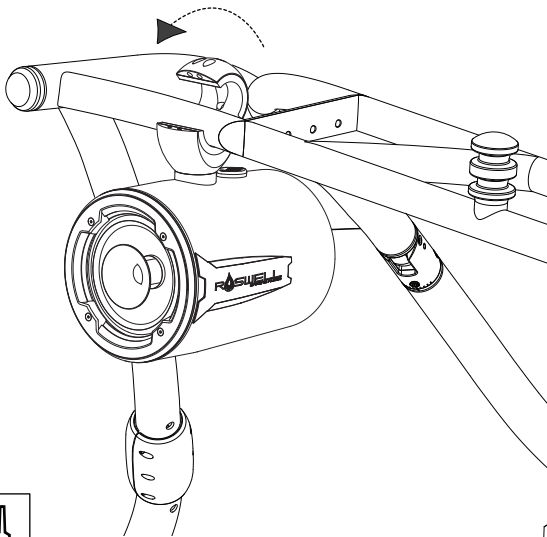
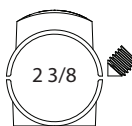

E

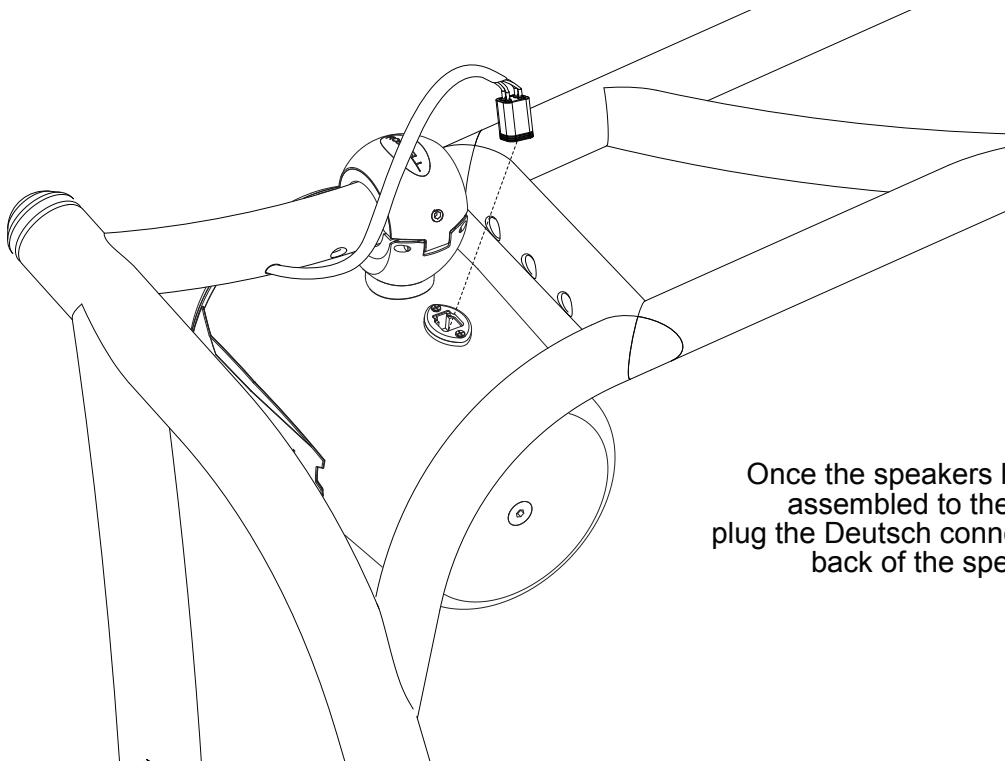

Once the speakers have been assembled to the tower, plug the Deutsch connector into the back of the speaker.